

# Expansion Joint Covers

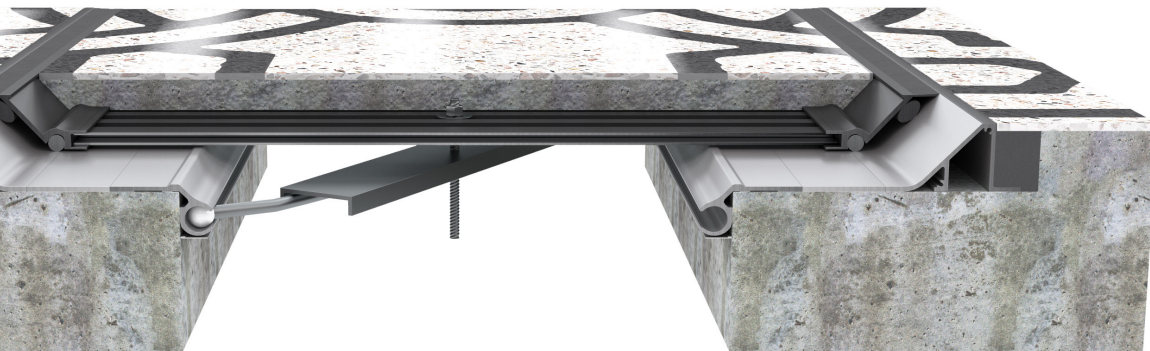

# Compare Floor Covers

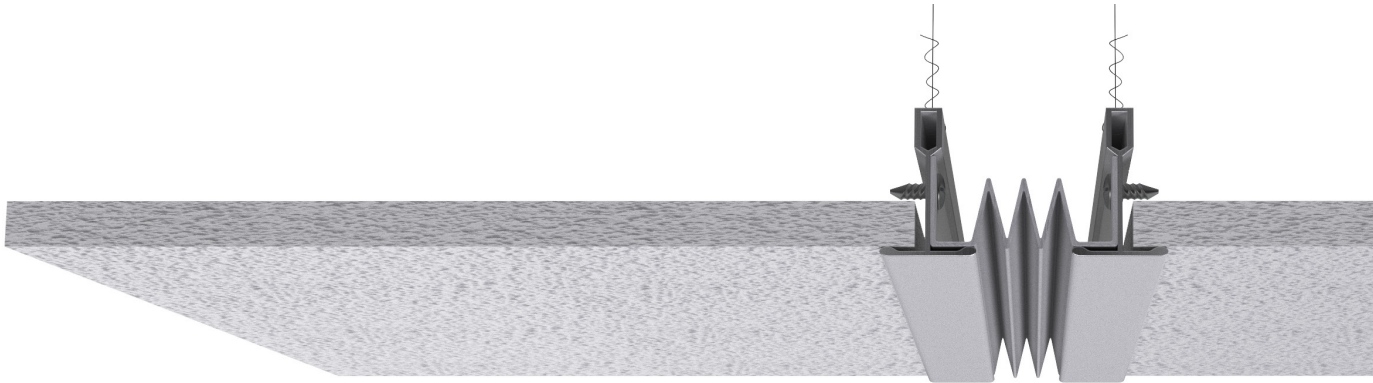

FLOOR COVERS

Cover Family	Flush Thinline	Flush Twinline	Restofit™
Cover Material	Gasket	Dual Gasket	Metal
Joint Size	1" - 2"	2" - 4"	1" - 4"
Total Movement (% of joint width)	50%	100%	100%
Models	4	4	4
Blockout Required	Model Specific	Yes	No
Installation	Flush and Surface	Flush	Surface
Hygienic	●	●	
Tamper Resistant			
Low Maintenance			
Loading	Standard	Standard/Heavy	Standard/Heavy
Fire Barriers	Monoflex®	Monoflex®	Monoflex®
Interior/Exterior Application	Interior	Interior	Interior/Exterior
Cost Index	\$	\$\$\$	\$\$
Corresponding Wall Covers	Flush Thinline	Flush Twinline	Any Interior Wall Cover

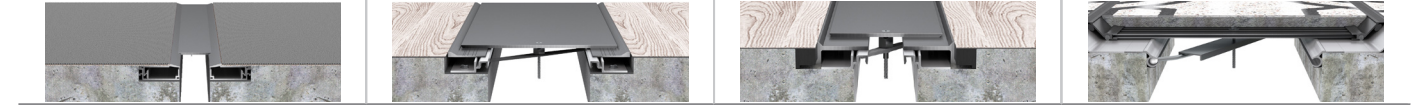

FLOOR COVERS

Allway™ Metal	Flush Seismic	Seismic Allway™ Metal	Seismic Pan
Metal	Gasket, Metal or Infill	Metal or Infill	Infill
1" - 4"	5" - 16"	4" and up	2" and up
100-200%	100%	100-200%	100-200%
8	2	4	1
Model Specific	Yes	Model Specific	Yes
Flush and Surface	Flush	Flush and Surface	Flush
	●		
●			
●			
Standard/Heavy	Standard	Standard/Heavy	Standard/Heavy
Monoflex®	FB-17	Contact Factory	FB-97
Interior/Exterior	Interior	Interior/Exterior	Interior/Exterior
\$ - \$\$\$	\$\$\$	\$\$ - \$\$\$	\$\$\$ - \$\$\$\$
Allway™ Metal	Flush Seismic	Seismic Allway™ Metal	Any / Flush Twinline recommended

# Compare Interior Wall & Ceiling Covers

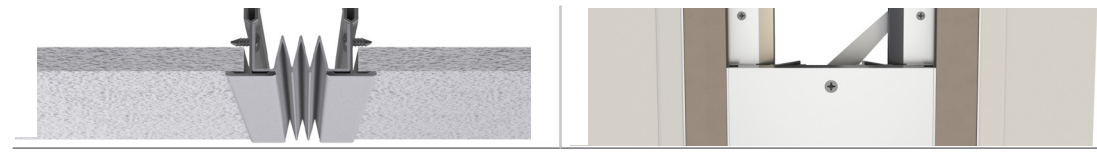

**INTERIOR WALL & CEILING COVERS**

Cover Family	Flush Thinline	Flush Twinline
Cover Material	Gasket	Dual Gasket
Joint Size	1" - 10"	2" and up
Total Movement (% of joint width)	50-200%	100-200%
Wall Models	3	3
Ceiling Models	3	1
Minimum Exposed Surface	•	•
Hygienic	•	•
Tamper Resistant		
Low Maintenance		
Surrounding Finishes	Drywall, Ceramic Tile	Drywall, Ceramic Tile
Fire Barriers	Monoflex®	Monoflex®/FB-97
Cost Index (\$ - \$\$\$\$)	\$	\$\$ - \$\$\$\$
Corresponding Floor Covers	Flush Thinline	Flush Twinline



**INTERIOR WALL & CEILING COVERS**

Allway™ Metal	Seismic Allway™ Metal	Seismic Corridor Cover
Metal	Metal	
1" - 4"	4" - 16"	Contact Factory
100-200%	100%	100-200%
2	1	1
	1	
•	•	
•	•	
All Finishes	All Finishes	All Finishes
Monoflex®	FB-17/FB-97	Contact Factory
\$\$ - \$\$\$	\$\$	\$\$\$\$\$
Allway™ Metal	Seismic Allway™ Metal	

# Compare Exterior Covers



EXTERIOR COVERS

Cover Type	WALL			
Cover Family	Flexible Seal	Foam Seal	Allway™ Metal	Seismic Pan
Cover Material	Gasket	Foam	Metal	Metal or Infill
Joint Size	2" - 24"	1" - 8"	1" - 16"	8" - 34"
Total Movement (% of joint width)	100-200%	100%	100-200%	200%
Models	2	1	3	4
Surrounding Finishes	All Finishes	All Finishes	All Finishes	All Finishes
Fire Barriers	Monoflex®, FB-17, FB-97	VFR	Monoflex®, FB-17	FB-17, FB-97
Cost Index (\$ - \$\$\$\$)	\$ - \$\$	\$\$\$	\$\$ - \$\$\$	\$\$\$\$
Corresponding Covers	Flexible Seal Roof	Flexible Seal Roof	Allway™ Metal Roof	Seismic Roof

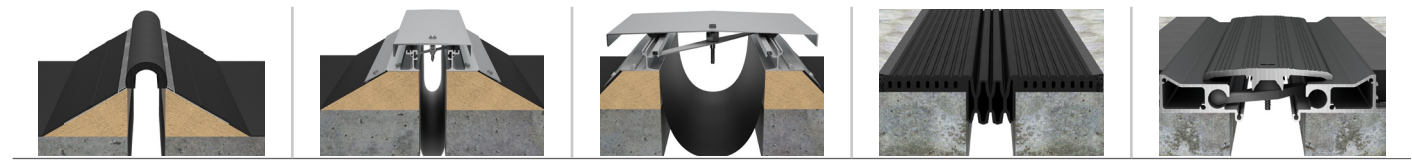

EXTERIOR COVERS

ROOF			PARKING + STADIUM	
Flexible Seal	Allway™ Metal	Seismic	Flexible Seal	Seismic Allway™ Metal
EPDM	Metal	Metal	EPDM	Metal
1" - 16"	1" - 2"	3" - 36"	1" - 16"	4" - 24"
100%	100%	100-200%	50-200%	100-200%
1	1	3	5	6
All Roof Finishes	All Roof Finishes	All Roof Finishes	Concrete, Paver	Concrete, Paver
Monoflex®, FB-17, FB-97	Monoflex®	Monoflex®, FB-17		FB-17, FB-97
\$\$	\$\$	\$\$ - \$\$\$\$	\$\$ - \$\$\$	\$\$\$ - \$\$\$\$
Flexible Seal Wall	Allway™ Metal Wall	Seismic Wall	Flexible Seal Wall / Roof	Seismic Allway™ Metal Wall / Roof



[c-sgroup.com](http://c-sgroup.com) | 800.233.8493