

# SJPFM

**TECHNICAL DATA:**

**Aluminum**

- Extrusion – CS uses multiple alloys & tempers which are established to be the most appropriate for the given use of individual parts. Will be one of the following: (6063-T5, T6, T52) (6061-T5, T6, T51) (6105-T5, T6) (6005-T5) (6005A-T5, T61), ASTM B221
- Sheet – 6061-T6, 3003-H14, 5005-H34, ASTM B209

**Standard Loading**

- 500 lbs.



Capable of Lateral Movement

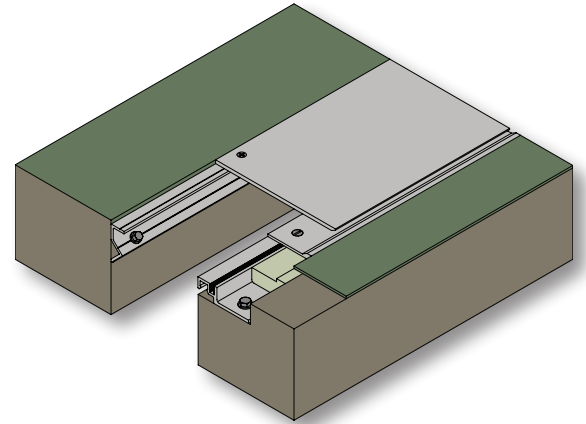

MODEL	JOINT WIDTH	MINIMUM OPENING	MAXIMUM OPENING	EXPOSED SURFACE	BLOCKOUT WIDTH	BLOCKOUT HEIGHT
SJPFM-100	1.00" (25mm)	0.75" (19mm)	2.00" (51mm)	3.25" (83mm)	3.50" (89mm)	1.13" (29mm)
SJPFM-200	2.00" (51mm)	0.75" (19mm)	3.00" (76mm)	3.75" (95mm)	3.00" (76mm)	1.13" (29mm)
SJPFM-300	3.00" (76mm)	0.75" (19mm)	4.00" (102mm)	4.75" (121mm)	3.00" (76mm)	1.13" (29mm)
SJPFM-400	4.00" (102mm)	0.75" (19mm)	5.25" (133mm)	6.00" (152mm)	3.00" (76mm)	1.13" (29mm)
SJPFM-500	5.00" (127mm)	0.75" (19mm)	6.50" (165mm)	7.50" (191mm)	3.00" (76mm)	1.13" (29mm)
SJPFM-600	6.00" (152mm)	0.75" (19mm)	8.00" (203mm)	8.75" (222mm)	3.00" (76mm)	1.13" (29mm)
SJPFM-700	7.00" (178mm)	1.88" (48mm)	9.00" (229mm)	9.75" (248mm)	3.00" (76mm)	1.13" (29mm)
SJPFM-800	8.00" (203mm)	1.88" (48mm)	10.00" (254mm)	11.25" (286mm)	3.38" (86mm)	1.25" (32mm)
SJPFM-900	9.00" (229mm)	2.56" (65mm)	12.50" (318mm)	12.75" (324mm)	4.63" (118mm)	1.25" (32mm)
SJPFM-1000	10.00" (254mm)	2.56" (65mm)	13.50" (343mm)	13.75" (349mm)	4.63" (118mm)	1.25" (32mm)
SJPFM-1100	11.00" (279mm)	2.56" (65mm)	14.50" (368mm)	14.75" (375mm)	4.63" (118mm)	1.25" (32mm)
SJPFM-1200	12.00" (305mm)	2.56" (65mm)	15.75" (400mm)	16.00" (406mm)	4.88" (124mm)	1.25" (32mm)
SJPFM-1300	13.00" (330mm)	2.56" (65mm)	17.00" (432mm)	17.25" (438mm)	5.13" (130mm)	1.25" (32mm)
SJPFM-1400	14.00" (356mm)	2.56" (65mm)	17.75" (451mm)	18.50" (470mm)	5.38" (137mm)	1.25" (32mm)
SJPFM-1500	15.00" (381mm)	2.56" (65mm)	19.50" (495mm)	19.75" (502mm)	5.63" (143mm)	1.25" (32mm)
SJPFM-1600	16.00" (406mm)	2.56" (65mm)	20.50" (521mm)	21.00" (533mm)	5.88" (149mm)	1.25" (32mm)

Contact factory for larger sizes.

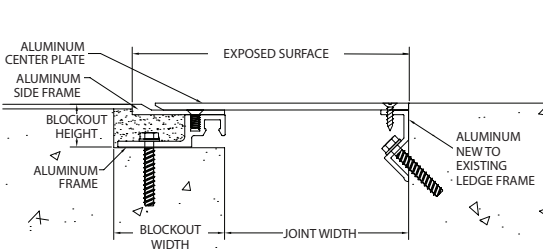

SJPFM 100-600

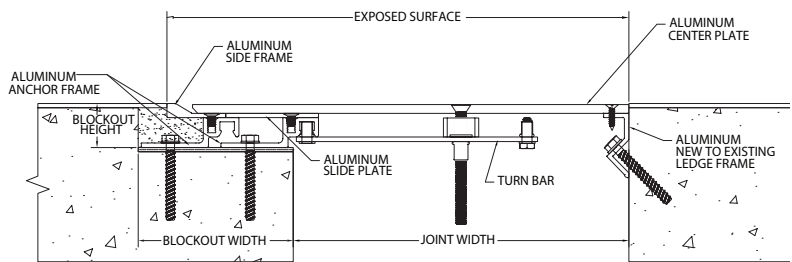

SJPFM 700-1600