

# DOOR KNOB AND LEVER HANDLE PROTECTORS

DNP-01 THRU DNP-10

PLEASE READ

PLEASE READ THESE INSTRUCTIONS THOROUGHLY PRIOR TO BEGINNING THE DOOR KNOB PROTECTOR INSTALLATION!

THIS INSTRUCTION SHEET IS INTENDED TO PROVIDE A SPECIFIC GUIDE TO FOLLOW FOR THE INSTALLATION OF THIS DOOR KNOB PROTECTOR. CONTAINED WITHIN IS THE TECHNICAL INFORMATION AND INSTALLATION TECHNIQUES REQUIRED TO COMPLETE AN EFFICIENT, NEAT AND LONG-LASTING INSTALLATION.

INSPECT ALL MATERIALS FOR DAMAGE OR MISSING PARTS. IF YOU DISCOVER DAMAGED OR MISSING MATERIALS, IN THE USA PLEASE NOTIFY THE FACTORY AT (800) 233-8493, AND IN CANADA (888) 895-8955 FOR CUSTOMER SERVICE.

DOOR KNOB PROTECTORS MUST BE INSTALLED IN ACCORDANCE WITH THESE INSTRUCTIONS! FAILURE TO FOLLOW THESE INSTRUCTIONS MAY VOID ANY PRODUCT WARRANTIES AND RESULT IN AN UNSUCCESSFUL INSTALLATION. FOR SPECIFIC QUESTIONS REGARDING THE INSTALLATION OF THIS DOOR KNOB PROTECTOR PLEASE CALL THE FACTORY IN THE USA AT (800) 233-8493 OR EMAIL IWPTECHSUPPORT@C-SGROUP.COM. IN CANADA CALL (888) 895-8955.

## IMPORTANT NOTES

1. MATERIAL MUST REACH 65°F MIN. TO 75°F MAX. 24 HOURS PRIOR TO INSTALLATION. THIS IS ESSENTIAL TO MINIMIZE EXPANSION AND CONTRACTION OF MATERIAL.
2. THE CONSTRUCTION SPECIALTIES DOOR KNOB PROTECTOR WITH PREFORMED COUNTERSINK HOLES, IS EASILY INSTALLED IN LESS THAN 10 MINUTES. INSTALLATION CAN BE COMPLETED WITH ONLY THE FOLLOWING TOOLS: PORTABLE DRILL AND 7/32" DRILL BIT, LEVEL/SQUARE, SCREWDRIVER, MARKER/PENCIL, A MALLET, A CLAMP, AND WOOD BLOCK.
3. FOR MORE INFORMATION ON DOOR KNOB PROTECTORS SEE OUR WEBSITE AT [www.c-sgroup.com](http://www.c-sgroup.com).

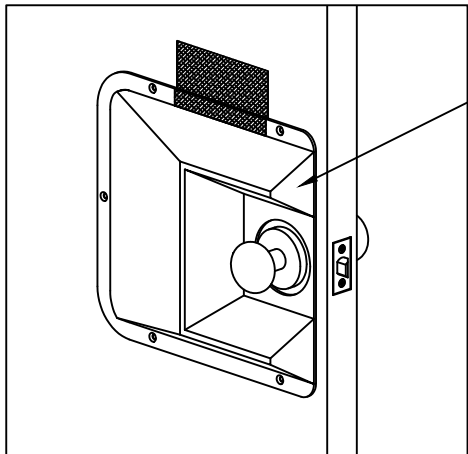

MODEL DNP-01  
(25M001xxx)

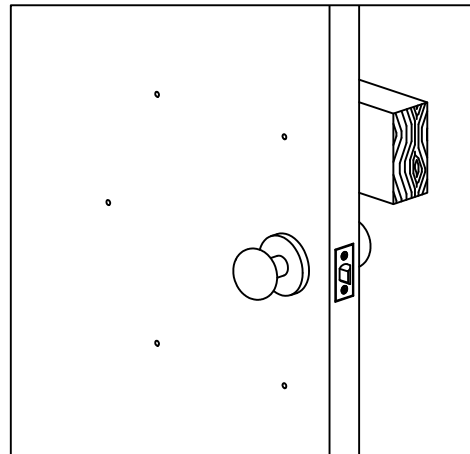

**STEP 1:** LOCATE DOOR KNOB PROTECTOR BY CENTERING HOLD AROUND DOORKNOB. LEVEL PROTECTOR WITH DOOR AND MARK LOCATION OF HOLES. MASKING TAPE MAY BE USED TO HOLD PROTECTOR IN POSITION DURING MARKING OF HOLE LOCATIONS.

**STEP 2:** REMOVE PROTECTOR AND CAREFULLY DRILL THE 7/32" DIAMETER HOLES, AS LOCATED, THROUGH THE DOOR. CLAMP A WOOD BLOCK AT THE REAR SIDE OF THE DOOR TO PREVENT CHIPPING OR BULGING DEPENDING ON DOOR MATERIAL.

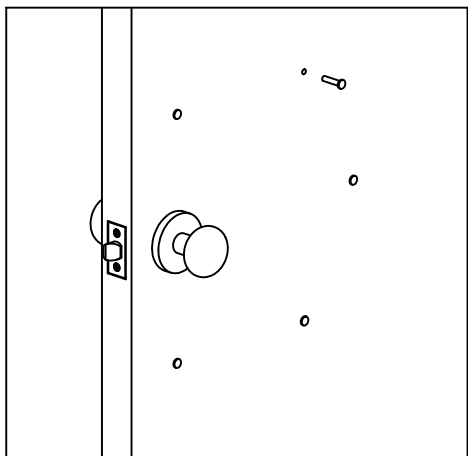

**STEP 3:** INSERT THE POST FASTENERS FROM THE REAR SIDE OF THE DOOR. FIT SHOULD BE SNUG. USING A MALLET, GENTLY TAP THE POST FASTENERS INTO THE HOLES AS FAR AS POSSIBLE.

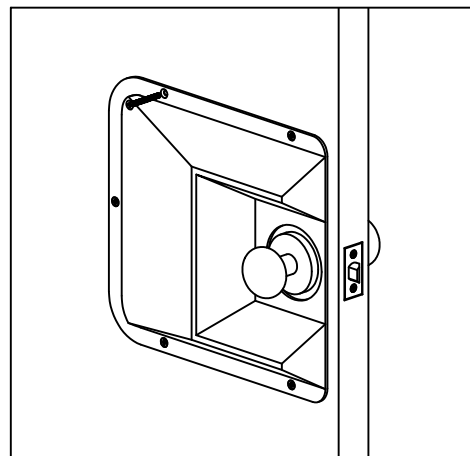

**STEP 4:** HOLD THE DOORKNOB PROTECTOR IN POSITION AND INSERT THE SCREWS. TIGHTEN THE SCREWS UNTIL THE PROTECTOR IS SECURE AND THE POST FASTENERS ARE SNUG ON THE BACK SIDE OF THE DOOR.

CONDITION	SPECIFIED FASTENER	DRILL DIAMETERS	CS PART NUMBER
		DOOR	
HOLLOW METAL WOOD	1-3/4" LONG ALUMINUM SCREW POST 1/2" LONG FLAT HEAD MACHINE SCREW (SLOTTED)	7/32"	90H016010

**DOOR KNOB AND LEVER HANDLE PROTECTORS**

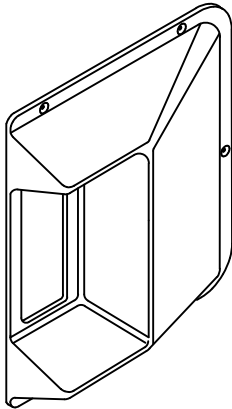

MODEL DNP-02 (25M002xxx)  
(LEFT OR RIGHT HAND)

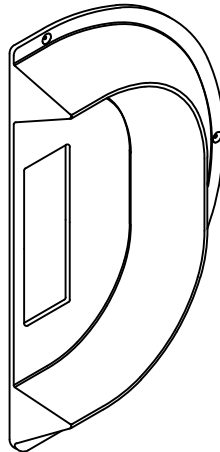

MODEL DNP-03 (25M003xxx)  
(LEFT OR RIGHT HAND)

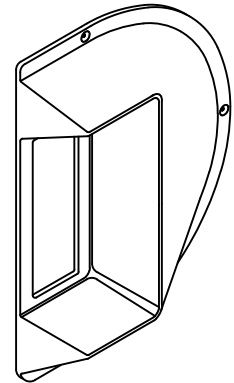

MODEL DNP-04 (25M004xxx)  
(LEFT OR RIGHT HAND)

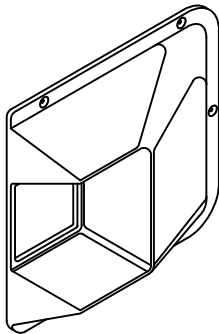

MODEL DNP-05 (25M005xxx)  
(LEFT OR RIGHT HAND)

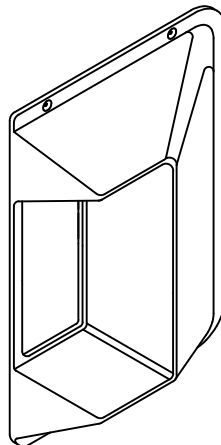

MODEL DNP-06 (25M006xxx)  
(LEFT OR RIGHT HAND)

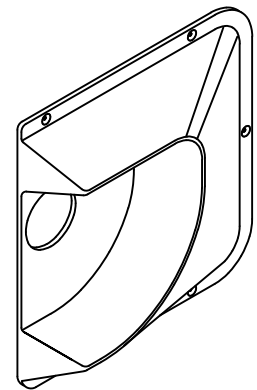

MODEL DNP-07L (25M010xxx) (SHOWN)  
MODEL DNP-07R (25M011xxx)

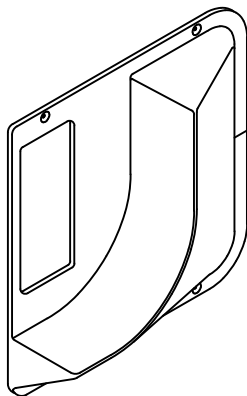

MODEL DNP-08L (25M012xxx) (SHOWN)  
MODEL DNP-08R (25M013xxx)

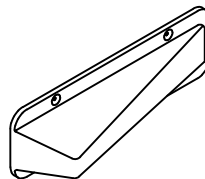

MODEL DNP-09 (25M014xxx)  
(LEFT OR RIGHT HAND)

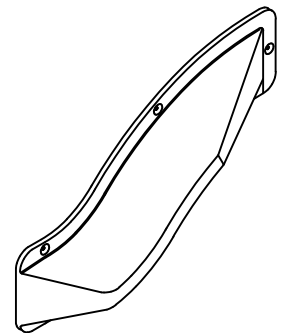

MODEL DNP-10L (25M015xxx) (SHOWN)  
MODEL DNP-10R (25M016xxx)

7/21/2016