

## Acrovyn® Wall Panels



Acrovyn® Wall Panels are the answer to the industry's need for a protective and designer-focused wall panel system allowing interior environments to have true design freedom. A reimagined offering of functional and aesthetic improvements allows for use of Acrovyn Wall Panels in a variety of spaces with different installation options.

### Advantages

- Available in a wide variety of Acrovyn and Acrovyn by Design (AbD) finishes to coordinate with any interior design scheme
- Edge details include wrapped square or beveled edge or unfinished square edge with trim
- Multiple installation options from easy-to-demount systems to permanent installations
- Durable Acrovyn enhances interiors while keeping them protected
- Acrovyn is easy to clean and resists bacterial growth
- Works with all other Acrovyn products for a complete system and coordinated look

### Applications

- Accent & feature walls
- Corridors
- Lobbies
- Public spaces

### Building Segments

- Education
- Civic & Culture
- Corporate & Commercial
- Healthcare
- Hospitality
- Mixed Use
- Retail
- Sports & Convention Centers
- Senior Living
- Transportation



Learn More



# Acrovyn® Wall Panels

## Product Details

- PVC-Free Acrovyn
- 3/8" (9.5mm) thick particleboard core with .040" (1.02mm) surface finish
- Moisture-resistant barrier laminated to backside and return edges of panel
- Demountable panels: 3/4" (standard), 1" or 2" deep; permanent adhesive panels: 3/8" deep only
- Minimum Panel Size: 3"x4" (76.2mm x 101.6mm)

RELIEF DEPTH	MAX WIDTH	MAX HEIGHT
3/8" (9.53mm)	47" (1.19m)	119" (3.02m)
3/4" (19.1mm)	46" (1.17m)	118" (2.99m)
1" (25.4mm)	45.5" (1.16m)	117.5" (2.98m)
2" (50.8mm)	43.5" (1.10m)	115.5" (2.93m)

## Installation Options

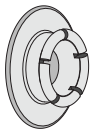

### Sure Snap®

- Designed for panels needing occasional removal while having strong pullout load
- Minimal clearance needed due to straight-in & straight-out interlocking mechanism

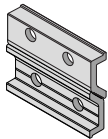

### French Cleat

- Designed for panels with limited clearance & for quick removal
- Grooved rail increases connection strength to reduce pull-off risk

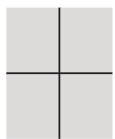

### Direct Apply

- Designed for permanent placement & where minimal clearance is needed
- Fast & simple installation with common industry methodology

## Certifications

- Resistant to certain bacterial & fungal growth (per ASTM G 22 and G 21)
- California 01350 Testing (VOC Emissions)
- Acrovyn® solid colors and woodgrains are UL Class B/2
- Tested in accordance with ASTM E-84 - AbD digital print and Metallics meet class B requirements



## Finish Options



See all finish options online at [c-sgroup.com](http://c-sgroup.com).

## Edge Options

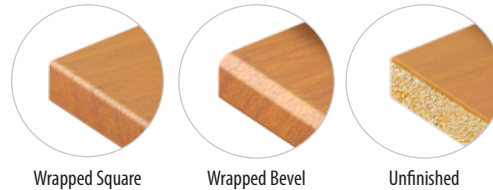

Acrovyn by Design finishes are not available in wrapped panels.

## Trim Options

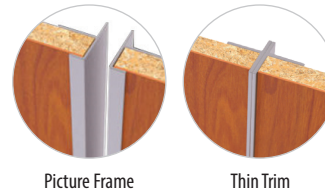

## Reveal Options

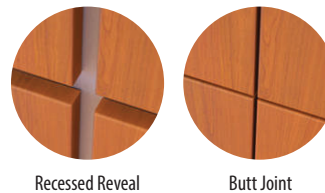

- Painted wall reveals
- Acrovyn reveal: 1-1/2" (38.1mm) wide strips of .040" (1.02mm) thick sheet
- Aluminum reveal: 1-1/2" (38.1mm) wide of .061" (1.55mm) thick strips

## Warranty

- Acrovyn Limited Lifetime Warranty