

HF

TECHNICAL DATA:

UV Resistance

- ASTM G155-00A, no changes - 2000 hours

Temperature Service Range

- ASTM C711, -40°F to 185°F

Tensile Strength

- ASTM D3574 E, 157%min

Ultimate Elongation

- ASTM D3574 E

Accelerated Weatherometer

- ASTM G155-00A, No changes - 2000 hours

Base Material

- Cellular, high density, polyurethane foam

Impregnation

- Proprietary, modified, water based, acrylic 22.3 PSI min (153kPa) 2.3 PSI MIN (153kPa)

Bleeding

- -40°F to 180°F, No bleeding when compressed to minimum of claimed movement i.e. -50% of nominal size and when simultaneously heated to 180°F for 3 hours.

Compression set

- Material recovers to +50% of nominal size within 24 hours of compression to -50% and simultaneous heating to 180°F for 3 hours.

Silicone Coating

- Shore A 25
- 96% solids
- 1.26 - 1.34 Specific Gravity

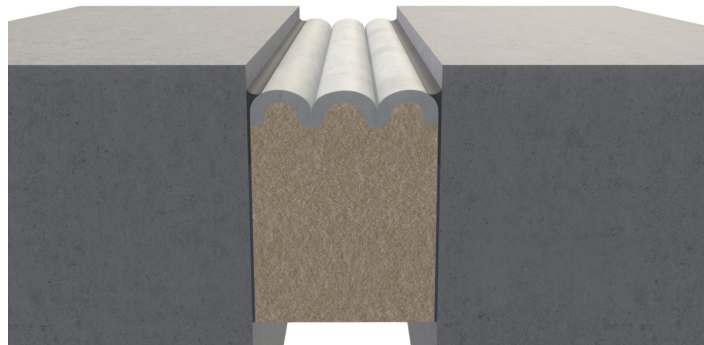

21 Day Cure on Sealant at 77°F and 50% RH:

- Elongation percent minimum 1400
- Joint Modulus at 50% elongation, psi (kPa) maximum 7(48)
- Joint modulus at 100% elongation, psi (kPa) maximum 8(55)
- Joint modulus at 150% elongation, psi (kPa) maximum 9(62)
- Adhesion to concrete, minimum percent elongation +600
- Adhesion to asphalt, minimum percent elongation +600
- Joint movement capability, +100/-50 percent, 10 cycles - no failure
- Weatherability, unaffected by climatic extremes
- Flexibility, cured sealant stays rubbery from -50 to 300°F

Change of Silicone Coating after

Exposure to Fluids (approx. Volume):

Percent Volume swell - visual

- Fluid - silicone joint sealant
- JP-4 - 5-20 percent
- Skydrol B - None
- 50/50 Glycol/H2O
- Hydraulic Fluid - None

After drying, all samples passed +100/-50% movement testing.

HF

MODEL	JOINT WIDTH	MINIMUM OPENING	MAXIMUM OPENING	EXPOSED SURFACE	BLOCKOUT WIDTH	BLOCKOUT HEIGHT	SEAL DEPTH
HF-100	1.00" (25mm)	0.50" (13mm)	1.50" (38mm)	1.00" (25mm)	N/A	N/A	2.00" (51mm)
HF-150	1.50" (38mm)	0.75" (19mm)	2.25" (57mm)	1.50" (38mm)	N/A	N/A	2.50" (64mm)
HF-200	2.00" (51mm)	1.00" (25mm)	3.00" (76mm)	2.00" (51mm)	N/A	N/A	2.50" (64mm)
HF-250	2.50" (64mm)	1.25" (32mm)	3.75" (95mm)	2.50" (64mm)	N/A	N/A	2.75" (70mm)
HF-300	3.00" (76mm)	1.50" (38mm)	4.50" (114mm)	3.00" (76mm)	N/A	N/A	3.25" (83mm)
HF-350	3.50" (89mm)	1.75" (44mm)	5.25" (133mm)	3.50" (89mm)	N/A	N/A	3.50" (89mm)
HF-400	4.00" (102mm)	2.00" (51mm)	6.00" (152mm)	4.00" (102mm)	N/A	N/A	4.00" (102mm)

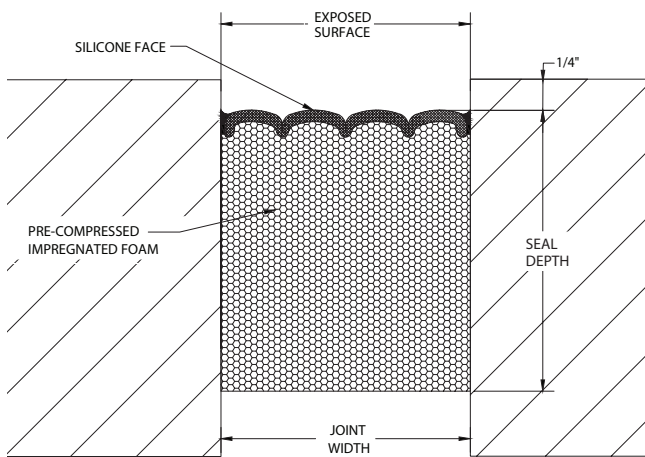

HF

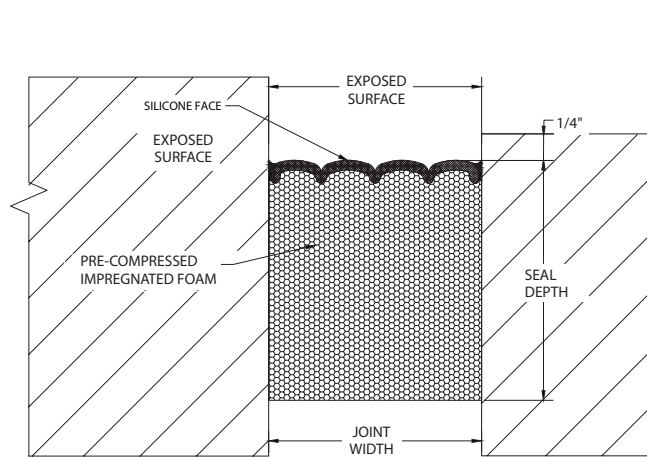

HF (Corner)