

Moat Cover Series

TECHNICAL DATA:

Steel

- Pan & Hinge Components - CS uses A36 or equivalent for steel shapes and A653 Galvanized Deck.

Aluminum

- Frame Extrusion – CS uses multiple alloys & tempers which are established to be the most appropriate for the given use of individual parts. Will be one of the following: (6063-T5, T6, T52) (6061-T5, T6, T51) (6105-T5, T6) (6005-T5) (6005A-T5, T61), ASTM B221

Standard Loading

- Min 1,000 pounds or as required by the project.
- Custom based on Project Requirements

Vapor Barrier is optional.



Capable of Lateral Movement

MODEL	JOINT WIDTH	MINIMUM OPENING	MAXIMUM OPENING	EXPOSED SURFACE	BLOCKOUT WIDTH	BLOCKOUT HEIGHT
SSRW-4383 XHD	43.00" (1,092mm)	2.49" (63mm)	83.00" (2,108mm)	97.81" (2,484mm)	51.69" (1,313mm)	5.63" (143mm)
SSRW-5097 XHD	50.00" (1,270mm)	2.49" (63mm)	97.00" (2,464mm)	111.81" (2,840mm)	58.69" (1,491mm)	5.63" (143mm)
SSRW-60117 XHD	60.00" (1,524mm)	2.49" (63mm)	117.00" (2,972mm)	131.81" (3,348mm)	68.69" (1,745mm)	5.63" (143mm)
SSRW-68133 XHD	68.00" (1,727mm)	2.49" (63mm)	133.00" (3,378mm)	147.81" (3,754mm)	76.69" (1,948mm)	5.63" (143mm)
SSRW-71139 XHD	71.00" (1,803mm)	2.49" (63mm)	139.00" (3,531mm)	153.81" (3,907mm)	79.69" (2,024mm)	5.63" (143mm)
SSRW-85167 XHD	85.00" (2,159mm)	2.49" (63mm)	167.00" (4,242mm)	181.81" (4,618mm)	93.69" (2,380mm)	5.63" (143mm)

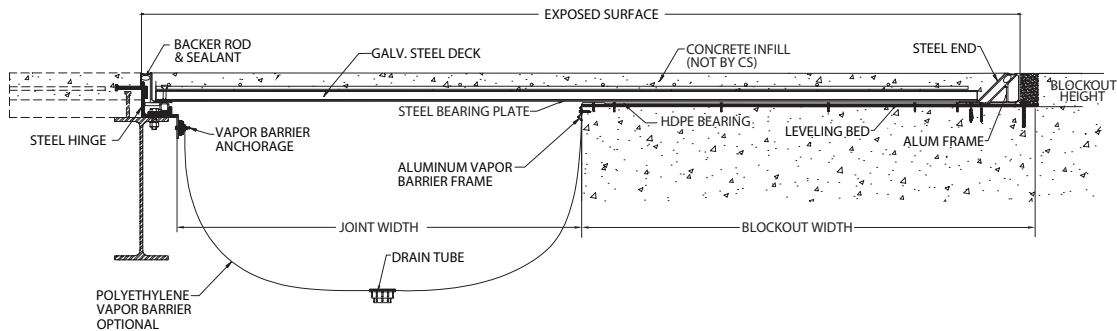

SSRW XHD