

ATTENTION

Please read these instructions thoroughly prior to beginning the **STAINLESS-STEEL WALL COVERING** installation.

This instruction sheet is intended to provide a specific guide to follow for the installation of the **STAINLESS-STEEL WALL COVERING**. Contained within is the technical information and installation techniques required to complete an efficient, neat, and long-lasting installation.

TOOLS AND EQUIPMENT

SUPPLIED BY CONTRACTOR

Chalk line 6' – 0" level (or larger)
Straight edge Drop cloth
Masking tape Tape Measure
1/4" drill bit 1/8" drill bit
Saw or grinder with acceptable blade for cutting
Stainless-steel sheet and trims

SUPPLIED BY CONSTRUCTION SPECIALTIES (CS)

Stainless-steel sheet
Stainless-steel trim (Optional)
#10 x 1-1/2" Stainless-steel Phillips flat head wood screw (90H009002)
AF-8 Plastic anchor (90H049004)
Clear caulk (Optional)

INSTALLATION INSTRUCTIONS

STEP 1: WALL PREPARATION

NOTE: Bottom of sheet should be installed no less than 1" (25.4mm) recommended above finish floor for field variation.

Full height installation – Establish a plumb line to be located at the edge of the first sheet. This will serve as a starting point for the wall covering to be installed on that wall and will ensure the following sheets to be installed plumb. Establish a plumb line at the beginning of each new installation of wall covering.

NOTE: When installing trim, refer to the trim offset measurements indicated on page 3 to ensure correct sheet placement.

Wainscot installation – Establish a level line at the specified height for the entire length of the run. Install the wall covering by aligning the top edge with this line. A level line should be established for each new installation. If using wainscot trims be sure to reference the trim offset measurements indicated on page 3.

STEP 2: SHEET HANDLING AND PREPARATION

Careless handling of the stainless-steel wall covering could result in damage and unrepairable "kink" marks. Damage is less likely to occur when using two people to move and position the sheets.

Prepare the first sheet by making any necessary cutouts or scribing the edge to fit the inside/outside corner, if applicable. Stainless-steel sheets can be installed with butted joints. When installing sheets at a butted joint, make sure the sheets are flush and do not overlap with one another.

NOTE: Allow a 1/16" gap around doors, windows, baseboards, and other obstructions.

NOTE: When cutting stainless-steel sheets, use a saw or grinder equipped with a blade suitable for stainless-steel to avoid damaging the sheet's finish at the cut location. Use a straight edge to ensure clean, precise cutouts. Be sure to properly deburr all cut edges to ensure a smooth, safe finish.

STEP 3: STARTING PROCEDURES

Starting in a corner of the room, place the sheet on the wall and mark the wall for the fastener locations. Pre-drill the wall for the specified wall fasteners. See the chart at the bottom of page 3. Once the fastener locations have been pre-drilled, place one of the AF-8 plastic anchors in each of the holes.

NOTE: At known stud locations, pre-drill the wall and stud with 1/8" drill bit and use only the S/S fastener to anchor the sheet to the wall.

STEP 4: SHEET INSTALLATION

Align the edge of the wall covering with the plumb or level line established in step 1.

Starting in a corner of the room, begin inserting specified fasteners using the pre-drilled holes into the AF-8 plastic anchors in the wall.

NOTE: Be careful not to over torque the screws in the plastic anchors.

STEP 5: TRIM APPLICATION (Optional)

If trims were not supplied, skip this step.

Be sure to reference the trim offset measurements indicated on page 3. After the central fasteners are secured, install the trim using the perimeter holes. This step requires fastening through the trim for proper attachment.

Wainscot Trim Installation: Wainscot trim is installed similarly to vertical trim. If it needs to be notched to accept vertical trim intersections, complete the notching before installing the wainscot trim. See notching trims information below for reference.

Installing Trim to Sheet Edges: Install the trim onto sheet edges. Place the sheet onto the wall as outlined in Step 4. After the central fasteners are secured, install the trim using the perimeter holes. Aligning the stainless-steel sheet carefully with the edge of the previously installed sheet. Ensure the trim overlaps both sheets.

Inside and Outside Corner Trim Installation: When using full-length corner trims with wainscot, notch the corners where they intersect with the wainscot, using the same technique as for notching the wainscot trim.

Notching Vertical Trims at Wainscot Intersections: All stainless-steel vertical trims, including inside and outside corners, must be notched at the back where they intersect with stainless-steel wainscot trim. Refer to the rabbet detail on page 3 for guidance.

To properly notch:

Identify where the vertical trim will intersect with the wainscot.

- Mark this location on the wainscot trim.
- Notch out the back leg of the wainscot trim accordingly.
- Refer to the Trim Notch Detail at the bottom of page 3 for visual guidance.

After cutting or notching stainless-steel trims, deburr all cut edges using a fine file to ensure a smooth, safe finish.

Installing Trim to Sheet Edges: Install the trim onto sheet edges. Place the sheet onto the wall as outlined in Step 4. After the central fasteners are secured, install the trim using the perimeter holes. Aligning the stainless-steel sheet carefully with the edge of the previously installed sheet. Ensure the trim overlaps both sheets.

⚠ IMPORTANT: Do not install trim tightly against the sheet edge. Allow a small tolerance to accommodate thermal expansion and contraction. Reference the trim offset measurements indicated on page 3.

Wainscot Trim Installation: Wainscot trim is installed similarly to vertical trim. If it needs to be notched to accept vertical trim intersections, complete the notching before installing the wainscot trim.

Inside and Outside Corner Trim: When using full-length corner trims with wainscot, notch the corners where they intersect with the wainscot, using the same technique as for notching the wainscot trim.

Note: Trims can be mitered at corners when picture framing or when vertical and horizontal trims intersect for a clean, finished appearance.

Butt joints – Stainless-steel sheet can be installed with butted joints. When installing sheets at a butted joint, make sure that the sheets are flush and do not overlap with one another.

STEP 6: CLEAR CAULK (Optional)

If caulk is not supplied, skip this step.

Hughesville, PA | 800.233.8493 | 570.546.5941
Mississauga, ON | 888.895.8955 | 905.274.3611

www.c-sgroup.com
IWPTechSupport@c-sgroup.com

Reference typical caulking instructions.

STEP 7: CLEAN UP

Upon completion of the installation, remove all protective materials (masking tape, protective film). Once the inspection and cleanup have been completed, the cover plates and other wall-mounted items can be installed.

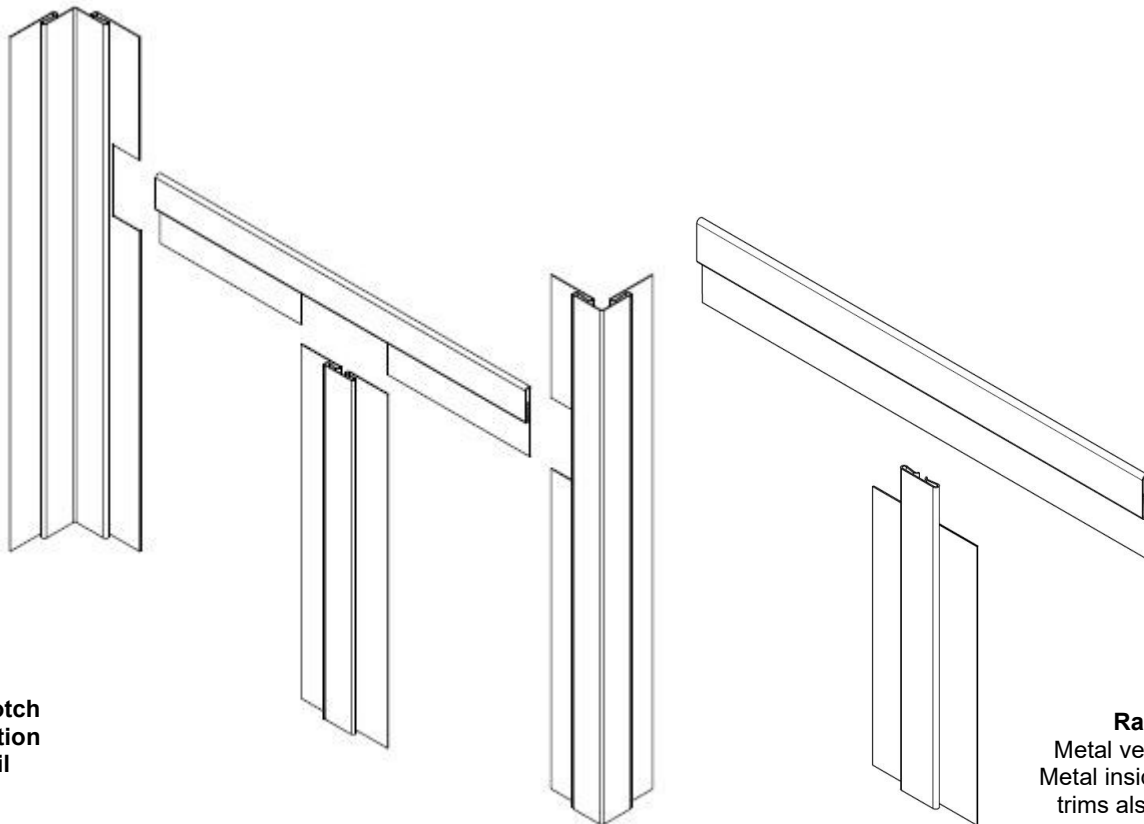
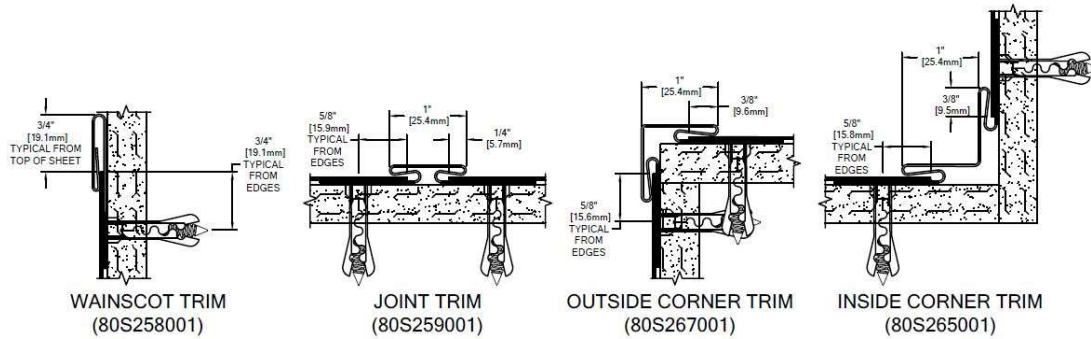

WALL CONDITION	SPECIFIED FASTENER	DRILL DIAMETER		CS PART NUMBER
		STUD	NO STUD	
FOR HARDWARE INSTALLATION				
Steel Stud / Gypsum Wall	#10 x 1-1/2" S/S Phillips Flat Head Wood Screw AF-8 Plastic Anchors	1/8"	1/4"	90H009002 90H049004
Concrete / Concrete Block	#10 x 1-1/2" S/S Phillips Flat Head Wood Screw AF-8 Plastic Anchors	N/A	1/4"	90H009002 90H049004
Wood Stud / Gypsum Wall	#10 x 1-1/2" S/S Phillips Flat Head Wood Screw AF-8 Plastic Anchors	1/8"	1/4"	90H009002 90H049004

Hughesville, PA | 800.233.8493 | 570.546.5941
Mississauga, ON | 888.895.8955 | 905.274.3611

www.c-sgroup.com
IWPTechSupport@c-sgroup.com

© Copyright 2018 Construction Specialties, Inc.