

GFT-M

TECHNICAL DATA:

Aluminum

- Extrusion – CS uses multiple alloys & tempers which are established to be the most appropriate for the given use of individual parts. Will be one of the following: (6063-T5, T6, T52) (6061-T5, T6, T51) (6105-T5, T6) (6005-T5) (6005A-T5, T61), ASTM B221

Primary Seal

- Dual Durometer 65 Shore A, 90 Shore A, ASTM D2240
- Available in 5 Standard colors

Frame Heights

- 1", 1.5", 2", 2.5" & 3" for 1" models
- 1", 1.5", 2" & 3" for 2" models

Standard Loading

- 500 lbs.

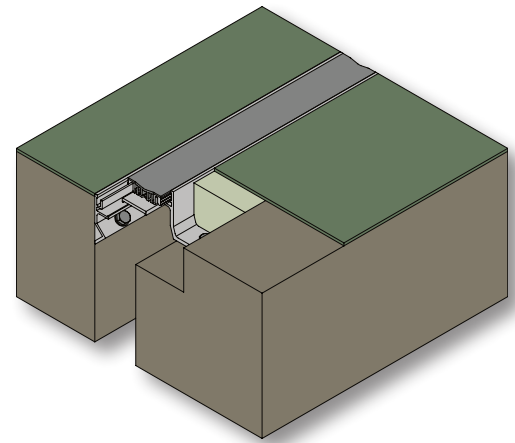

MODEL	JOINT WIDTH	MINIMUM OPENING	MAXIMUM OPENING	EXPOSED SURFACE	BLOCKOUT WIDTH	BLOCKOUT HEIGHT
GFT-100M	1.00" (25mm)	0.75" (19mm)	1.25" (32mm)	1.25" (32mm)	2.50" (64mm)	1 THRU 3
GFT-200M	2.00" (51mm)	1.50" (38mm)	2.50" (64mm)	1.88" (48mm)	2.50" (64mm)	1 THRU 3

