

SF Series

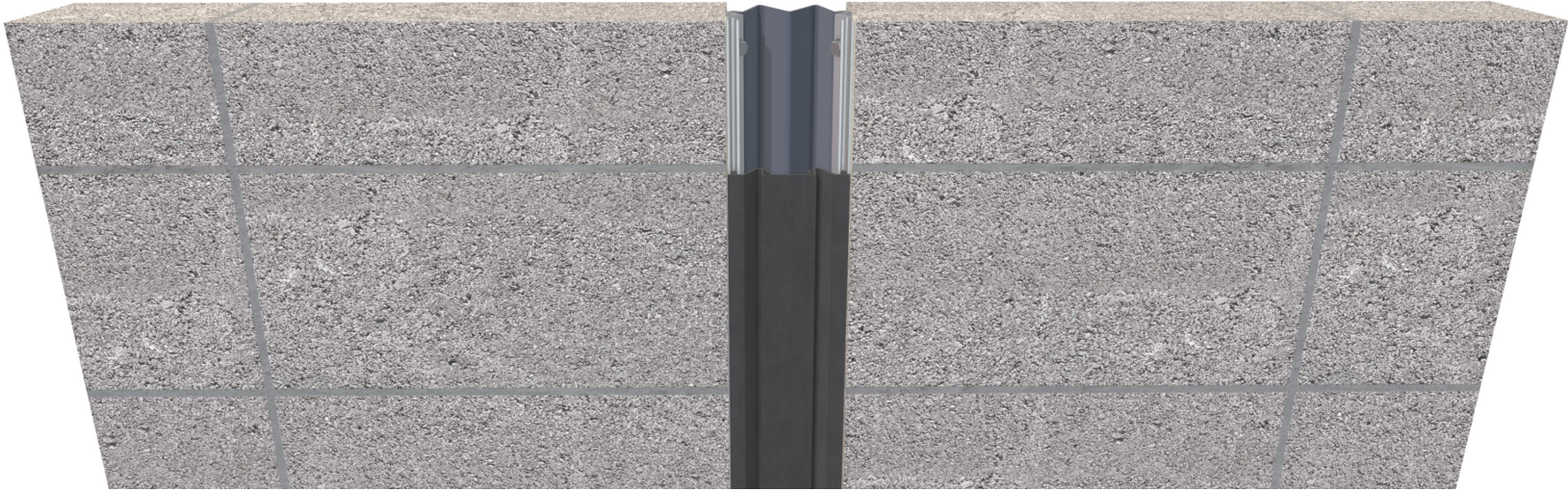

This gasketed, flush cover system is designed to offer multi-directional movement in vertical wall applications where weather protection is critical. A secondary seal ensures weather tightness.

Product Details

- Joint sizes range from 1" to 10" (25.4mm to 254mm)
- 10' (3.048m) stock lengths
- Select sizes and colors are in stock for fast shipping
- Different frame options available for a variety of substrates
- Capable of lateral movement
- Meets ASTM E1399
- Standard Five-Year Warranty

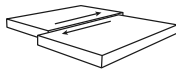

Fire Barrier

Gasket Color Options



Applications

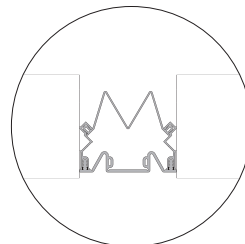

2"- 4" Wall to Wall

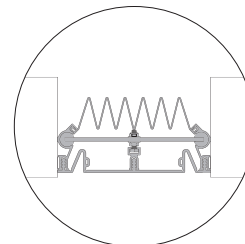

5"- 8" Wall to Wall

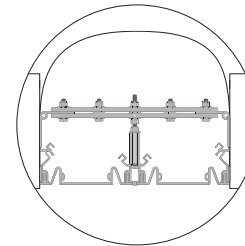

9"- 12" Wall to Wall

Aluminum in contact with concrete/masonry will have a 2 mil, heavy metal free, high solids primer. For custom applications, loading or finishes, contact your Representative.



Additional resources

SF Wall to Wall

[Buy Online](#)

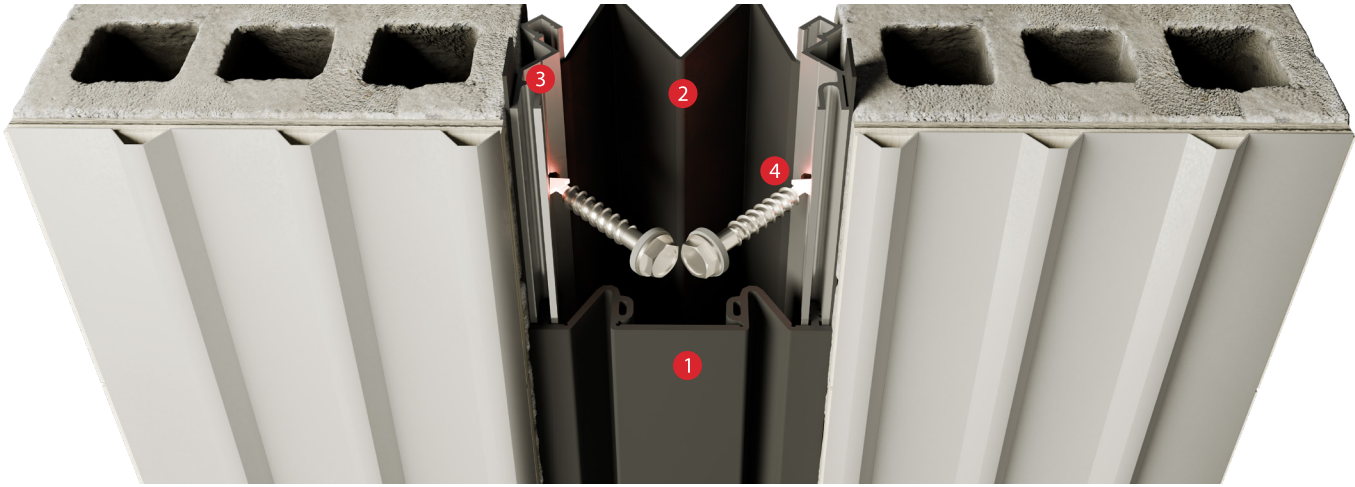

- 1. Primary seal
- 2. Secondary seal
- 3. Continuous extruded aluminum center frame
- 4. Fastener

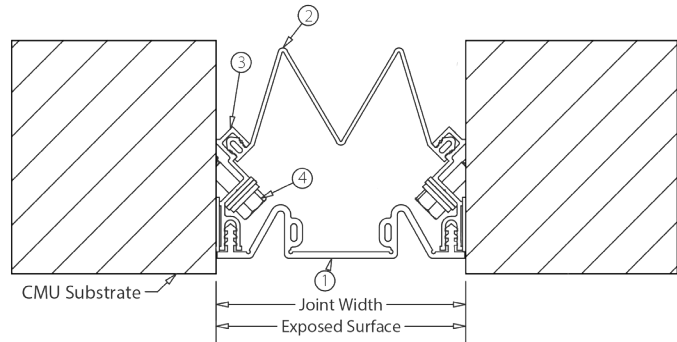

Wall to Wall Performance Data

MODEL	JOINT WIDTH	MIN. OPENING	MAX. OPENING	EXPOSED SURFACE	BLOCKOUT WIDTH	BLOCKOUT HEIGHT
SF-200	2.00" (51mm)	1.25" (32mm)	3.00" (76mm)	2.00" (51mm)	N/A	N/A
SF-300	3.00" (76mm)	1.25" (32mm)	4.50" (114mm)	3.00" (76mm)	N/A	N/A
SF-400	4.00" (102mm)	1.25" (32mm)	6.00" (152mm)	4.00" (102mm)	N/A	N/A
SF-500	5.00" (127mm)	1.25" (32mm)	7.50" (191mm)	5.00" (127mm)	N/A	N/A
SF-600	6.00" (152mm)	1.75" (44mm)	9.00" (229mm)	6.00" (152mm)	N/A	N/A
SF-700	7.00" (178mm)	2.50" (64mm)	10.50" (267mm)	7.00" (178mm)	N/A	N/A
SF-800	8.00" (203mm)	2.50" (64mm)	12.00" (305mm)	8.00" (203mm)	N/A	N/A
SF-900	9.00" (229mm)	2.50" (64mm)	13.50" (343mm)	9.00" (229mm)	N/A	N/A
SF-1000	10.00" (254mm)	2.50" (64mm)	15.00" (381mm)	10.00" (254mm)	N/A	N/A
SF-1100	11.00" (279mm)	6.00" (152mm)	16.50" (419mm)	11.00" (279mm)	N/A	N/A

(Continued on next page)

SF Wall to Wall

Wall to Wall Performance Data (Continued)

MODEL	JOINT WIDTH	MIN. OPENING	MAX. OPENING	EXPOSED SURFACE	BLOCKOUT WIDTH	BLOCKOUT HEIGHT
SF-1200	12.00" (305mm)	6.00" (152mm)	18.00" (457mm)	12.00" (305mm)	N/A	N/A
SF-1300	13.00" (330mm)	6.00" (152mm)	19.50" (495mm)	13.00" (330mm)	N/A	N/A
SF-1400	14.00" (356mm)	6.00" (152mm)	21.00" (533mm)	14.00" (356mm)	N/A	N/A
SF-1500	15.00" (381mm)	6.00" (152mm)	22.50" (572mm)	15.00" (381mm)	N/A	N/A
SF-1600	16.00" (406mm)	6.00" (152mm)	24.00" (610mm)	16.00" (406mm)	N/A	N/A
SF-1700	17.00" (432mm)	6.00" (152mm)	25.50" (648mm)	17.00" (432mm)	N/A	N/A
SF-1800	18.00" (457mm)	6.00" (152mm)	27.00" (686mm)	18.00" (457mm)	N/A	N/A
SF-1900	19.00" (483mm)	6.00" (152mm)	28.50" (724mm)	19.00" (483mm)	N/A	N/A
SF-2000	20.00" (508mm)	6.00" (152mm)	30.00" (762mm)	20.00" (508mm)	N/A	N/A
SF-2100	21.00" (533mm)	9.00" (229mm)	31.50" (800mm)	21.00" (533mm)	N/A	N/A
SF-2200	22.00" (559mm)	9.00" (229mm)	33.00" (838mm)	22.00" (559mm)	N/A	N/A
SF-2300	23.00" (584mm)	9.00" (229mm)	34.50" (876mm)	23.00" (584mm)	N/A	N/A
SF-2400	24.00" (610mm)	9.00" (229mm)	36.00" (914mm)	24.00" (610mm)	N/A	N/A

Material Details

- Aluminum extrusions made from multiple alloys & tempers established to be the most appropriate for the given use of individual parts. Will be one of the following:
 - (6063-T5, T6, T52) (6061-T5, T6, T51) (6105-T5, T6) (6005-T5) (6005A-T5, T61), ASTM B221
- Primary Seal
 - Material: Santoprene-TPV 8221-70 (all standard colors)
 - Single Durometer: 75 Shore-A, ASTM D2240
 - Brittle Point: -76°F
 - Ozone Resistance: No Cracks, ASTM D1149
 - UV Resistance: Very Good
- Secondary Seal (Models SF-200 - SF-1000)
 - Material – PVC ASTM D2000
 - Durometer – 65 Shore A
- Vapor Barrier (Models SF-1100 - SF-2400)
 - Material: 7-Ply Polyethylene, ASTM-E-1745-11
 - Color: Black
 - 3" Tensile Strength: 275 lbs., ASTM-D-882
 - Puncture Strength: 79 lbs., ASTM-D-4833
 - PPT Resistance: 62 lbs., ASTM-D-2582