

# ZBSM Series

## TECHNICAL DATA:

### Load Capacity

- 3,000 lbs. concentrated load per IBC2009 T1607.1

### Seal

- Material - EPDM
- Color - Black
- Durometer - 75 Shore A, ASTM D2240

### Epoxy

- 2 part
- Gel Time - 35 minutes, ASTM C881
- Bond Strength (2 day cure) - 2,500 psi, ASTM C882
- Bond Strength (14 day cure) - 4,000 psi, ASTM C882
- Compressive Modulus - 285,100 psi, ASTM D695

### Edge Sealant

- Tack free time - 35 minutes, ASTM C679
- Hardness - 30 Shore A, ASTM C661

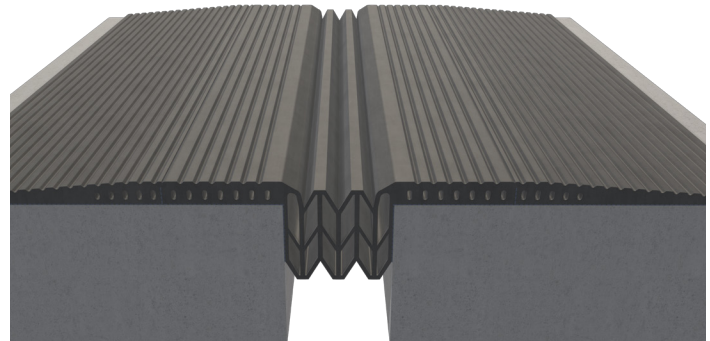

MODEL	JOINT WIDTH	MINIMUM OPENING	MAXIMUM OPENING	EXPOSED SURFACE	BLOCKOUT WIDTH	BLOCKOUT HEIGHT
ZBSM-100	1.00" (25mm)	0.50" (13mm)	1.50" (38mm)	21.25" (540mm)	N/A	N/A
ZBSM-200	2.00" (51mm)	1.00" (25mm)	3.00" (76mm)	22.25" (565mm)	N/A	N/A
ZBSM-300	3.00" (76mm)	1.50" (38mm)	4.50" (114mm)	23.25" (591mm)	N/A	N/A
ZBSM-400	4.00" (102mm)	2.00" (51mm)	6.00" (152mm)	24.25" (616mm)	N/A	N/A
ZBSM-100ALT	1.00" (25mm)	0.50" (13mm)	1.50" (38mm)	11.13" (283mm)	N/A	N/A
ZBSM-200ALT	2.00" (51mm)	1.00" (25mm)	3.00" (76mm)	12.13" (308mm)	N/A	N/A
ZBSM-300ALT	3.00" (76mm)	1.50" (38mm)	4.50" (114mm)	13.13" (333mm)	N/A	N/A
ZBSM-400ALT	4.00" (102mm)	2.00" (51mm)	6.00" (152mm)	14.13" (359mm)	N/A	N/A

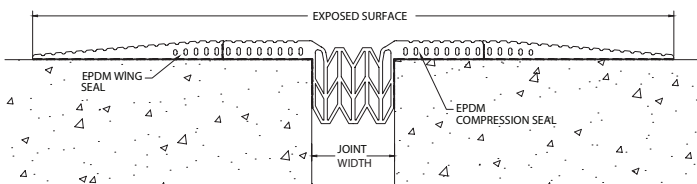

ZBSM

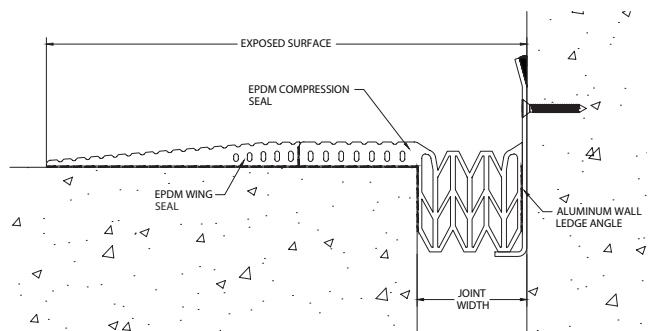

ZBSM (ALT)