

**HR-8CN HANDRAIL
WITH INTERNATIONAL OFFSET**

PLEASE READ

PLEASE READ THESE INSTRUCTIONS THOROUGHLY PRIOR TO BEGINNING THE HR-8CN-INT HANDRAIL INSTALLATION!

THIS INSTRUCTION SHEET IS INTENDED TO PROVIDE A SPECIFIC GUIDE TO FOLLOW FOR THE INSTALLATION OF HR-8CN-INT HANDRAIL. CONTAINED WITHIN IS THE THE TECHNICAL INFORMATION AND INSTALLATION TECHNIQUES REQUIRED TO COMPLETE AN EFFICIENT, NEAT AND LONG-LASTING INSTALLATION.

INSPECT ALL MATERIALS FOR DAMAGE OR MISSING PARTS. IF YOU DISCOVER DAMAGED OR MISSING MATERIALS, IN THE USA PLEASE NOTIFY THE FACTORY AT (800) 233-8493, AND IN CANADA (888) 895-8955.

HR-8CN-INT HANDRAIL MUST BE INSTALLED IN ACCORDANCE WITH THESE INSTRUCTIONS! FAILURE TO FOLLOW THESE INSTRUCTIONS MAY VOID ANY PRODUCT WARRANTIES AND RESULT IN AN UNSUCCESSFUL INSTALLATION. FOR SPECIFIC QUESTIONS REGARDING THE INSTALLATION OF HR-8CN-INT HANDRAIL PLEASE CALL THE FACTORY AT (800) 233-8493 OR EMAIL IWPTECHSUPPORT@C-SGROUP.COM. IN CANADA CALL (888) 895-8955.

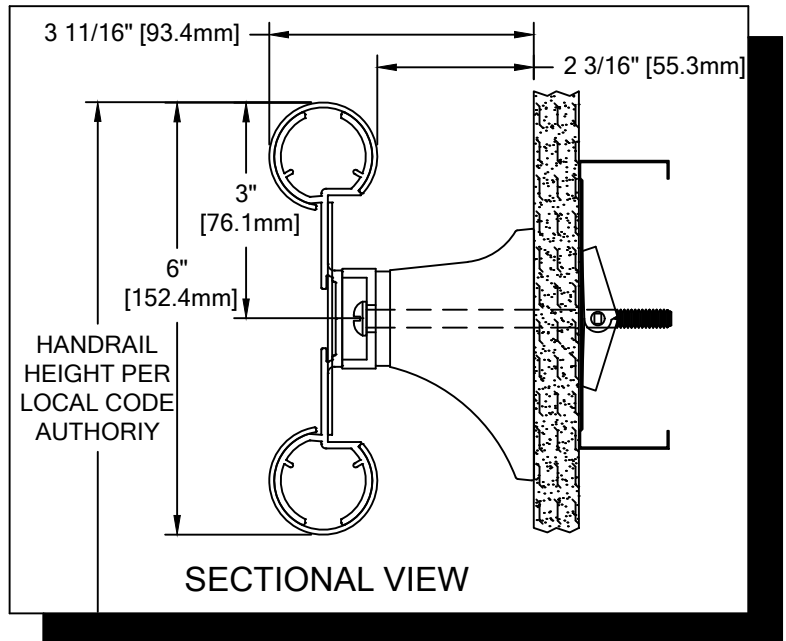

IMPORTANT NOTES

1. ALL LINEAL MATERIAL TO BE SUPPLIED IN STOCK LENGTHS. ALUMINUM AND ACROVYN IN 20'-0" LENGTHS. THIS MATERIAL IS TO BE FIELD CUT USING QUALITY EQUIPMENT TO INSURE THAT ALL CUTS ARE SQUARE. WHEN CUTTING MATERIAL SECTIONS, C/S RECOMMENDS USING AN 80-100 TOOTH CARBIDE TIPPED SAW BLADE OR EQUIVALENT, TO MINIMIZE CHIPPING AND MAINTAIN JOINT ALIGNMENT.
2. ALL DIMENSIONS ARE TYPICAL.
3. FOR DRYWALL/PLASTER WALL CONSTRUCTION, IT IS RECOMMENDED FOR FASTENERS TO BE ENGAGED INTO METAL/WOOD STUDS TO MAINTAIN MAXIMUM PULLOUT STRENGTH. IF DURING INSTALLATION YOU ENCOUNTER SPECIAL WALL CONDITIONS THAT DO NOT ALLOW FOR DIRECT ATTACHMENT TO THE STUDS PLEASE CONSULT THE LOCAL AUTHORITY HAVING JURISDICTION.
4. INSTALL OUTSIDE CORNERS FIRST.
5. INSTALL LONGEST RUN OF HANDRAIL FIRST.
6. ALUMINUM RETAINER SPLICES SHOULD NOT EXCEED 3" [76.2mm] DISTANCE FROM A BRACKET.
7. THE DISTANCE BETWEEN AN ACROVYN SPLICE JOINT AND AN ALUMINUM RETAINER SPLICE JOINT SHOULD BE STAGGERED 2" [50.8mm].
8. MATERIAL MUST REACH 65°F MIN. TO 75°F MAX. 24 HOURS PRIOR TO INSTALLATION. THIS IS ESSENTIAL TO MINIMIZE EXPANSION AND CONTRACTION OF MATERIAL.
9. MAY REQUIRE USE OF FIRE PUTTY WHEN INSTALLED ON FIRE WALL WITH TOGGLE BOLTS. REFERENCE INSTRUCTIONS 24FIREPUTTY FOR FIRE PUTTY INSTALLATION.
10. THIS HANDRAIL REQUIRES A MINIMUM OF 2 MOUNTING BRACKETS PER UNIT. THE MINIMUM END CAP-TO-END CAP HANDRAIL LENGTH IS 10-1/4" [260mm].
11. FOR MORE INFORMATION ON HR-8CN HANDRAIL SEE OUR WEBSITE AT www.c-sgroup.com

HR-8CN HANDRAIL
WITH INTERNATIONAL OFFSET

COMPONENTS & WALL FASTENERS



ACROVYN 4000 COVER
(24U032xxx)
ACROVYN CHAMELEON
(24U610xxx)



ACROVYN REVEAL STRIP
(25S011xxx)
CHAMELEON REVEAL STRIP
(25S174xxx)

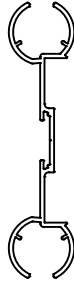

ALUMINUM RETAINER
(24A150000)

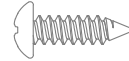

FASTENER #1
#10 X 3/4" PHILLIPS
PANHEAD TEK
(90H739002)

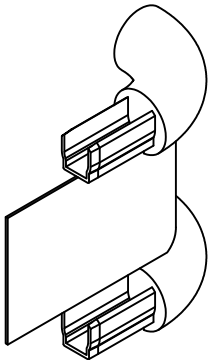

HANDRAIL END CAP ASSEMBLY
(RIGHT-HAND SHOWN)
(LEFT-HAND AVAILABLE)

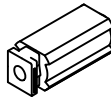

ALIGNMENT PLUG
(24I051000)

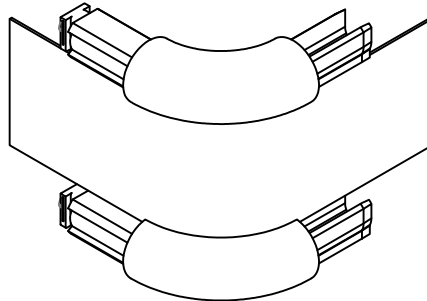

HANDRAIL OUTSIDE
CORNER ASSEMBLY

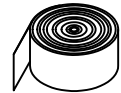

3/4" MACTAC TAPE
(90M171002)

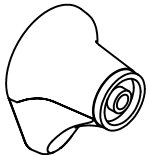

MOUNTING BRACKET
(24I007xxx)



BRACKET
EXTENSION
(24I080000)

WALL CONDITION	SPECIFIED FASTENER	DRILL DIAMETERS		C/S PART NUMBER
		WALL	RETAINER	
STEEL STUD/GYPSUM WALL	1/4-20 X 5" ROUND HEAD BOLT WITH TOGGLE, AND LOCK WASHER	3/4"	9/32"	90H049002 90H006003
CONCRETE/CONCRETE BLOCK	#14 X 4" PHILLIPS ROUND HEAD S/S AP SCREW	7/32"	9/32"	90H225006
WOOD STUD/GYPSUM WALL	#14 X 4" PHILLIPS ROUND HEAD S/S AP SCREW	7/32"	9/32"	90H225006

HR-8CN-INT HANDRAIL
WITH INTERNATIONAL OFFSET

LAYOUT VIEW

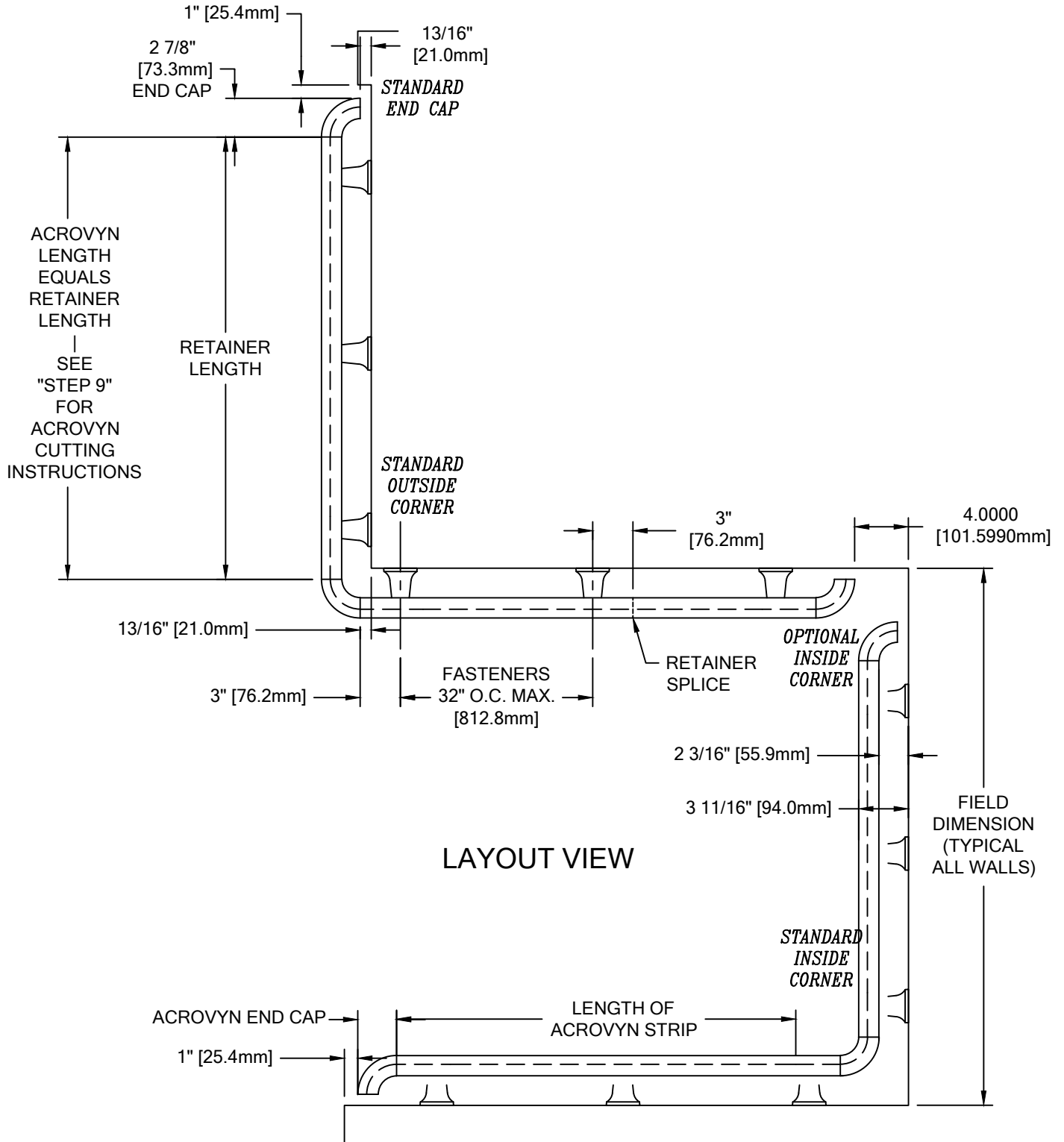

**HR-8CN HANDRAIL
WITH INTERNATIONAL OFFSET**

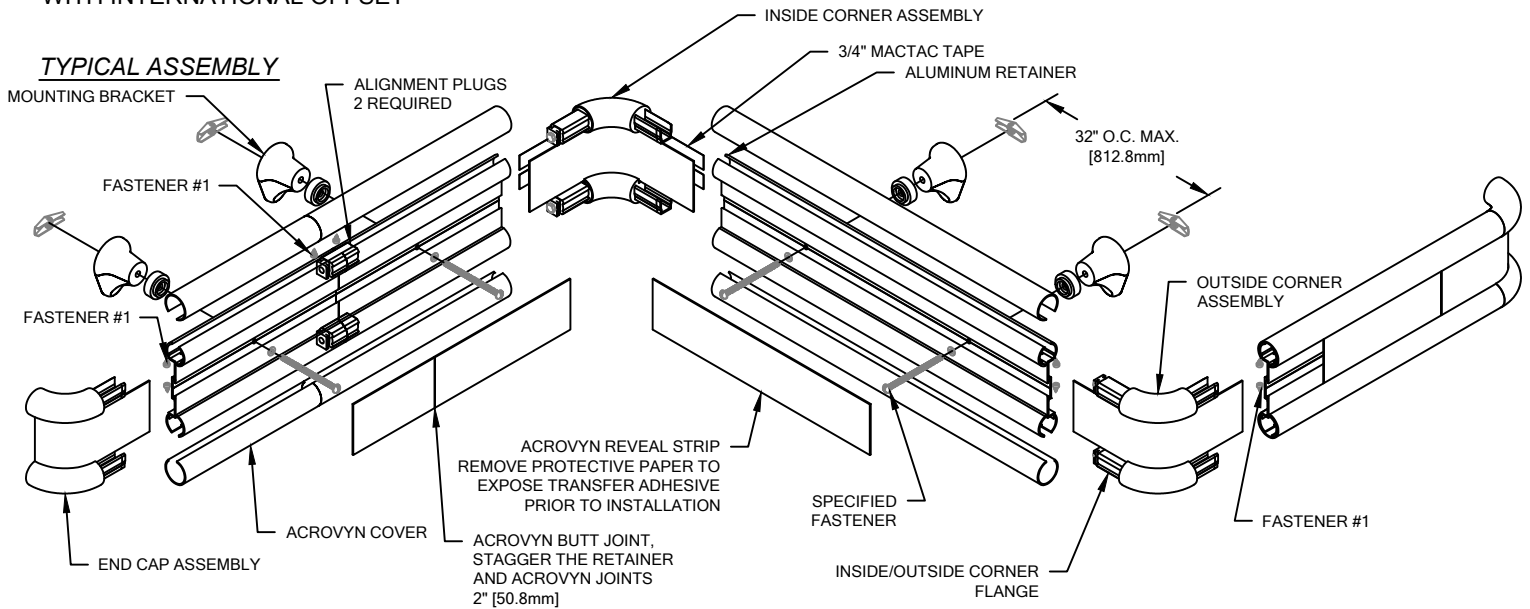

1. USING LOCAL CODE REQUIREMENTS, ESTABLISH HANDRAIL HEIGHT ABOVE FINISH FLOOR. DEDUCT 3" [76.2mm] AND SNAP A CHALK LINE AT THAT HEIGHT. THIS MARKS THE LOCATION OF THE HOLE FOR THE MOUNTING BRACKET FASTENER.
2. CUT THE CONTINUOUS ALUMINUM RETAINER TO LENGTH USING THE REQUIRED DEDUCTIONS (REFERENCE LAYOUT VIEW). PRE-DRILL CLEARANCE HOLES FOR THE SPECIFIED WALL FASTENERS IN THE ALUMINUM RETAINER 3" [76.2mm] FROM EACH END. REFERENCE CHART ON PAGE 2 FOR CORRECT DRILL DIAMETERS. ALL OTHER BRACKET HOLES MUST NOT EXCEED 32" [812.8mm] ON CENTER.

NOTE: IT IS RECOMMENDED THAT THE ACROVYN COVER AND ALUMINUM RETAINER BE CUT WITH AN 80-100 TOOTH CARBIDE TIPPED SAW BLADE OR EQUIVALENT.

3. DRILL CLEARANCE HOLES IN WALL SURFACE FOR MOUNTING HARDWARE, USING THE RETAINER AS A TEMPLATE. REFERENCE CHART ON PAGE 2 FOR CORRECT DRILL DIAMETERS.
4. ATTACH ALL END CAPS/INSIDE/OUTSIDE CORNERS BY:
 - DRILL 11/64" DIAMETER CLEARANCE HOLES IN RETAINER 3/4" [19.1mm] FROM THE END OF THE RETAINER.
 - INSERT THE END CAPS INTO THE RETAINER.
 - DRILL 1/8" DIAMETER PILOT HOLES INTO THE END CAP.
 - CLEAN BACKSIDE OF ACROVYN END CAP STRIP AND APPLY 3/4" MACTAC TAPE.
 - ATTACH END CAP TO RETAINER USING #8 X 3/8" PHILLIPS PAN HEAD SHEET METAL SCREW.
 - RUB THE SURFACE OF THE ACROVYN STRIP WITH A CLEAN CLOTH OR SMOOTHING BRUSH TO ENSURE MAXIMUM ADHESION.

NOTE: TO AID IN LOCATING THE END CAPS CORRECTLY, CUT A 4" [101.6mm] SECTION OF COVER FROM SCRAP AND SNAP IT ON THE RETAINER. LOCATE THE CAP SO IT ALIGNS FLUSH WITH TOP AND BOTTOM OF THE COVER.

5. INSTALL EACH SECTION OF RETAINER, IN SUCCESSION, USING THE WALL BRACKETS AND APPROPRIATE HARDWARE.
6. CUT THE ACROVYN STRIP TO THE PROPER LENGTH. THE STRIP LENGTH IS DETERMINED BY MEASURING THE DISTANCE BETWEEN THE INSTALLED END CAPS AND/OR INSIDE/OUTSIDE CORNER ASSEMBLIES.
7. BEFORE APPLYING THE 3" [76.2mm] WIDE ACROVYN REVEAL STRIP TO THE RETAINER, MAKE SURE THE RETAINER SURFACE HAS BEEN THOROUGHLY CLEANED AND IS DRY; FREE OF ANY DIRT, OIL OR GREASE.
8. APPLY THE 3" [76.2mm] WIDE ACROVYN REVEAL STRIP TO THE RETAINER BY REMOVING THE PROTECTIVE PAPER FROM THE ADHESIVE. ALIGN THE STRIP WITH THE END OF THE END CAP. RUB THE SURFACE OF THE ACROVYN STRIP WITH A CLEAN CLOTH OR SMOOTHING BRUSH TO ENSURE MAXIMUM ADHESION.
9. CUT THE ACROVYN COVER TO THE PROPER LENGTH. THE COVER LENGTH IS DETERMINED BY MEASURING THE DISTANCE BETWEEN THE INSTALLED END CAPS AND/OR INSIDE/OUTSIDE CORNER ASSEMBLIES.

NOTE: IT IS RECOMMENDED THAT THE ACROVYN COVER BE CUT SLIGHTLY LONGER (1/32" [0.8mm] UP TO 5'-0" [1.5m], 1/16" [1.6mm] OVER 5'-0" [1.5m]) THAN THE MEASURED DISTANCE. THIS ADDITIONAL LENGTH WILL PROVIDE FOR A TIGHTER COVER-TO-END CAP FIT.

10. STARTING AT ONE END, SNAP THE TOP AND BOTTOM SECTIONS OF THE COVER ONTO THE RETAINER. APPLY PRESSURE OVER THE ENTIRE LENGTH.

NOTE: MANUFACTURER RECOMMENDS ALL PRINTED "PRODUCT IDENTIFICATION" ON THE REAR OF THE ACROVYN PROFILE SHALL BE ORIENTED IN THE SAME DIRECTION DURING INSTALLATION TO ENSURE PROPER ALIGNMENT AT SPLICE BUTT JOINTS.