

## XLS-2G Series



Model XLS-2G

This wall cover is designed for exterior applications where concealment is desired, where high wind loads are expected, or where lateral shear is required. This re-engineered system has a modular design with lightweight magnets and a compact pulley system making it easier to install and modify in the field. The center pan accepts a variety of cladding infill (provided by others) such as metal, glass and stone to match surrounding finishes for a truly seamless look.

### Advantages

- Concealed cover with minimal sightlines
- Modular system allows for quick installation and field modifications
- Accommodates high wind loads, lateral shear, and seismic movement
- Safety cables prevent damage to surrounding finishes during a seismic event
- Magnet and pulley system return cover to nominal position after a seismic event
- Accepts a variety of cladding infill such as metal, glass or stone up to 1/2" thick (supplied by others)
- Can be supplied in custom heights and widths to match building aesthetics
- Vapor barrier included



[View 3D Model](#) →

# XLS-2G Series

## Product Details

- Joint sizes range from 8" to 24" (203.2mm to 609.6mm)
- 10' (304.8cm) stock lengths
- Meets ASTM E1399



Vapor Barrier



Fire Barrier

## Model Details

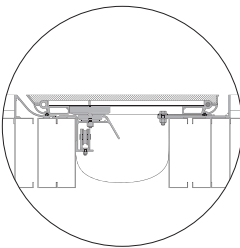

Wall to Wall

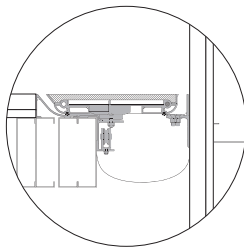

Corner Wall

MODEL	WALL TO WALL	CORNER WALL (C)
XLS-2G	●	
XLSC-2G		●

## Standard Finish



Mill

## Infill Options\*

- Metal
- Glass
- Stone

Aluminum in contact with concrete/masonry will have a 2 mil heavy metal free high solids primer

See all finish options online at [c-sgroup.com](http://c-sgroup.com).

\*Up to 1/2" thick, provided by others, weight limits apply

## Warranty

- Standard Five-Year Warranty



Learn More →