

# GFS-WL & GFSW-WL

## TECHNICAL DATA:

### Aluminum

- Extrusion – CS uses multiple alloys & tempers which are established to be the most appropriate for the given use of individual parts. Will be one of the following: (6063-T5, T6, T52) (6061-T5, T6, T51) (6105-T5, T6) (6005-T5) (6005A-T5, T61), ASTM B221

### Seal

- Dual Durometer 65 Shore A, 90 Shore A, ASTM-D2000
- Available in 5 Standard colors.



MODEL	JOINT WIDTH	MINIMUM OPENING	MAXIMUM OPENING	EXPOSED SURFACE	BLOCKOUT WIDTH	BLOCKOUT HEIGHT
GFS-100WL	1.00" (25mm)	0.75" (19mm)	1.25" (32mm)	4.31" (109mm)	N/A	N/A
GFS-200WL	2.00" (51mm)	1.50" (38mm)	2.50" (64mm)	5.13" (130mm)	N/A	N/A
GFSW-100WL	1.00" (25mm)	0.75" (19mm)	1.25" (32mm)	2.63" (67mm)	N/A	N/A
GFSW-200WL	2.00" (51mm)	1.50" (38mm)	2.50" (64mm)	3.56" (90mm)	N/A	N/A

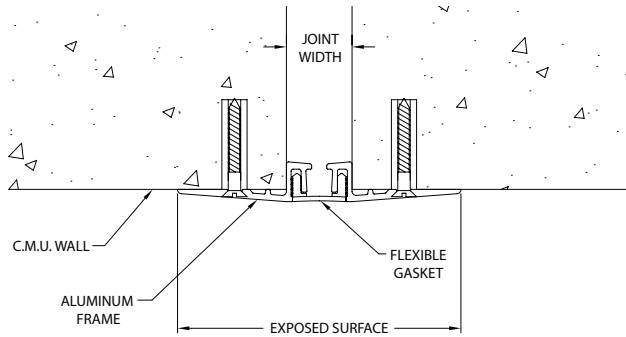

GFS-100WL

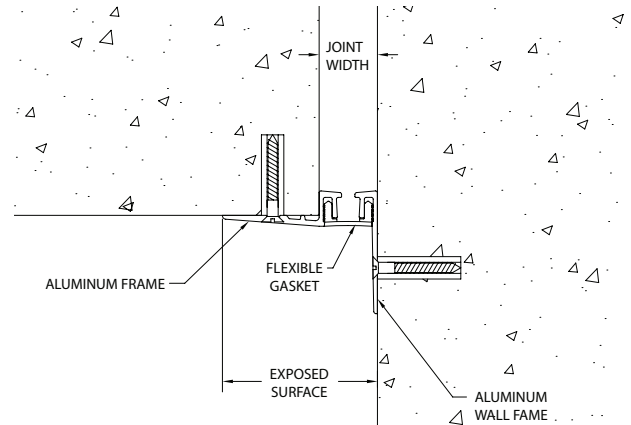

GFSW-100WL

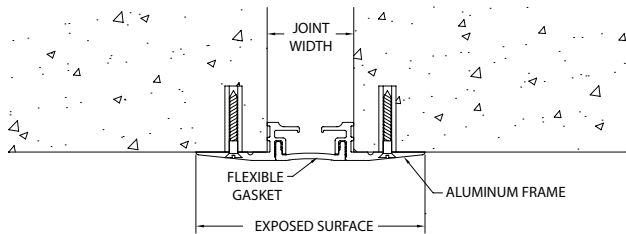

GFS-200WL

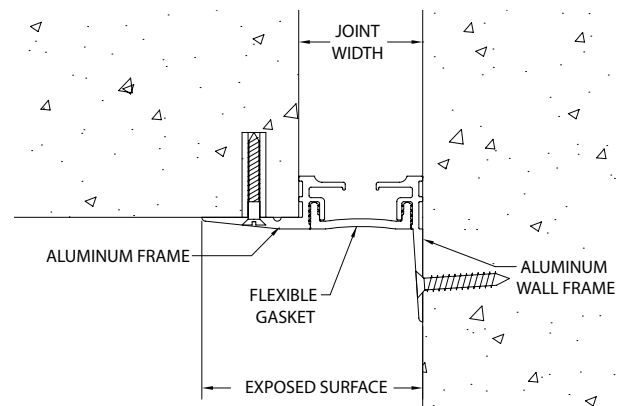

GFSW-200WL