

# PC-2G Series



This surface-mounted metal floor cover is designed for interior and exterior applications and is available in custom widths and heavy-duty versions. The single plate design is anchored to one slab to allow movement over the adjacent slab.

## Product Details

- Joint sizes range from 1" to 16" (25.4mm to 406.4mm)
- 10' (3.048m) stock lengths
- Applicable for Gypsum and CMU substrates
- Standard loading up to 500 lbs
- Select sizes are in stock for fast shipping
- Meets ASTM E1399
- Standard Five Year Warranty



## Standard Finish



Mill

## Applications

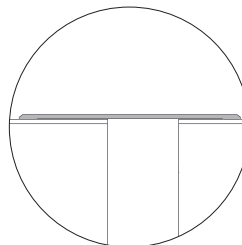

Floor to Floor

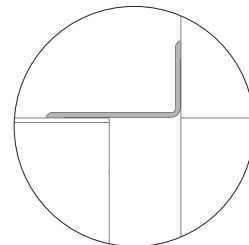

Floor to Wall

Aluminum in contact with concrete/masonry will have a 2 mil, heavy metal free, high solids primer. For custom applications, loading or finishes, contact your Representative.



Additional resources

# PC-2G - Floor to Floor

[Buy Online](#)

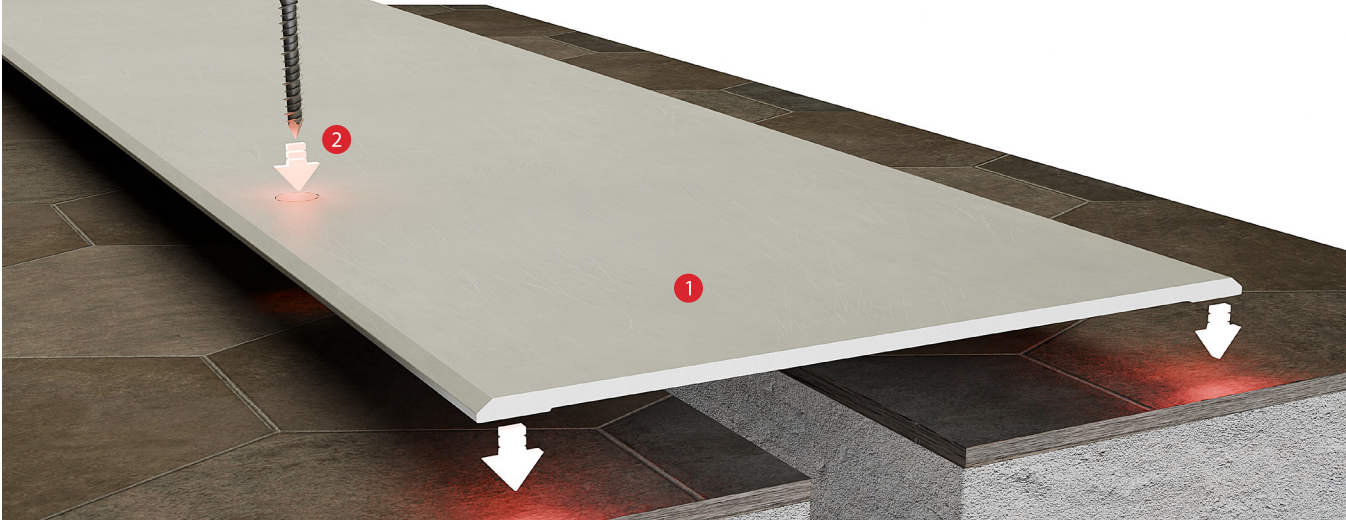

- 1. Floating extruded aluminum center plate
- 2. Fastener

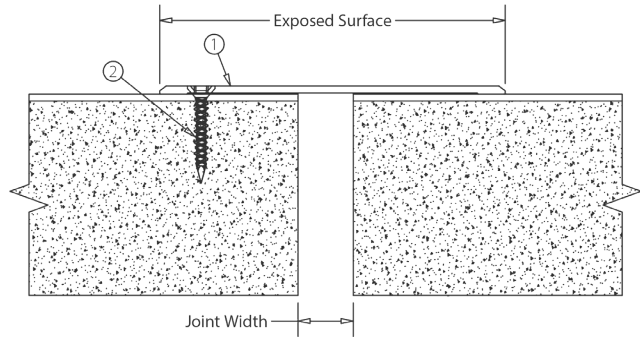

## Floor to Floor Performance Data

MODEL	JOINT WIDTH	MIN. OPENING	MAX. OPENING	EXPOSED SURFACE	BLOCKOUT WIDTH	BLOCKOUT HEIGHT
PC2G-100	1.00" (25mm)	0.00" (0mm)	3.50" (89mm)	6.25" (159mm)	N/A	N/A
PC2G-200	2.00" (51mm)	0.00" (0mm)	3.50" (89mm)	6.25" (159mm)	N/A	N/A
PC2G-300	3.00" (76mm)	0.00" (0mm)	6.50" (165mm)	9.25" (235mm)	N/A	N/A
PC2G-400	4.00" (102mm)	0.00" (0mm)	6.50" (165mm)	9.25" (235mm)	N/A	N/A
PC2G-500	5.00" (127mm)	0.00" (0mm)	8.00" (203mm)	10.75" (273mm)	N/A	N/A
PC2G-600	6.00" (152mm)	0.00" (0mm)	9.50" (241mm)	12.25" (311mm)	N/A	N/A
PC2G-700	7.00" (178mm)	0.00" (0mm)	11.00" (279mm)	13.75" (349mm)	N/A	N/A
PC2G-800	8.00" (203mm)	0.00" (0mm)	12.50" (318mm)	15.25" (387mm)	N/A	N/A

This model is also available in Stainless Steel (PC2G-xxxS) or Bronze (PC2G-xxxB).

(Continued on next page)

## PC-2G - Floor to Floor

### Floor to Floor Performance Data (Continued)

MODEL	JOINT WIDTH	MIN. OPENING	MAX. OPENING	EXPOSED SURFACE	BLOCKOUT WIDTH	BLOCKOUT HEIGHT
PC2G-900	9.00" (229mm)	0.00" (0mm)	14.00" (356mm)	16.75" (425mm)	N/A	N/A
PC2G-1000	10.00" (254mm)	0.00" (0mm)	15.50" (394mm)	18.25" (464mm)	N/A	N/A
PC2G-1100	11.00" (279mm)	0.00" (0mm)	17.00" (432mm)	19.75" (502mm)	N/A	N/A
PC2G-1200	12.00" (305mm)	0.00" (0mm)	18.50" (470mm)	21.25" (540mm)	N/A	N/A
PC2G-1300	13.00" (330mm)	0.00" (0mm)	20.00" (508mm)	22.75" (578mm)	N/A	N/A
PC2G-1400	14.00" (356mm)	0.00" (0mm)	21.50" (546mm)	24.25" (616mm)	N/A	N/A
PC2G-1500	15.00" (381mm)	0.00" (0mm)	23.00" (584mm)	25.75" (654mm)	N/A	N/A
PC2G-1600	16.00" (406mm)	0.00" (0mm)	24.50" (622mm)	27.25" (692mm)	N/A	N/A

*This model is also available in Stainless Steel (PC2G-xxxS) or Bronze (PC2G-xxxB).*

# PCW-2G - Corner Wall

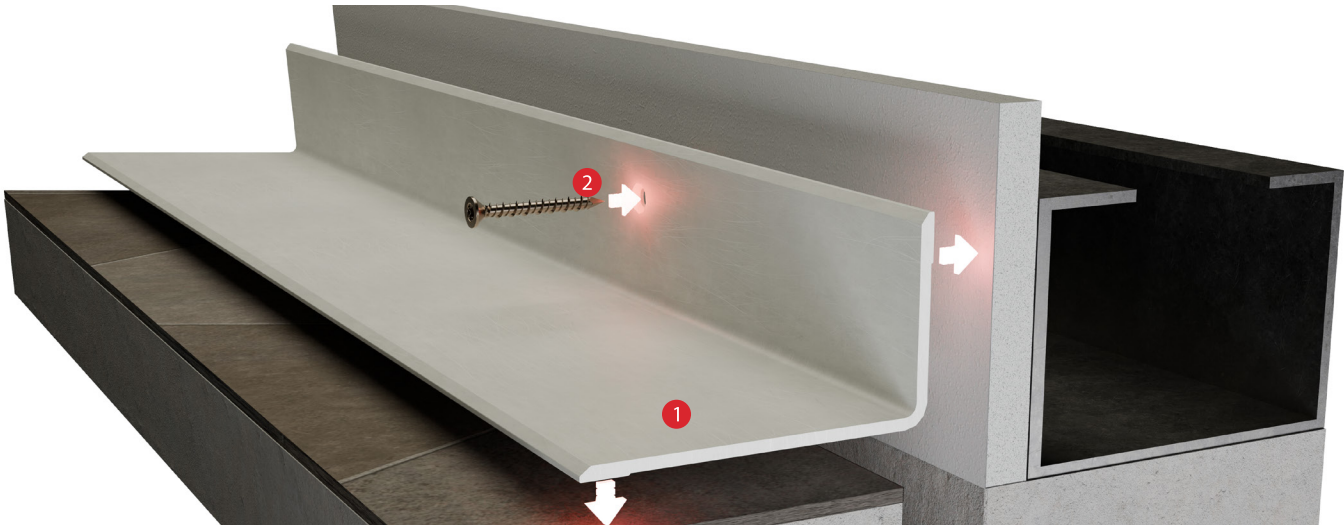

- 1. Floating extruded aluminum plate
- 2. Fastener

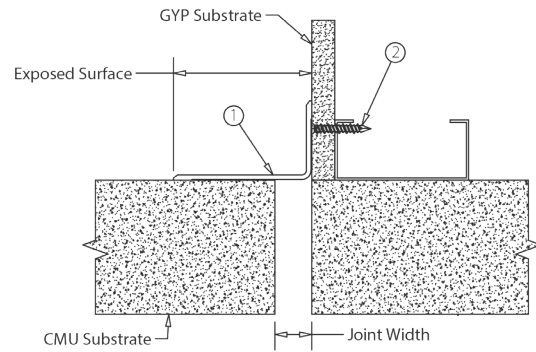

## Corner Wall - Gypsum Performance Data

MODEL	JOINT WIDTH	MIN. OPENING	MAX. OPENING	EXPOSED SURFACE	BLOCKOUT WIDTH	BLOCKOUT HEIGHT
PCW2G-100	1.00" (25mm)	0.00" (0mm)	3.50" (89mm)	3.75" (95mm)	N/A	N/A
PCW2G-200	2.00" (51mm)	0.00" (0mm)	3.50" (89mm)	3.75" (95mm)	N/A	N/A
PCW2G-300	3.00" (76mm)	0.00" (0mm)	6.50" (165mm)	6.75" (171mm)	N/A	N/A
PCW2G-400	4.00" (102mm)	0.00" (0mm)	6.50" (165mm)	6.75" (171mm)	N/A	N/A
PCW2G-500	5.00" (127mm)	0.00" (0mm)	8.00" (203mm)	8.25" (210mm)	N/A	N/A
PCW2G-600	6.00" (152mm)	0.00" (0mm)	9.50" (241mm)	9.75" (248mm)	N/A	N/A
PCW2G-700	7.00" (178mm)	0.00" (0mm)	11.00" (279mm)	11.25" (286mm)	N/A	N/A
PCW2G-800	8.00" (203mm)	0.00" (0mm)	12.50" (318mm)	12.75" (324mm)	N/A	N/A

This model is also available in Stainless Steel (PCW2G-xxxS) or Bronze (PCW2G-xxxB).

(Continued on next page)

## PCW-2G - Corner Wall

### Corner Wall - Performance Data (Continued)

MODEL	JOINT WIDTH	MIN. OPENING	MAX. OPENING	EXPOSED SURFACE	BLOCKOUT WIDTH	BLOCKOUT HEIGHT
PCW2G-900	9.00" (229mm)	0.00" (0mm)	14.00" (356mm)	14.25" (362mm)	N/A	N/A
PCW2G-1000	10.00" (254mm)	0.00" (0mm)	15.50" (394mm)	15.75" (400mm)	N/A	N/A
PCW2G-1100	11.00" (279mm)	0.00" (0mm)	17.00" (432mm)	17.25" (438mm)	N/A	N/A
PCW2G-1200	12.00" (305mm)	0.00" (0mm)	18.50" (470mm)	18.75" (476mm)	N/A	N/A
PCW2G-1300	13.00" (330mm)	0.00" (0mm)	20.00" (508mm)	20.25" (514mm)	N/A	N/A
PCW2G-1400	14.00" (356mm)	0.00" (0mm)	21.50" (546mm)	21.75" (552mm)	N/A	N/A
PCW2G-1500	15.00" (381mm)	0.00" (0mm)	23.00" (584mm)	23.25" (591mm)	N/A	N/A
PCW2G-1600	16.00" (406mm)	0.00" (0mm)	24.50" (622mm)	24.75" (629mm)	N/A	N/A

*This model is also available in Stainless Steel (PCW2G-xxxS) or Bronze (PCW2G-xxxB).*

### Material Details

- Aluminum extrusions made from multiple alloys & tempers established to be the most appropriate for the given use of individual parts. Will be one of the following:
  - (6063-T5, T6, T52), (6061-T5, T6, T51), (6105-T5, T6), (6005-T5), (6005A-T5, T61), ASTM B221
  - Sheet – 6061-T6, 3003-H14, 5005-H34, ASTM B209
- Stainless Steel plate available, add the suffix S to the model name (ex: PC-2G-xxxS)
- Stainless Steel insert: Type 304 ASTM A167, A240A, A240M
- Capable of lateral movement

