

Acrovyn[®] Dimensional Moldings

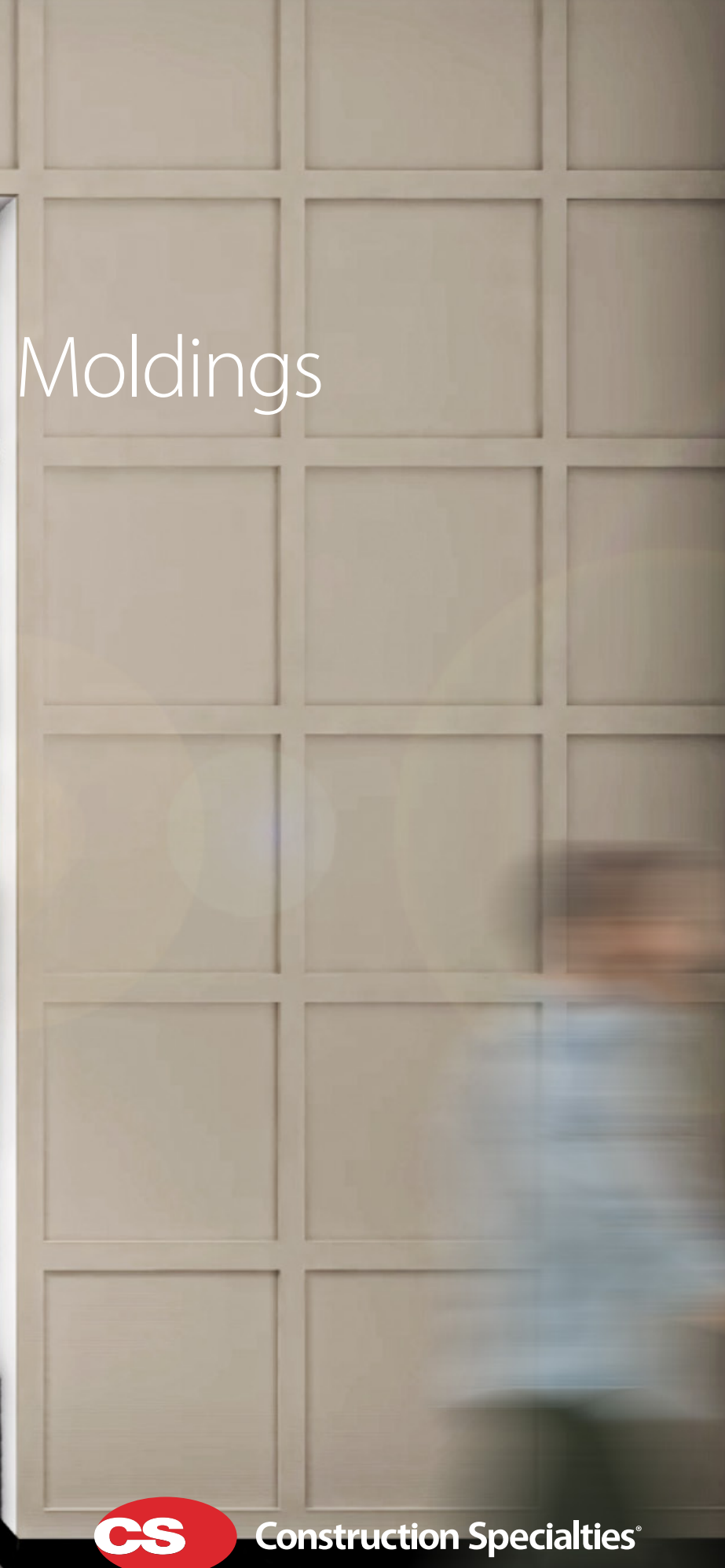

dimensional moldings— *design made easy.*

Our versatile Dimensional Moldings offer you the freedom to design interiors that coordinate with existing aesthetics or stand out as unique spaces—all with the protection and durability of Acrovyn®

INSPIRATION	1
HOW TO SPECIFY	2
BUILD YOUR SYSTEM	3



let our feature rails *inspire you.*

Does your style skew more toward the Traditional-rich in history with common shapes and features or more toward the Contemporary with its sleek, clean, and sharp lines? Or maybe you prefer something in between, a Transitional look featuring a fresh take on traditional details? Wherever you gather your inspiration, our collection of feature rails are the perfect addition to any style.



create any *design style.*

Achieving a millwork style design doesn't have to be complicated. With the Dimensional Moldings system, we make it simple to update a space or create a design statement – all while keeping it protected. Available in a variety of styles, finishes, and sizes, the possibilities are endless to start creating high-end, unique spaces.

- 1 **DETERMINE** lineal footage and height
- 2 **SELECT** & calculate desired wall covering needs
- 3 **CHOOSE** wall base trim height
- 4 **SELECT** feature rail
- 5 **CHOOSE** additional components and widths
- 6 **DETERMINE** inside & outside corner requirements

Watch It Assemble

- Traditional
- Transitional
- Contemporary



pick your parts.

Our Dimensional Moldings system lets you mix and match Acrovyn sheet with components and feature rails to create endless, paneled looks to elevate your space. Available in solid colors and woodgrains, these feature rails and components range in style and size, to help meet the exact specification for your project.

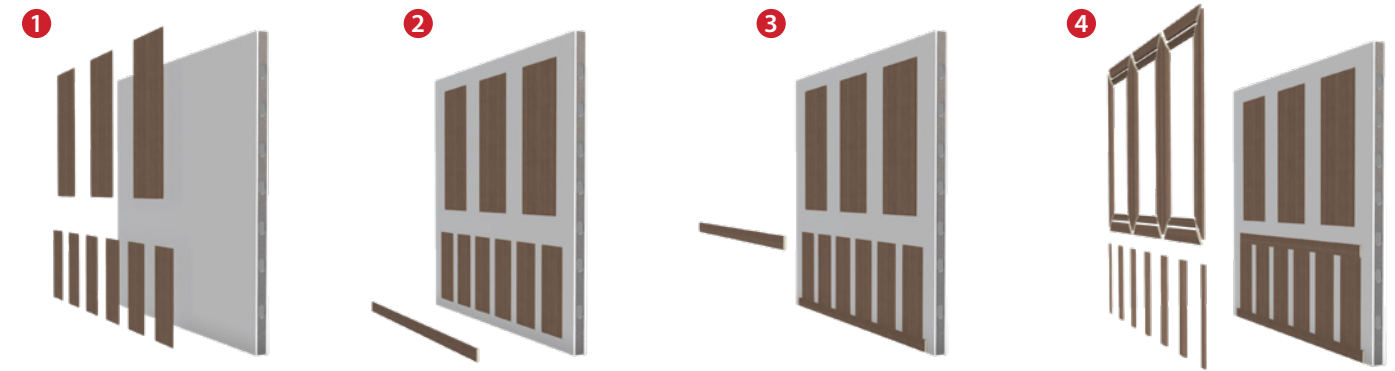

1 Rigid Wall Covering (.040")

Install vertically or horizontally to achieve desired coverage; trim to desired height in field. Sheet options include solid colors, woodgrains, AbD Tapestry, AbD Metallics, and AbD Patterns.

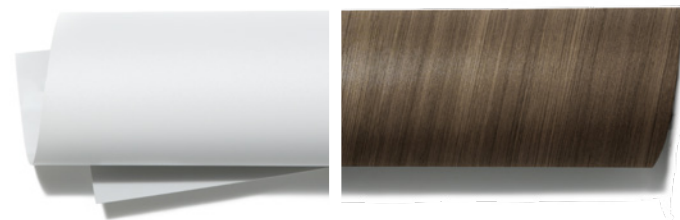

2 Wall Base Trim

Place base trims directly over sheet. Wider trim can be used as topcap for halfwall.



SFR-WB

3 Feature Rails

Miter easily to frame windows, door frames, corners and other features.



● Tudor Rail FR-260



● Neoclassic Rail FR-251



● Colonial Rail FR-252



● Federal Rail FR-253



● Victorian Rail FR-451



● Stepdown Rail FR-254



● Gothic Rail FR-255



● Angle Rail FR-257



● Square Rail FR-259



● Reveal Rail FR-256



● Slab Rail FR-258

- Traditional
- Transitional
- Contemporary

[Feature Rails Product Sheet](#) →

4 Components

Variety of panelized designs are possible by incorporating matching or contrasting vertical or horizontal components.



Handrail Backer Board/Horizontal Trim SFR-HBB



Notched Wainscot Trim SFR-WR

Vertical Trims & Corners

Vertical Trim installs directly over vertical sheet joints. Corners: 3/8" used for wainscot height applications, 5/8" used for full height applications. Coordinate corner thickness with horizontal trims to minimize trim exposure.



Vertical Trim SFR-VT



Inside Corner Trim SFR-IVC

Odd degree Corner Trim SFR-AIC

Min-Max 70°-140°



Outside Corner Trim SFR-OVC

Odd degree Corner Trim SFR-AOC

Min-Max 70°-140°

[Components Product Sheet](#) →



CS creates products that solve complex building challenges around the world:

Acrovyn by Design®

Acrovyn® Doors

Acrovyn® Wall Covering + Panels

Acrovyn® Wall Protection

Specialty Wall Panels

Architectural Grilles + Vision Barriers

Architectural Louvers

Cubicle Curtains + Tracks

Entrance Flooring, Mats + Grids

Anti-fatigue Mats

Expansion Joint Covers

Explosion + Pressure Relief Vents

Sun Controls

3 Werner Way
Lebanon, NJ 08833, U.S.A.
800.233.8493

2240 Argentia Rd., Unit 102
Mississauga, ON L5N 2K7
888.895.8955

www.c-sgroup.com

© 2021 Construction Specialties, Inc.
Construction Specialties, Inc. reserves the right to make design changes or to withdraw any design without notice. Construction Specialties, Inc. holds a patent(s) on one or more of the products listed herein.
For detailed patent information, see www.c-sgroup.com/patents.
Printed in U.S.A. Series 19

