

Project Information

Project:
General Motors Paint Mix

Location:
Oshawa, ON

Architect:
Giffels Associates

Product:
Standard Explosion Relief Panels

Project Overview

This facility is GM's largest and most technically advanced paint mix facility ever constructed. The explosion vent panels clad the entire exterior wall elevations of this building. The laboratory-like operating conditions within the plant demanded that the system negate the possibility of airborne contaminants as well as eliminate the possibility of condensation development in the face of extreme winter conditions.

In order to meet these requirements, C/S adopted "curtain wall" technology in the development of our first ever thermally-broken explosion vent system. Not only did we design this system from scratch but did so in the face of a fast track

construction schedule. Design, development, fabrication and installation had to be complete within an eight week time frame.

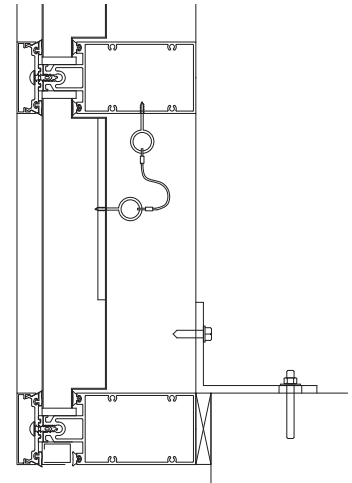

Standard explosion relief panel