

FCF & FCFC 100-200

TECHNICAL DATA:

Aluminum

- Extrusion – CS uses multiple alloys & tempers which are established to be the most appropriate for the given use of individual parts. Will be one of the following: (6063-T5, T6, T52) (6061-T5, T6, T51) (6105-T5, T6) (6005-T5) (6005A-T5, T61), ASTM B221
- Aluminum in contact with concrete/masonry will have a 2 mil heavy metal free high solids primer

Seal

- Dual Durometer 65 Shore A, 90 Shore A, ASTM D2000
- Available in 5 colors.

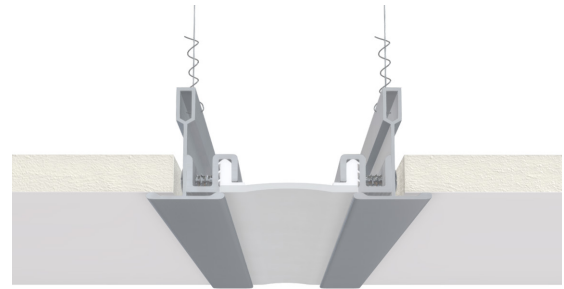

MODEL	JOINT WIDTH	MINIMUM OPENING	MAXIMUM OPENING	EXPOSED SURFACE	BLOCKOUT WIDTH	BLOCKOUT HEIGHT
FCF-100	1.00" (25mm)	0.75" (19mm)	1.25" (32mm)	0.81" (21mm)	N/A	N/A
FCF-200	2.00" (51mm)	1.50" (38mm)	2.50" (64mm)	1.63" (41mm)	N/A	N/A
FCFC-100	1.00" (25mm)	0.75" (19mm)	1.25" (32mm)	1.00" (25mm)	N/A	N/A
FCFC-200	2.00" (51mm)	1.50" (38mm)	2.50" (64mm)	1.75" (44mm)	N/A	N/A

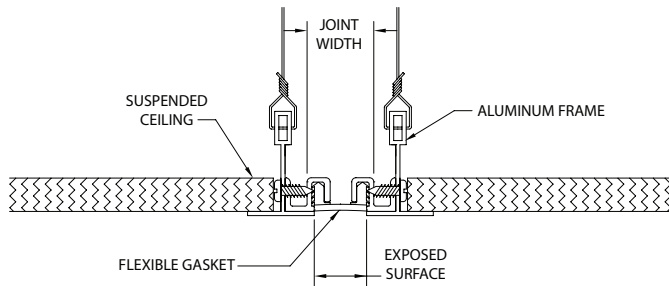

FCF-100

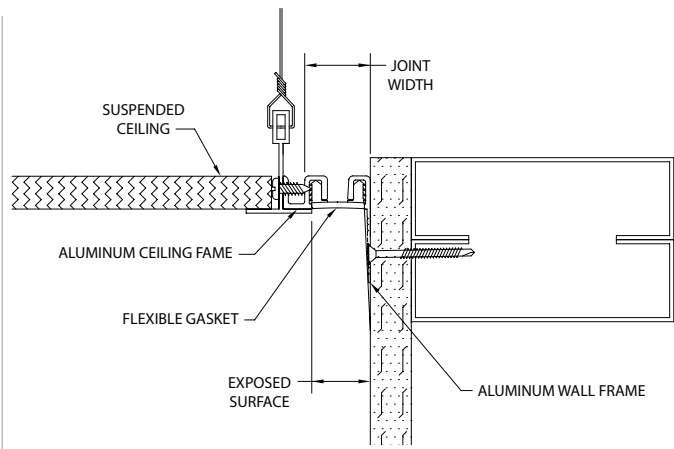

FCFC-100

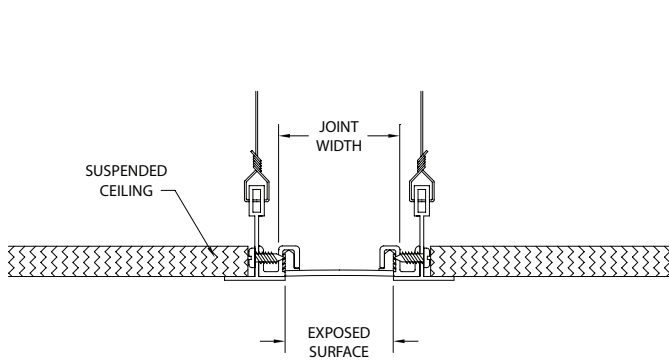

FCF-200

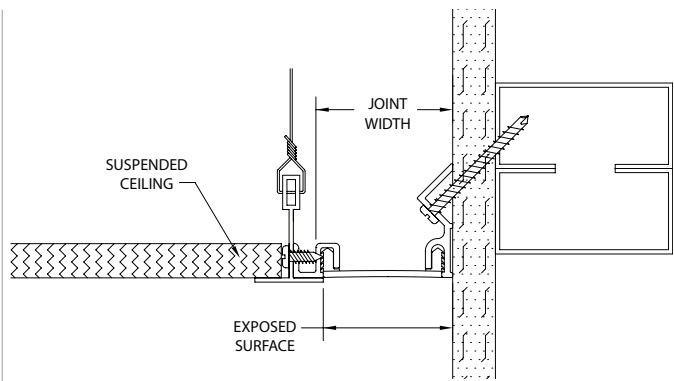

FCFC-200