

# ASM



This surface-mounted metal wall and ceiling cover is designed for interior applications where low maintenance or tamper-resistant applications are desired. The free-floating aluminum center plate spans the joint and slides over the surface of the wall or ceiling to allow movement when required. The cover can be painted to match nearly any finish and is available in multiple metal finishes.

## Product Details

- Joint sizes range from 1" to 4" (25.4mm to 101.6mm)
- 10' (3.048m) stock lengths
- Select sizes are in stock for fast shipping
- Meets ASTM E1399
- Standard Five-Year Warranty



Vapor Barrier

Fire Barrier

## Applications

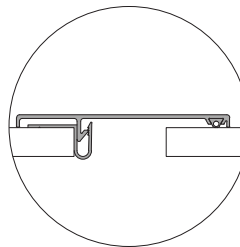

Wall to Wall  
Ceiling to Ceiling

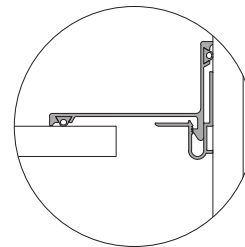

Wall to Wall Corner  
Ceiling to Wall

## Standard Finish



Clear Anodize

Aluminum in contact with concrete/masonry will have a 2 mil, heavy metal free, high solids primer. For custom applications, loading or finishes, contact your Representative.



Additional resources

# ASM - Wall to Wall

[Buy Online](#)



- 1. Floating extruded aluminum center plate
- 2. Continuous aluminum back clip (hidden behind)
- 3. Duroflex gasket
- 4. Fastener

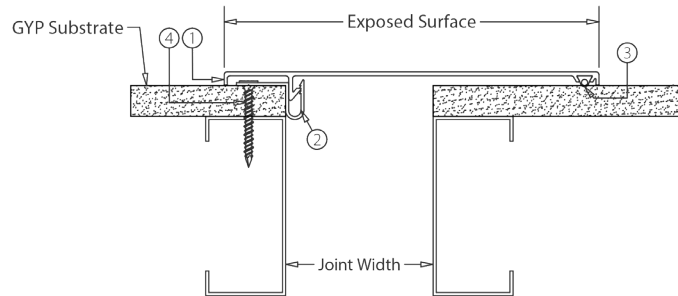

## Wall to Wall - Performance Data

MODEL	JOINT WIDTH	MIN. OPENING	MAX. OPENING	EXPOSED SURFACE	BLOCKOUT WIDTH	BLOCKOUT HEIGHT
ASM-100	1.00" (25mm)	0.38" (10mm)	1.50" (38mm)	3.13" (80mm)	N/A	N/A
ASM-200	2.00" (51mm)	0.38" (10mm)	3.00" (76mm)	4.63" (118mm)	N/A	N/A
ASM-300	3.00" (76mm)	0.38" (10mm)	6.00" (152mm)	7.63" (194mm)	N/A	N/A
ASM-400	4.00" (102mm)	0.38" (10mm)	6.00" (152mm)	7.63" (194mm)	N/A	N/A

*This model is also available in Stainless Steel (ASM-xxxS) or Bronze (ASM-xxxB).*

## ASM - Ceiling to Ceiling

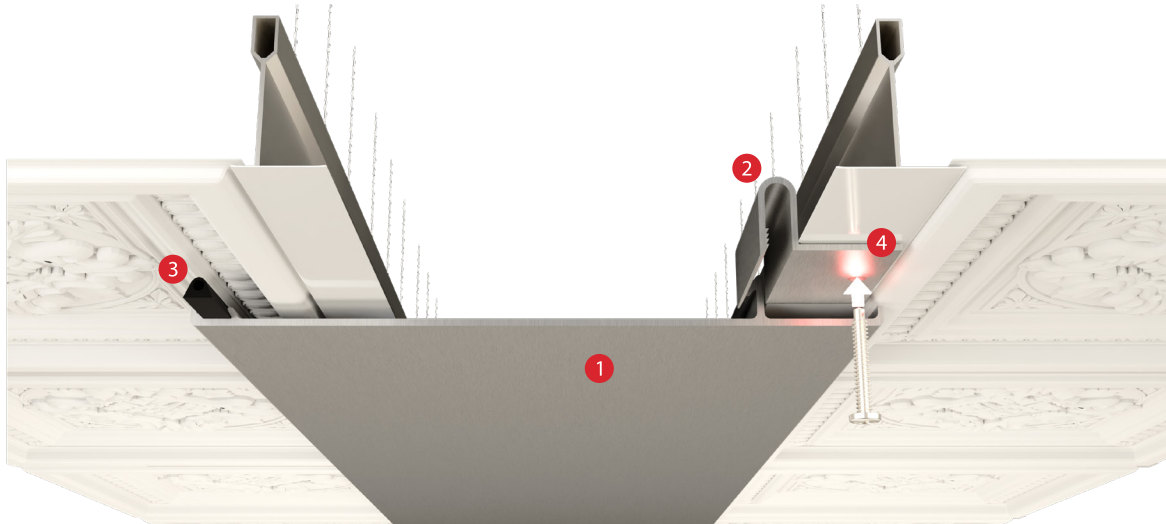

- 1. Floating extruded aluminum center plate
- 2. Continuous aluminum back clip (hidden behind)
- 3. Duroflex gasket
- 4. Fastener

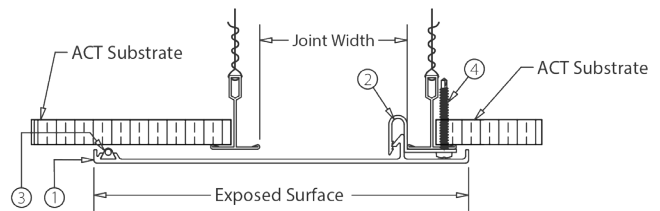

### Ceiling to Ceiling - Performance Data

MODEL	JOINT WIDTH	MIN. OPENING	MAX. OPENING	EXPOSED SURFACE	BLOCKOUT WIDTH	BLOCKOUT HEIGHT
ASM-100	1.00" (25mm)	0.38" (10mm)	1.50" (38mm)	3.13" (80mm)	N/A	N/A
ASM-200	2.00" (51mm)	0.38" (10mm)	3.00" (76mm)	4.63" (118mm)	N/A	N/A
ASM-300	3.00" (76mm)	0.38" (10mm)	6.00" (152mm)	7.63" (194mm)	N/A	N/A
ASM-400	4.00" (102mm)	0.38" (10mm)	6.00" (152mm)	7.63" (194mm)	N/A	N/A

*This model is also available in Stainless Steel (ASM-xxxS) or Bronze (ASM-xxxB).*

## ASMC - Wall to Wall Corner



- 1. Floating extruded aluminum center plate
- 2. Continuous aluminum back clip (hidden behind)
- 3. Duroflex gasket
- 4. Fastener

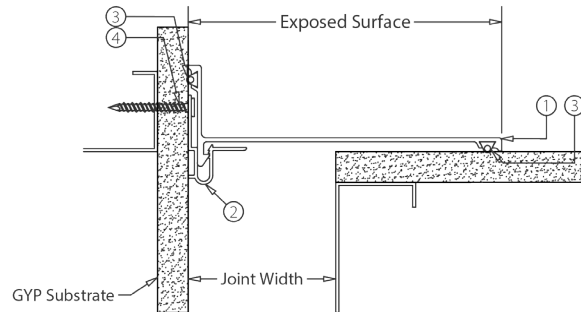

### Wall to Wall Corner - Performance Data

MODEL	JOINT WIDTH	MIN. OPENING	MAX. OPENING	EXPOSED SURFACE	BLOCKOUT WIDTH	BLOCKOUT HEIGHT
ASMC-100	1.00" (25mm)	0.50" (13mm)	1.50" (38mm)	1.88" (48mm)	N/A	N/A
ASMC-200	2.00" (51mm)	0.50" (13mm)	3.00" (76mm)	3.38" (86mm)	N/A	N/A
ASMC-300	3.00" (76mm)	0.50" (13mm)	6.00" (152mm)	6.38" (162mm)	N/A	N/A
ASMC-400	4.00" (102mm)	0.50" (13mm)	6.00" (152mm)	6.38" (162mm)	N/A	N/A

*This model is also available in Stainless Steel (ASMC-xxxS) or Bronze (ASMC-xxxB).*

## ASMC - Ceiling to Wall

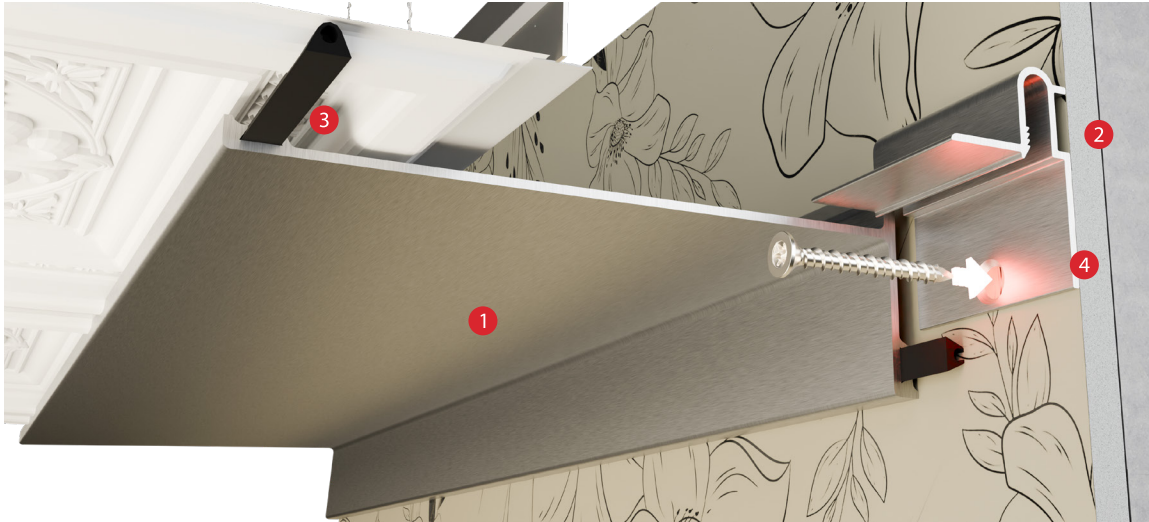

- 1. Floating extruded aluminum center plate
- 2. Continuous aluminum back clip (hidden behind)
- 3. Duroflex gasket
- 4. Fastener

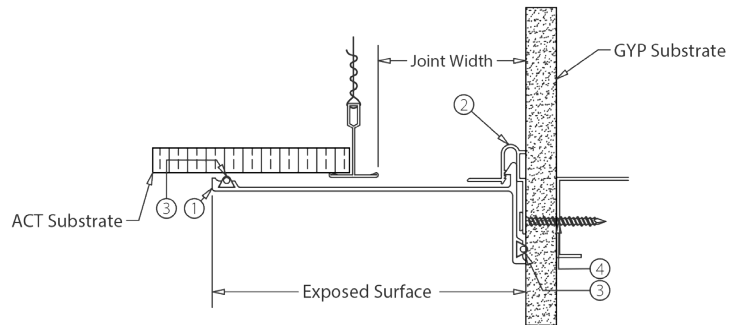

### Ceiling to Wall - Performance Data

MODEL	JOINT WIDTH	MIN. OPENING	MAX. OPENING	EXPOSED SURFACE	BLOCKOUT WIDTH	BLOCKOUT HEIGHT
ASMC-100	1.00" (25mm)	0.50" (13mm)	1.50" (38mm)	1.88" (48mm)	N/A	N/A
ASMC-200	2.00" (51mm)	0.50" (13mm)	3.00" (76mm)	3.38" (86mm)	N/A	N/A
ASMC-300	3.00" (76mm)	0.50" (13mm)	6.00" (152mm)	6.38" (162mm)	N/A	N/A
ASMC-400	4.00" (102mm)	0.50" (13mm)	6.00" (152mm)	6.38" (162mm)	N/A	N/A

*This model is also available in Stainless Steel (ASMC-xxxS) or Bronze (ASMC-xxxB).*

## ASM Series

---

### Material Details

- Aluminum extrusions made from multiple alloys & tempers established to be the most appropriate for the given use of individual parts. Will be one of the following:
  - (6063-T5, T6, T52) (6061-T5, T6, T51) (6105-T5, T6) (6005-T5) (6005A-T5, T61), ASTM B221
- Stainless Steel and Bronze inserts available, add the suffix S or B to the model name (ex: ASM-xxxS or ASMC-xxxB)
- Aluminum Sheet
  - 6061-T6, 3003-H14, 5005-H34, ASTM B209
- Stainless Steel Sheet
  - Type 304 ASTM A167, A240A, A240M
- Bronze Sheet
  - C28000 Muntz Metal ASTM B455
- Single Durometer - 65 Shore A, ASTM D2000