

# MODEL FB17 FIRE BARRIER

## 90° TRANSITION

### INSTALLATION INSTRUCTIONS



## IMPORTANT INFORMATION

Prior to the commencement of Installation, all materials **MUST** be inspected for Damage. Any damage must be reported to CONSTRUCTION SPECIALTIES, INC., as soon as possible, so that replacement materials may be furnished without delay.

All work must be completed as per Architect's Approved "Shop Drawings", and in accordance with these Installation Instructions. When installation is complete, all materials must be protected from damage until the Architect's FINAL INSPECTION.

All materials should be arranged in the order that they are to be installed. All hardware required for each portion of the work should be placed with the appropriate materials.

Please review all Approved Shop Drawings and this Document to familiarize yourself with all the details and components of this assembly.

**IMPORTANT:**  
**READ THROUGH ALL INSTRUCTIONS PRIOR TO STARTING INSTALLATION**

11/01/2018



**Construction Specialties®**  
[www.c-sgroup.com](http://www.c-sgroup.com)

Doc#: 11-12JR 6696 Route 405 Highway, Muncy, PA 17756  
 Phone: (800) 233-8493 / Fax: (570) 546-8022

Issue Date: 07/06/18

This document is the property of Construction Specialties, Inc. and contains PROPRIETARY INFORMATION that is not to be disclosed to third parties and is not to be used without approval in writing from Construction Specialties, Inc.

© Copyright 2016 Construction Specialties, Inc.

Rev Date: 11/01/18



# STEP 1

## FLOOR FIRE BARRIER SEGMENT

Note: The following instructions are to be used to creating a 90° floor to wall transition from two fire barrier segments.



(Fig. 1A)

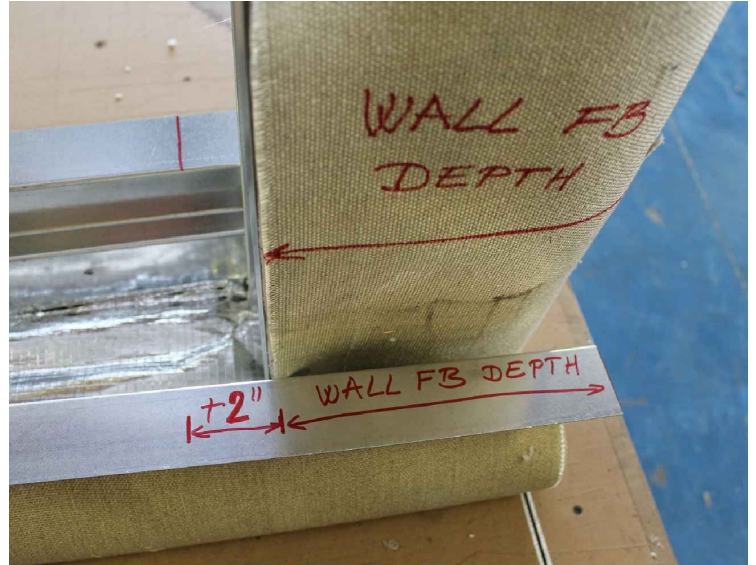

(Fig. 1B)



(Fig. 1C)

1.1) Using the wall fire barrier section, fold in half and find the wall depth dimension. Measure in, from the cut end of the floor fire barrier, mark the wall depth dimension plus another 2" on the floor retainers. (Fig. 1A - 1B)

1.2) Using a grinder cut off the floor Galvanized Retainers along the marked cutting lines. (Fig. 1C)

# STEP 1 Con't

## FLOOR FIRE BARRIER SEGMENT

Note: The fasteners should be snug tight to the fire barrier, just enough that the fire barrier is in firm contact with the substrate. Fire Barrier installed without a cover plate, drill the Surface Mounted Galvanized Retainer starting 3" in from the end and 18" O.C. for the supplied fasteners.

### 1.3) Retainer Fasteners Locations:

\*Note: Surface Mounted Galvanized Retainers are not pre-drilled. If with Surface Mounted Retainers and using the joint cover to anchor the fire barrier retainer in place - measure and mark the frame fastener centerline locations on the Surface Mounted Retainer flange and drill out prior to installing. To hold the fire barrier temporarily install fasteners as necessary. (Fig. 1D-1E)

Low Profile Galvanized Retainers - Using the retainer as a template drill the holes for the supplied fasteners with maximum spacing of 18" O.C. With the fire barrier held in place install the supplied fasteners per the manufacturer's guidelines.

### 1.4) Fold the floor fire barrier segment into to a "U" shape and lower into the joint. Seat the fire barrier so that the surface mounted galvanized retainers rest on the surface of the slabs and butt against the vertical wall substrate. (Fig. 1F-1G) Secure in place with adjustable clamps and attach with supplied fasteners.



(Fig. 1D)



(Fig. 1E)



(Fig. 1F)



(Fig. 1G)

# STEP 2

## WALL FIRE BARRIER SEGMENT

- 2.1) To find the Floor Drape Depth measure the height from the drape to the retainer edge (Fig. 2A). Lay the Wall Fire Barrier length on a flat surface, from the cut end, measure in and mark the floor drape depth on the retainers.(Fig. 2B)



(Fig. 2A)



(Fig. 2B)

- 2.2) Using a grinder cut off the wall Galvanized Retainers along the marked cutting lines. (Fig. 2C)
- 2.3) Remove weld pins located within the Floor Drape Depth measurement in the fabric and under the first fire barrier blanket areas. (Fig. 2D-2E)



(Fig. 2C)

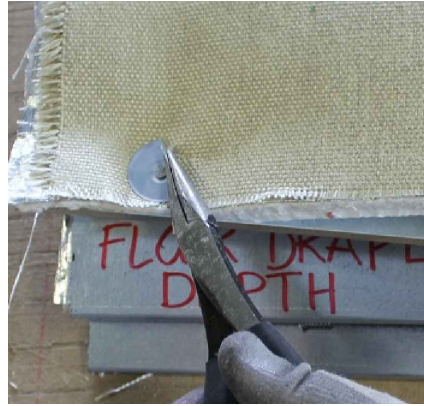

(Fig. 2D)



(Fig. 2E)

- 2.4) Locate the FB17 6" wide Wall Strips, typically supplied in 10' lengths. You may need to splice sections of Wall Strip together to accommodate the full height, simply butt the Wall Strips tightly together. 6" Wall Strips typically run floor to slab above both sides of the wall joint opening.
- 2.5) Beginning at the top of the wall, align the one vertical edge of the Wall Strip with one face of the wall. Tape or staple the Wall Strip to temporarily hold in place, maintaining alignment with the joint face as you work towards the floor. Repeat for the opposite side. (Fig. 2F-2G)



Doc#: 11-12JR

(Fig. 2F)

Issue Date: 07/06/18



Rev Date: 11/01/18

(Fig. 2G)

# STEP 2 Con't

## WALL FIRE BARRIER SEGMENT

2.6) Fold the Wall Fire Barrier length into a "U" shape with the cut galvanized retainer facing down into the joint. Install the Wall Fire Barrier length so that the galvanized retainers butt against the Floor Fire Barrier retainers.

Note: See wall fire barrier installation instructions for the preparatory fastener installations for Surface Mounted and Low Profile retainers.

### 2.7) SURFACE MOUNTED FIRE BARRIER RETAINERS:

Install the wall fire barrier surface galvanized retainers so that they rest on the surface of the wall substrate material. While holding the Fire Barrier tightly against the installed wall strips and face of the wall joint, install the supplied fasteners per the manufacture's guidelines.

### LOW PROFILE FIRE BARRIER RETAINERS:

Install the wall low profile galvanized retainers along each joint edge. While holding the fire barrier tightly against the installed wall strips install the supplied fasteners per the manufacturer's guidelines.



(Fig. 2H)

# STEP 3

## FLOOR HEAT SHIELD INSTALLATION

Note: The Floor Heat Shield has been supplied in 50' lengths.

- 3.1) Place a length of Floor Top Heat Shield over the joint and unroll over the length of the fire barrier.
- 3.2) To create a notch on both sides of the Floor Top Heat Shield measure and mark 12" back from the end of the Floor Top Heat Shield, measure approximately 1 1/2" in from the mark, and draw a line at a 45° angle back to the edge of the Top Heat Shield. Using a utility knife cut out the triangle creating the notch. (Fig. 3A-3C)



(Fig. 3A)

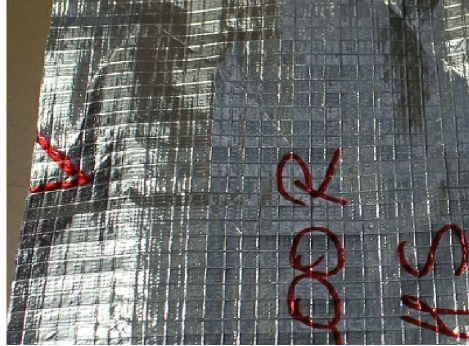

(Fig. 3B)



(Fig. 3C)

- 3.3) Fold and place the notched area of the Floor Top Heat Shield at the transition to the wall joint. Fold the Floor Top Heat Shield into a "U" shape installing into the joint along the edge of the floor galvanized retainers. Fasten in place using the supplied fasteners and washers at 12" O.C. (Fig. 3D-3E)



(Fig. 3D)



(Fig. 3E)

# STEP 4

## WALL HEAT SHIELD INSTALLATION

Note: The Wall Heat Shield has been supplied in 50' lengths, the material is a 1/2" thick on fire barrier max. open sizes of 9"-18" and 1" thick on fire barrier max. open sizes of 20"-30".

- 4.1) Unroll a the length of Wall Top Heat Shield over the joint and place over the wall fire barrier. Align the end with the floor top heat shield galvanized retainers. The Wall Heat Shield will overlap the turned up portion of the floor heat shield. (Fig 4A)
- 4.2) Place one edge of the Wall Heat Shield along the top edge of the wall galvanized retainer. Use a few pieces of tape to temporarily hold in place.
- 4.3) Place a length of galvanized attachment angle along the top edge of the wall galvanized retainer. Attach both the Wall Top Heat Shield and the attachment angle with the supplied fasteners in the predrilled 9" O.C. holes. (Fig. 4A)
- 4.4) Repeat installation for the opposite side of the Wall Heat Shield and attachment angle along the top edge of the galvanized retainer. Tuck the heat shield material into the joint space creating a "U" drape. (Fig. 4B)



(Fig. 4A)



(Fig. 4B)



# STEP 4 Con't

## WALL HEAT SHIELD INSTALLATION

\* Note: Finished 90° Up Transition pictures below (Fig. 4C-4E) and top view showing the mating of horizontal and vertical fire barrier lengths from inside the joint (Fig. 4F).



(Fig. 4C)



(Fig. 4D)



(Fig. 4E)



(Fig. 4F)