

INSTALLATION INSTRUCTIONS

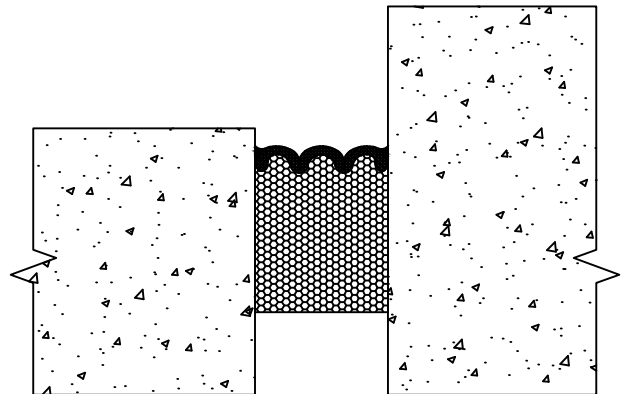
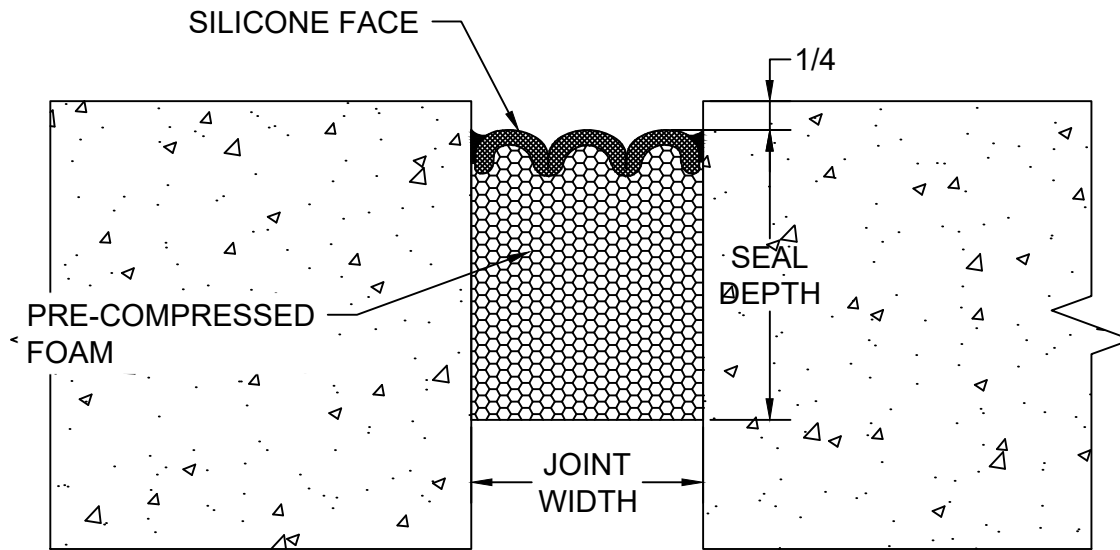

IMPORTANT INFORMATION

Prior to the commencement of Installation, all materials MUST be inspected for Damage. Any damage must be reported to CONSTRUCTION SPECIALTIES, INC., as soon as possible, so that replacement materials may be furnished without delay.

All work must be completed as per Architect's Approved "Shop Drawings", and in accordance with these Installation Instructions. When installation is complete, all materials must be protected from damage until the Architect's FINAL INSPECTION.

All materials should be arranged in the order that they are to be installed. All hardware required for each portion of the work should be placed with the appropriate materials.

Please review all Approved Shop Drawings and this Document to familiarize yourself with all the details and components of this assembly.

IMPORTANT:

READ THROUGH ALL INSTRUCTIONS PRIOR TO STARTING INSTALLATION

8/5/19



Construction Specialties™

6696 Route 405 Highway, Muncy PA 17756
(800) 233-8493 • Fax (570) 546-5169 • www.c-sgroup.com

This document is the property of Construction Specialties, Inc. and contains CONFIDENTIAL PROPRIETARY INFORMATION that is not to be disclosed to third parties and is not to be used without approval in writing from Construction Specialties, Inc.

GENERAL NOTES:

Before beginning installation, review the architectural drawings and approved Construction Specialties Inc. shop drawings to familiarize yourself with the joint cover models and locations.

Check all of the joint cover components to confirm that the correct joint cover model and size have been received. Also, check for materials that may have been damaged during shipping. Report all incorrect and/or damaged components to CS at 800-233-8493.

Read through all the steps of these instructions prior to beginning work.

TOOLS:

The following tools may be needed for installation of the VF:

- Serrated Edge Knife - Measuring Tape - Miter Saw - Utility Knife - Caulking Gun / Knives - Spray Bottle
- Clean Paint Buckets - Acetone, Lint Free Rags

Material Storage and Installation:

- 1.) **Cold Days** - Store sealant, off the floor, inside at above 68°F (20°C). Best to store at room temperature.
- 2.) **Very Hot Days** - **Keep sealant out of direct sun when temperatures greater than 60°F (15°C) until immediately prior to installation into joint. Expansion is quicker when warm, slower when cold.**

Pre-Installation:

- 1.) Ensure joint faces are parallel and have sufficient depth to receive the full depth of the size(s) of VF being installed plus at least $\frac{1}{4}$ " for the application of corner beads.
- 2.) Repair spalled, irregular or unsound joint surfaces using accepted industry practices for repair of the substrates in question. Remove protruding roughness to ensure joint sides are smooth.
- 3.) Remove all residues of old sealants. Wire brush or angle grind, if necessary, to clean sides.
- 4.) Wipe joint faces with lint free rags dipped in solvent or other agent suitable for use on the substrates in question to ensure joint sides are free of dust, previous sealant, oils, grease, etc.
- 5.) Ensure joint sides are dry of solvent or cleaning agent prior to installation.
- 6.) Use miter saw to make any cuts to the VF before removing the clear shrink packing. Use a serrated knife to make any cuts after the clear shrink packing and hardboards have been removed. All starting and ending pieces must be square to the termination point.

Material Packaging:

- 1.) Material has been manufactured as straight sticks. joint widths for material supplied are marked on the packing. Actual material width measured between hardboard will be slightly less than indicated joint width. **DO NOT REMOVE OUTER PLASTIC PACKING UNTIL YOU READ AND UNDERSTAND THE REST OF THESE INSTRUCTION.**
- 2.) Proper performance of expansion seals necessitate proper installation from beginning through completion. Improper handling will cause product to expand prematurely.
- 3.) Sticks are held under compression by hardboard and plastic wrapping. When ready to install, slit the plastic wrapping by cutting on the hardboard, discard hardboard and inner release liner. **DO NOT CUT ALONG SILICONE COATING FACE.**
- 4.) For packaging and production reasons, the silicone facing is coated with a release agent. Prior to installation, this agent must be wiped off using a solvent in order for the fillet beads described in Step 10 to adhere to the silicone facing. Lightly, quickly and thoroughly wipe the cured silicone facing with a lint free rag made damp with acetone or other solvent to remove the release agent.

STEP 1

PREPARE SEAL

- 1.1 Measure and cut the VF sticks to the appropriate length. All starting and ending pieces must be square to the termination point.
- 1.2 When ready to install the VF, remove the shrink-wrap packaging by cutting on the hardboard and discard. DO NOT CUT ALONG THE SILICONE COATING FACE.
- 1.3) Wipe factory applied release agent off silicone facing using a clean Acetone solvent or other solvent damp lint free cloth. Thoroughly wipe the cured silicone facing.

STEP 2

APPLYING SEALANT

- 2.1 Apply a thin bead of Silicone Sealant along silicone facing edge only at end(s) where the material will join with next length.

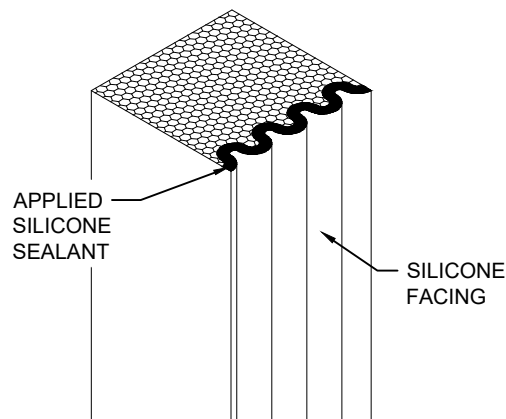

STEP 3

INSTALLATION OF SEAL

- 3.1 Peel off the adhesive release paper to expose mounting adhesive on one face of VF material.
- 3.2) Starting at the bottom of the joint, insert VF material with a 1/4" minimum recess from wall surface. Always push the VF material (do not pull it) to prevent stretching it.
- 3.3) Using a stiff bladed putty knife press the adhesive side of the material firmly against the substrate so that it will hold in place while it expands. If the material binds, lightly spray the putty knife and /or self adhesive with water from a spray bottle to help it slide into the joint gap. *Note: if necessary use small 3" pieces of used hardboard packing as wedges to hold sections in place while the VF expands.
- 3.4) Corner Beads are required with VF. The VF seal needs to expand fully against both sides of the joint and any water spray used is dried before the corner bead installation. Apply a caulking bead where the VF sealant facing meets the substrate. Tool the corner bead firmly against the substrate and silicone facing.

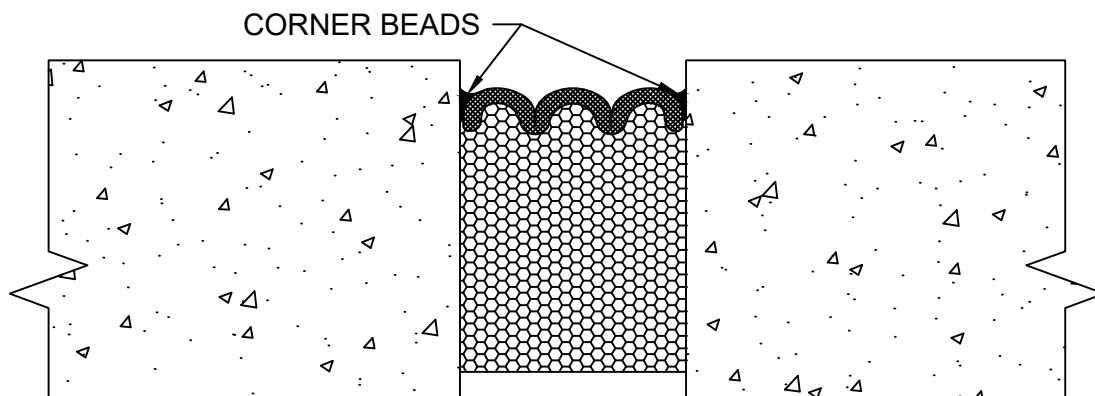

STEP 4

SPLICES

- 4.1) At the splicing end of the installed VF allow the end to protrude up and out from the joint.
- 4.2) Place end of the next VF length against end of the first piece. Leaving the splicing end of the second length to protrude out from the joint. Install into the joint space the remaining second VF length.
- 4.3) Push the protruding two VF lengths into the joint space.
- 4.4) Blend silicone sealant applied in step 2 to silicone facing.

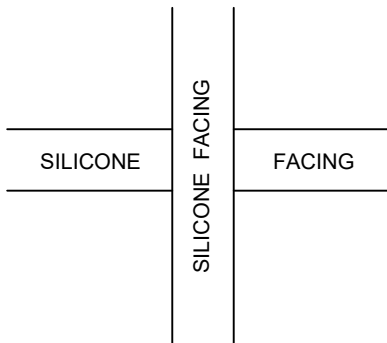
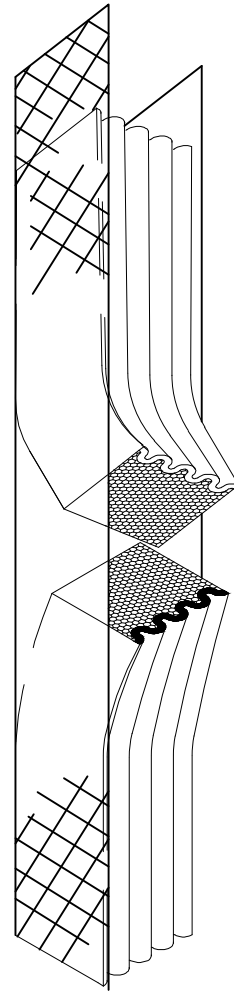

Cross Transition (Elevation)

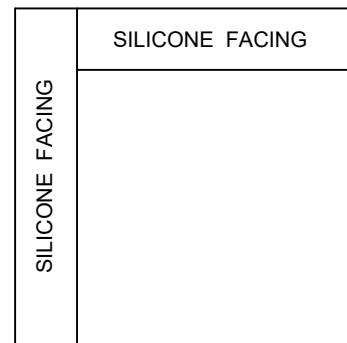

Corner Transition (Elevation)

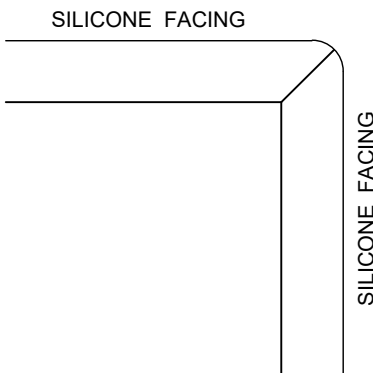

Outside Corner Transition (Section)

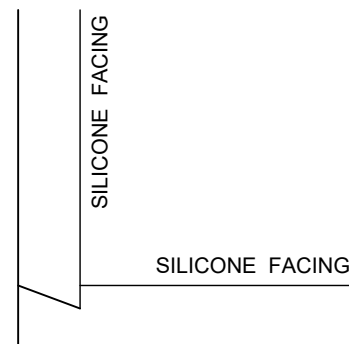

Inside Corner Transition (Section)