

RUBSTRIPS

PLEASE READ

PLEASE READ THESE INSTRUCTIONS THOROUGHLY PRIOR TO BEGINNING THE RUBSTRIP INSTALLATION.

THIS INSTRUCTIONS SHEET IS INTENDED TO PROVIDE A SPECIFIC GUIDE TO FOLLOW FOR THE INSTALLATION OF RUBSTRIPS. CONTAINED WITHIN IS THE TECHNICAL INFORMATION AND INSTALLATION TECHNIQUES REQUIRED TO COMPLETE AN EFFICIENT, NEAT AND LONG-LASTING INSTALLATION.

INSPECT ALL MATERIALS FOR DAMAGE OR MISSING PARTS. IF YOU DISCOVER DAMAGED OR MISSING MATERIALS, IN THE USA PLEASE NOTIFY THE FACTORY AT (800) 233-8493, AND IN CANADA (888) 895-8955 FOR CUSTOMER SERVICE.

RUBSTRIPS MUST BE INSTALLED IN ACCORDANCE WITH THESE INSTRUCTIONS! FAILURE TO FOLLOW THESE INSTRUCTIONS MAY VOID ANY PRODUCT WARRANTIES AND RESULT IN AN UNSUCCESSFUL INSTALLATION.

FOR SPECIFIC QUESTIONS REGARDING THE INSTALLATION OF RUBSTRIPS PLEASE CALL THE FACTORY IN THE USA AT (800) 233-8493 OR EMAIL IWPTECHSUPPORT@C-SGROUP.COM. IN CANADA CALL (888) 895-8955.

IMPORTANT NOTES

1. MATERIALS MUST REACH 65°F MIN. TO 75°F MAX. 24 HOURS PRIOR TO INSTALLATION. THIS IS ESSENTIAL TO MINIMIZE EXPANSION AND CONTRACTION OF MATERIAL.
2. IT IS RECOMMENDED THAT CLEAN-UP BE DONE AS THE INSTALLATION PROGRESSES, ESPECIALLY WHEN USING ACROVYN INTERIORS HEAVY DUTY WATER BASED MASTIC ADHESIVE AND FASTBOND 30.
3. FOR MORE INFORMATION ON RUBSTRIPS SEE OUR WEBSITE AT www.c-sgroup.com

SECTION VIEWS

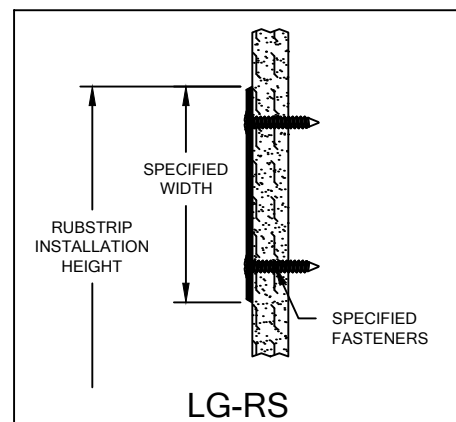
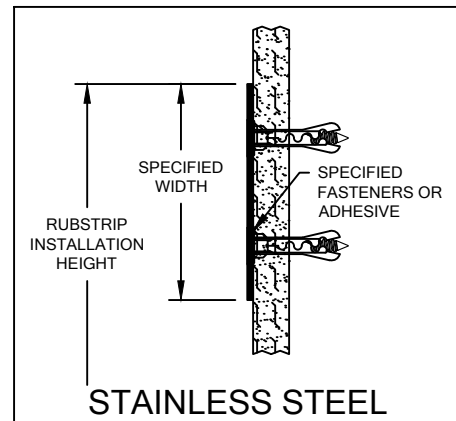
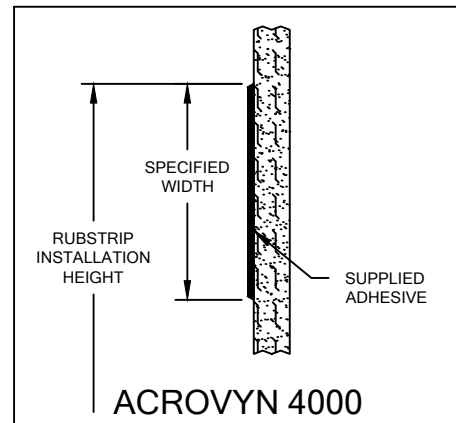

RUBSTRIPS

ACROVYN RUBSTRIPS

TOOLS & EQUIPMENT

SUPPLIED BY CONTRACTOR

CHALK LINE
 6'-0" LEVEL (OR LARGER)
 STRAIGHT EDGE
 DROP CLOTH
 MASKING TAPE
 UTILITY KNIFE
 PAINT TRAY & ROLLER

WATER BUCKET
 MILD DETERGENT
 CAULK GUN
 ELECTRIC SHEARS
 SPIRAL SAW
 HEATER OR HOT AIR GUN

SUPPLIED BY CONSTRUCTION SPECIALTIES

1/8" V-NOTCH TROWEL
 ACROVYN INTERIORS HEAVY DUTY WATER BASED MASTIC ADHESIVE (IF REQUIRED, SEE TABLE BELOW.)

OPTIONAL KIT IF PURCHASED SEPERATELY

CRAIN #333 EXTENSION ROLLER (95W010000) SCISSORS
 PUTTY KNIFE UTILITY KNIFE COMPASS SPONGE PAD

ALL ACROVYN SHEET CUTS CAN BE PERFORMED BY USING ELECTRIC SHEARS, A SPIRAL SAW OR A UTILITY KNIFE. SEVERAL CUTS WILL BE REQUIRED TO CUT COMPLETELY THROUGH IF UTILIZING A UTILITY KNIFE.

WALL CONDITION	SPECIFIED FASTENER	QUANTITY	CS PART NUMBER
SMOOTH FINISHES (PAINTED DRYWALL OR PLASTER, METAL, ETC.)	STRIPPABLE, PRESSURE SENSITIVE ADHESIVE	N/A	90M170002
ROUGH FINISHES (CONCRETE BLOCK, PRECAST CONCRETE, CERAMIC TILE, ETC.)	ACROVYN INTERIORS HEAVY DUTY WATER BASED MASTIC ADHESIVE (COVERAGE: 100 SQ. FT/GAL)	5 GALLON 1 GALLON	90M107001 90M108001
**NOTE: FOR JOBS WITH BOTH SMOOTH AND ROUGH FINISHES, MASTIC ADHESIVE SHOULD BE USED THROUGHOUT			

WALL PREPARATION

ALL WALL SURFACES MUST BE CLEAN, SMOOTH, DRY AND FREE OF OIL AND ANY LOOSE PAINT OR ANY OTHER IRREGULARITIES WHICH WOULD PREVENT GOOD ADHESION.

WHERE THE RUBSTRIP IS TO BE APPLIED OVER PAINTED SURFACES, THE SURFACE SHOULD BE LIGHTLY SANDED, THEN THOROUGHLY WIPED DOWN, (DUST FREE) TO IMPROVE ADHESIVE GRIP.

IN THE CASE OF BLOCK OR CERAMIC TILE, EXCESS MORTAR MUST BE REMOVED USING A MASONS STONE (OR OTHER ADHESIVE TOOL) PRIOR TO PROCEEDING WITH THE INSTALLATION.

OPTIONAL INSIDE/OUTSIDE CORNER NOTES

1. OUTSIDE CORNERS CAN BE FIELD FORMED* USING EITHER A HEATER OR A HOT AIR GUN; HOWEVER, CARE MUST BE TAKEN SO THAT THE HEAT IS NOT SO INTENSE THAT IT ERASES THE TEXTURE AND DISTORTS THE STRIP. IF YOU HAVE NEVER FORMED RUBSTRIPS USING HEAT, IT IS RECOMMENDED TO PRACTICE ON SOME SCRAP PIECES BEFORE ATTEMPTING IT ON A GOOD PIECE.
2. ADHESIVE SHOULD NOT BE APPLIED PRIOR TO FORMING THE OUTSIDE CORNER.
3. WHEN FORMING A CORNER, CONCENTRATE THE HEAT IN THE AREA WHERE THE OUTSIDE CORNER OCCURS. ONCE THE STRIP BECOMES SOFT AND PLIABLE, YOU MAY START FORMING IT TO THE CONFIGURATION OF THE CORNER BY HAND. AFTER YOU HAVE FORMED THE CORNER YOU MAY THEN APPLY THE ADHESIVE OR REMOVE THE STRIPPABLE BACKING.

*PREFORMED OUTSIDE AND INSIDE CORNERS ARE AVAILABLE FROM THE FACTORY IN ACROVYN ONLY. PLEASE CALL (800) 233-8493 OR (888) 895-8955 IN CANADA FOR PRICING AND AVAILABILITY.

INSTALLATION

1. PREPARE THE AREA OF THE WALL TO RECEIVE THE RUBSTRIP AS DESCRIBED ABOVE UNDER WALL PREPARATION.
2. ESTABLISH THE RUBSTRIP HEIGHT AS PER THE ARCHITECTURAL DRAWINGS, WHEN AVAILABLE. USING A CHALK LINE, MAKE A LEVEL LINE TO BE USED AS A GUIDE FOR ALIGNING THE RUBSTRIP TOP OR BOTTOM.
3. MEASURE THE AREA TO RECEIVE THE RUBSTRIP AND CUT TO SIZE PRIOR TO INSTALLING THE STRIP.

NOTE: DUE TO THERMAL EXPANSION AND CONTRACTION IN THE MATERIAL, A MINIMUM 1/32" GAP AT BUTT JOINTS MUST BE MAINTAINED THROUGHOUT THE INSTALLATION.

4. INSTALL RUBSTRIPS TO WALL:
 - A. STRIPPABLE PRESSURE SENSITIVE ADHESIVE APPLICATIONS
 - BEGINNING AT ONE END, PARTIALLY REMOVE THE ADHESIVE BACKING AND START APPLYING THE STRIP. CONTINUE TO REMOVE THE BACKING AND PROGRESSIVELY APPLY THE STRIP TO THE WALL.
 - B. ACROVYN INTERIORS HEAVY DUTY WATER BASED MASTIC ADHESIVE APPLICATION
 - USE THE NOTCHED TROWEL TO APPLY ACROVYN INTERIORS HEAVY DUTY WATER BASED MASTIC ADHESIVE TO AN AREA OF THE WALL SURFACE THAT CAN BE COMPLETED WITHIN THE CURE TIME OF THE ADHESIVE. MAKE SURE THE ENTIRE AREA RECEIVES AN EVEN COAT. DO NOT ALLOW THE ADHESIVE TO OVER CURE. WHEN APPLYING THE ADHESIVE, MAINTAIN A MINIMUM 1/8" TO A MAXIMUM 1/4" CLEARANCE AT THE TOP AND BOTTOM OF THE STRIP. UNDER IDEAL CONDITIONS, THE PROPER CURE TIME OF THE ADHESIVE SHOULD BE APPROXIMATELY 30 MINUTES. WHEN APPLIED, THE ADHESIVE IS WHITE AND CREAMY, AS IT CURES THE ADHESIVE WILL BECOME TRANSLUCENT AND TACKY.
 - STARTING AT ONE END OF THE RUN, BEGIN INSTALLING THE RUBSTRIP, ALIGNING EITHER THE TOP OR BOTTOM WITH THE CHALK LINE.
5. USING THE NO. 333 CRAIN ROLLER, ROLL THE PREVIOUSLY INSTALLED STRIP.
6. THOROUGHLY CLEAN THE RUBSTRIPS UPON COMPLETION OF THE INSTALLATION.

RUBSTRIPS

STAINLESS STEEL RUBSTRIPS

TOOLS & EQUIPMENT

SUPPLIED BY CONTRACTOR

STRAIGHT EDGE CHALK LINE
TAPE MEASURE

FOR HARDWARE INSTALLATION

1/4" DRILL BIT 1/8" DRILL BIT

FOR ADHESIVE INSTALLATION

PAINT TRAY & ROLLER

SUPPLIED BY CONSTRUCTION SPECIALTIES

FASTBOND 30 ADHESIVE (IF REQUIRED FOR ADHESIVE INSTALLATION, SEE TABLE BELOW)

OR

#10 X 1-1/2" S/S PHILLIPS FLAT HEAD WOOD SCREW AND AF-8 PLASTIC ANCHORS (IF REQUIRED FOR HARDWARE INSTALLATION, SEE TABLE BELOW)

OPTIONAL KIT IF PURCHASED SEPERATELY

CRAIN #333 EXTENSION ROLLER (95W010000)

WALL CONDITION	SPECIFIED FASTENER	DRILL DIAMETERS		CS PART NUMBER
		WALL	RETAINER	
FOR HARDWARE INSTALLATION				
STEEL STUD/ GYPSUM WALL WOOD STUD/GYPSUM WALL CONCRETE/CONCRETE BLOCK	#10 X 1 1/2" S/S PHILLIPS FLAT HEAD WOOD SCREW AF-8 PLASTIC ANCHORS	1/4"	N/A	90H009002 90H049004
FOR ADHESIVE INSTALLATION				
WALL CONDITION	SPECIFIED ADHESIVE	QUANTITY		CS PART NUMBER
GYPSUM WALL	FASTBOND 30 ADHESIVE	5 GALLON 1 GALLON 1 QUART		90M016001 90M014001 90M015001

RUBSTRIP PREPARATION

1. PREPARE THE AREA OF THE WALL TO RECEIVE THE RUBSTRIP AS DESCRIBED BELOW UNDER WALL PREPARATION.
2. ESTABLISH THE RUBSTRIP HEIGHT AS PER THE ARCHITECTURAL DRAWINGS, WHEN AVAILABLE. USING A CHALK LINE, MAKE A LEVEL LINE TO BE USED AS A GUIDE FOR ALIGNING THE RUBSTRIP TOP OR BOTTOM.
3. STAINLESS STEEL RUBSTRIPS ARE SUPPLIED IN STOCK LENGTHS THAT NEED TO BE CUT IN FIELD TO FIT WALL. LAYOUT RUBSTRIPS FOR DRY FIT PRIOR TO INSTALLING.

WALL PREPARATION

HARDWARE INSTALLATION:

PLACE RUBSTRIP ON THE WALL AND MARK THE WALL FOR THE FASTENER LOCATIONS. PRE-DRILL THE WALL FOR THE SPECIFIED WALL FASTENER. SEE CHART ABOVE

NOTE: AT KNOWN STUD LOCATIONS, PRE-DRILL THE WALL AND STUD WITH 1/8" DRILL BIT AND USE ONLY THE S/S FASTENER TO ANCHOR THE RUBSTRIP TO THE WALL.

ONCE THE FASTENER LOCATIONS HAVE BEEN PRE-DRILLED, PLACE ONE OF THE AF-8 PLASTIC ANCHORS IN EACH OF THE HOLES.

ADHESIVE INSTALLATION:

ALL WALL SURFACES MUST BE CLEAN, SMOOTH, DRY AND FREE OF OIL AND ANY LOOSE PAINT OR ANY OTHER IRREGULARITIES WHICH WOULD PREVENT GOOD ADHESION.

WHERE THE RUBSTRIP IS TO BE APPLIED OVER PAINTED SURFACES, THE SURFACE SHOULD BE LIGHTLY SANDED, THEN THOROUGHLY WIPED DOWN, (DUST FREE) TO IMPROVE ADHESIVE GRIP.

IN THE CASE OF BLOCK OR CERAMIC TILE, EXCESS MORTAR MUST BE REMOVED USING A MASONS STONE (OR OTHER ADHESIVE TOOL) PRIOR TO PROCEEDING WITH THE INSTALLATION.

INSTALLATION

HARDWARE INSTALLATION:

1. STARTING IN A CORNER, BEGIN INSERTING THE SPECIFIED FASTENERS THROUGH THE HOLES IN THE STAINLESS STEEL RUBSTRIP AND INTO THE AF-8 PLASTIC ANCHORS IN THE WALL.
2. REMOVE THE PROTECTIVE FILM FROM THE RUBSTRIP. THOROUGHLY CLEAN THE RUBSTRIP UPON COMPLETION OF THE INSTALLATION.

NOTE: BE CAREFUL NOT TO OVER TORQUE THE SCREWS IN THE PLASTIC ANCHORS

ADHESIVE INSTALLATION:

1. APPLY THE FASTBOND 30 TO THE WALL AND THE STAINLESS STEEL RUBSTRIP, IN ACCORDANCE WITH THE ADHESIVE INSTRUCTIONS.
2. ONCE THE FASTBOND 30 HAS DRIED, POSITION THE RUBSTRIP ON THE WALL USING THE MASKING TAPE AS A GUIDE. PRESSURE ROLL THE MATERIALS TO SET THE FASTBOND 30.
3. REMOVE THE PROTECTIVE FILM FROM THE RUBSTRIP. THOROUGHLY CLEAN THE RUBSTRIP UPON COMPLETION OF THE INSTALLATION.

RUBSTRIPS

LEXAN RUBSTRIPS

TOOLS & EQUIPMENT

SUPPLIED BY CONTRACTOR

STRAIGHT EDGE
CHALK LINE
TAPE MEASURE

SUPPLIED BY CONSTRUCTION SPECIALTIES

SPECIFIED FASTENERS (SEE TABLE BELOW)

CONDITION	SPECIFIED FASTENER	DRILL DIAMETERS	CS PART NUMBER
		WALL	
STEEL STUD/ GYPSUM WALL WOOD STUD/GYPSUM WALL CONCRETE/CONCRETE BLOCK	#8-15 X 1" PHILLIPS OVAL HEAD SHEET METAL SCREW	N/A	90H138002

WALL PREPARATION

ALL WALL SURFACES MUST BE CLEAN, SMOOTH AND DRY BEFORE INSTALLING LEXAN RUBSTRIPS.

INSTALLATION

1. PREPARE THE AREA OF THE WALL TO RECEIVE THE RUBSTRIP AS DESCRIBED ABOVE UNDER WALL PREPARATION.
2. ESTABLISH THE RUBSTRIP HEIGHT AS PER THE ARCHITECTURAL DRAWINGS, WHEN AVAILABLE. USING A PENCIL, MAKE A LEVEL LINE TO BE USED AS A GUIDE FOR ALIGNING THE RUBSTRIP TOP OR BOTTOM.
3. LEXAN RUBSTRIPS ARE SUPPLIED CUT-TO-SIZE. LAYOUT RUBSTRIPS FOR DRY FIT PRIOR TO INSTALLING.
4. STARTING AT ONE END OF THE RUN, BEGIN POSITIONING THE RUBSTRIP ON THE WALL, ALIGNING EITHER THE TOP OR BOTTOM WITH THE PENCIL LINE.

NOTE: MASKING TAP MAY BE UTILIZED AS A POSITIONING GUIDE DURING INSTALLATION OF THE RUBSTRIPS.

5. INSTALL RUBSTRIPS BY SECURING INTO POSITION USING THE SPECIFIED FASTENERS.
6. REMOVE MASKING TAPE IF USED.

05/15/20