

MODEL ASM/ASMC-100X THRU 400X INSTALLATION INSTRUCTIONS

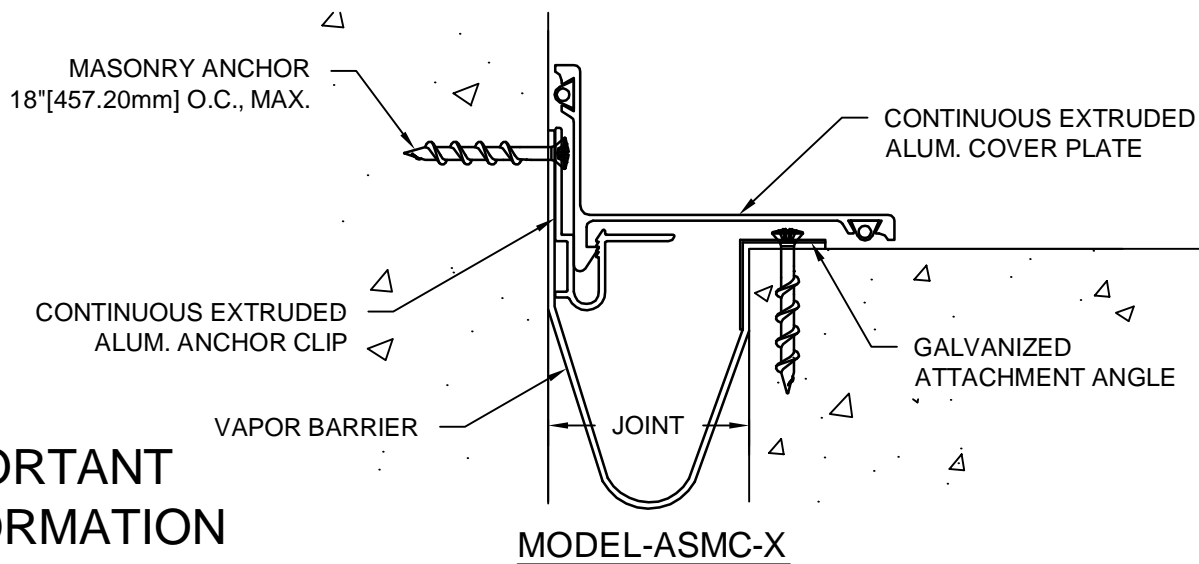
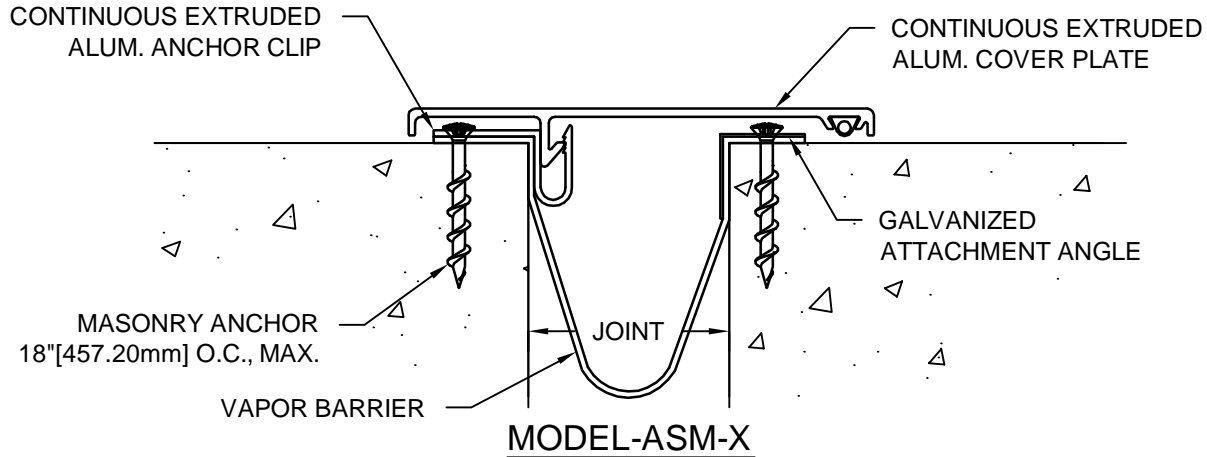

IMPORTANT INFORMATION

Prior to the commencement of installation, all materials **MUST** be inspected for damage. Any damage must be reported to CONSTRUCTION SPECIALTIES, INC., as soon as possible, so that replacement materials may be furnished without delay.

All work must be completed as per Architect's Approved "Shop Drawings", and in accordance with these Installation Instructions. When installation is complete, all materials must be protected from damage until the Architect's FINAL INSPECTION.

All materials should be arranged in the order that they are to be installed. All hardware required for each portion of the work should be placed with the appropriate materials.

Please review all Approved Shop Drawings and this document to familiarize yourself with all the details and components of this assembly.

IMPORTANT:
READ THROUGH ALL INSTRUCTIONS PRIOR TO STARTING INSTALLATION

5/6/11



Construction Specialties™

6696 Route 405 Highway, Muncy PA 17756
(800) 233-8493 .Fax (570) 546-5169 www.c-sgroup.com

This document is the property of Construction Specialties, Inc. and contains CONFIDENTIAL PROPRIETARY INFORMATION that is not to be disclosed to third parties and is not to be used without approval in writing from Construction Specialties, Inc.

Notes

Before beginning installation, review the architectural drawings and approved Construction Specialties Inc. shop drawings to familiarize yourself with the joint cover models and locations.

Check all of the joint cover components to confirm that the correct joint cover model and size have been received. Also, check for materials that may have been damaged during shipping. Report all incorrect and/or damaged components to C/S at 800-233-8493.

Read through all the steps of these instructions prior to beginning work.

Remove protective coating from all parts **before** installation.

STEP 1

ANCHOR CLIP INSTALLATION

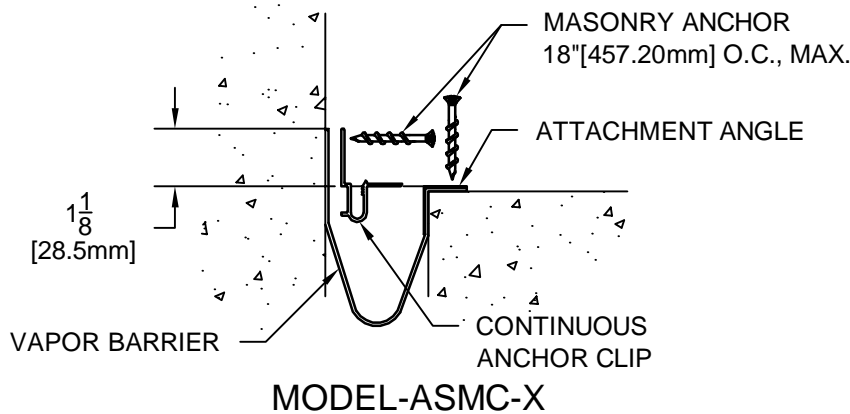
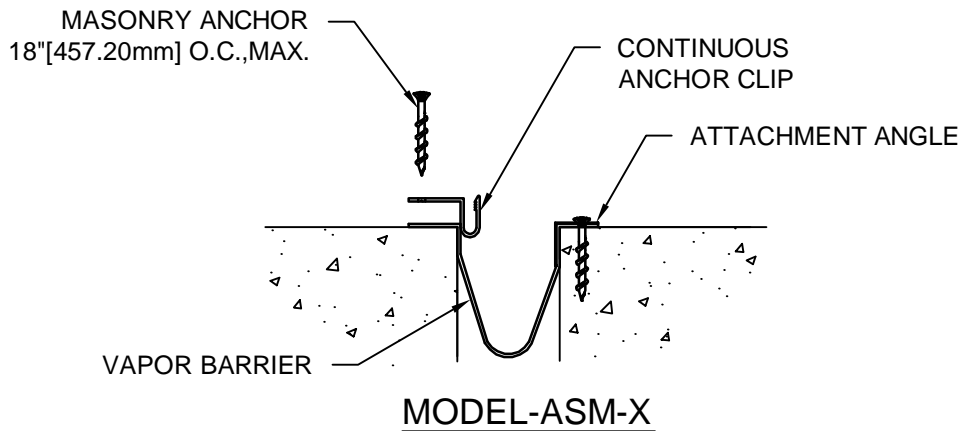

Note:

-If a C/S Fire Barrier is to be installed in the joint, please review the Fire Barrier Installation Instructions supplied, and if required install the Fire Barrier **BEFORE** installation of C/S Seismic Expansion Joint Continuous Anchor Clip.

-If a C/S Vapor Barrier is to be installed in the joint, please review the C/S Vapor Barrier Installation Instructions supplied, and if required install the Vapor Barrier **BEFORE** installation of the C/S Seismic Expansion Joint Anchor Clip.

Step 1:

- 1.1) Begin installation by locating Continuous Anchor Clips on wall.
 - For model ASM-X, the Clip is located on the edge of joint (see detail above).
 - For model ASMC-X, the top of the Clip is measured 1 1/8" (28.50mm) from the face of the wall (see detail above).
- 1.2) Using the Clip as a template, mark the locations of the fasteners. (Note: The "U" shaped portion of the Clip must be aligned vertically to properly receive the Cover Plate.)
- 1.3) Remove the Clip and, if necessary, drill the holes for the Anchors. The holes are to be drilled with the appropriate size and type of drill bit as indicated by the manufacturer of the C/S supplied Anchors.
- 1.4) Reposition the Clip and attach using appropriate C/S supplied Anchors.

STEP 2

COVER PLATE INSTALLATION

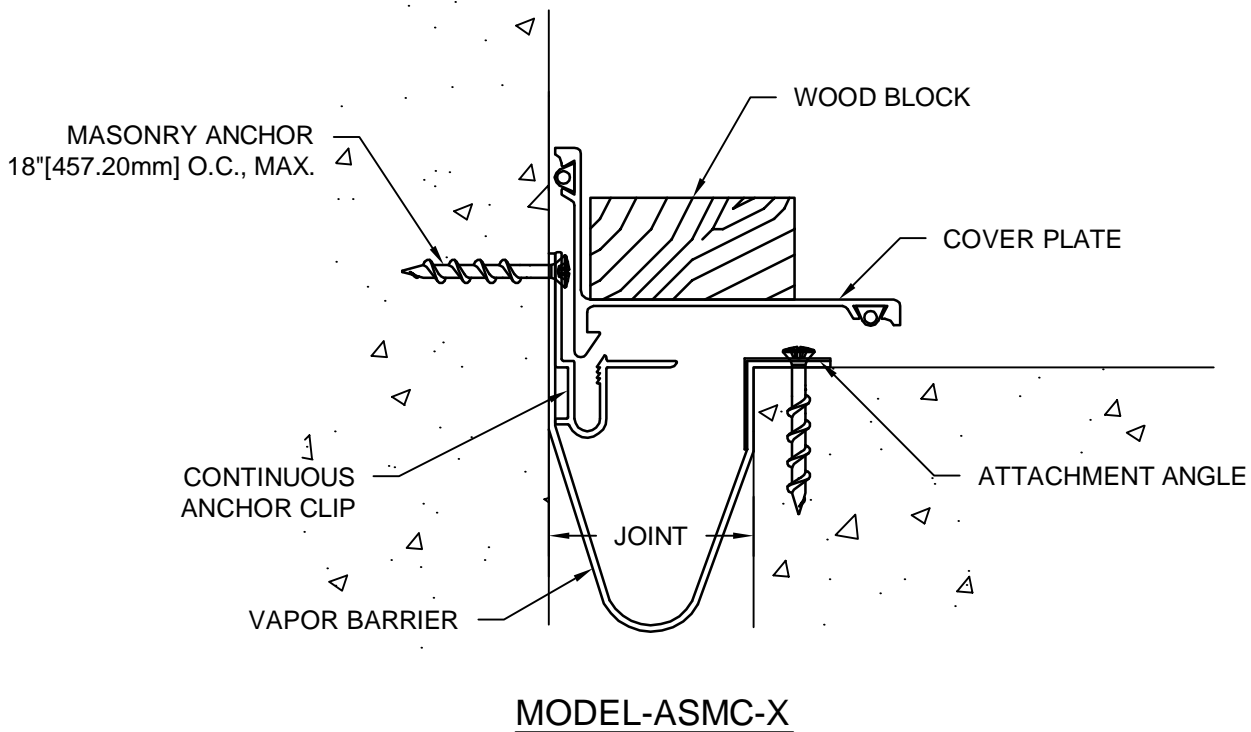
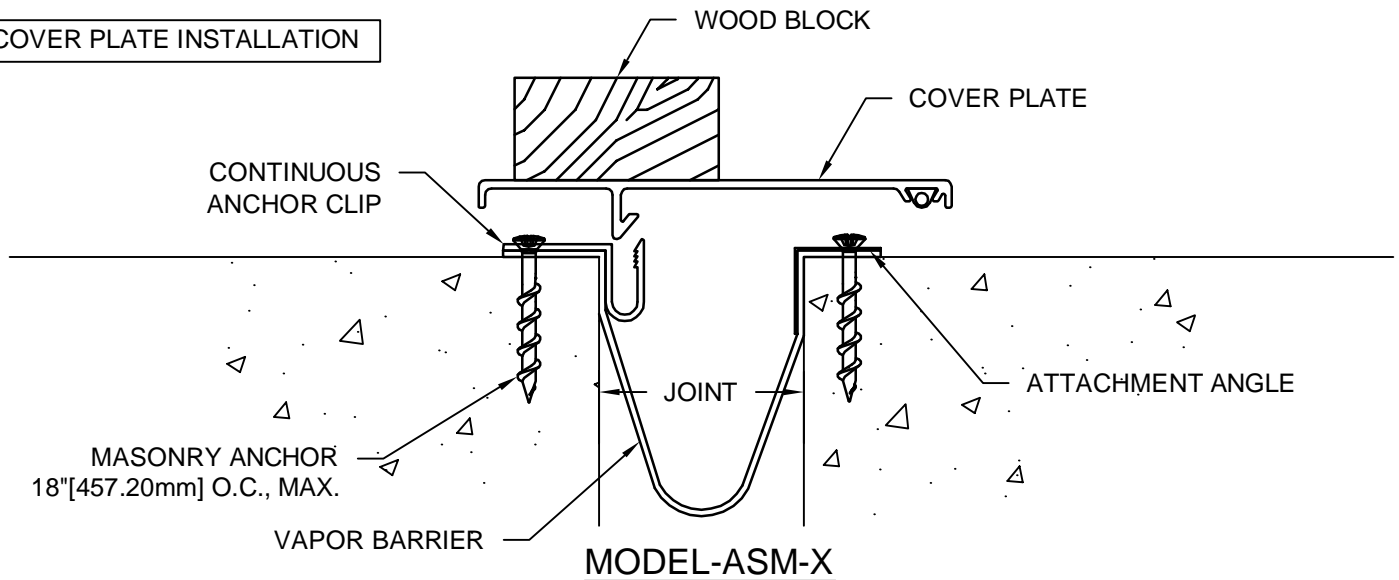

Note:

Before installation of the Cover Plate, measure the length/height of the run of cover and cut the Cover Plate to length as needed.

Step 2:

- 2.1) Begin installation of the Cover Plate to the Clip by aligning one end of a length of Cover Plate with the end of the installed Clip. Align the "J-Hook" on the underside of the Cover Plate with the locking channel of the Clip.
- 2.2) Place a wood block on top of the Cover Plate over the "J-Hook" area. While holding the Cover Plate square, use a rubber mallet to strike the wood block and drive the "J-Hook" into the locking channel. (Note: Do not hammer directly onto the Cover Plates as this may cause damage to the Cover Plate.)
- 2.3) Work down along the length of the Cover Plate driving the "J-Hook" approximately half of the way into the locking channel. Then return and drive the "J-Hook" the remainder of the way in until the Cover Plate is seated against the wall surface.
- 2.4) Repeat these procedures for any additional lengths of Cover Plate.

STEP 3

COMPLETE INSTALLATION

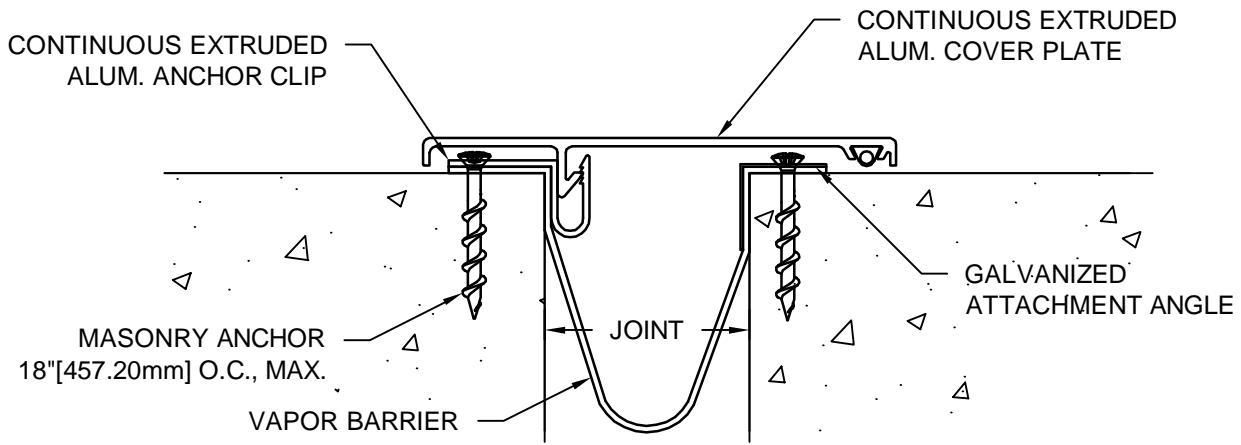

MODEL-ASM-X

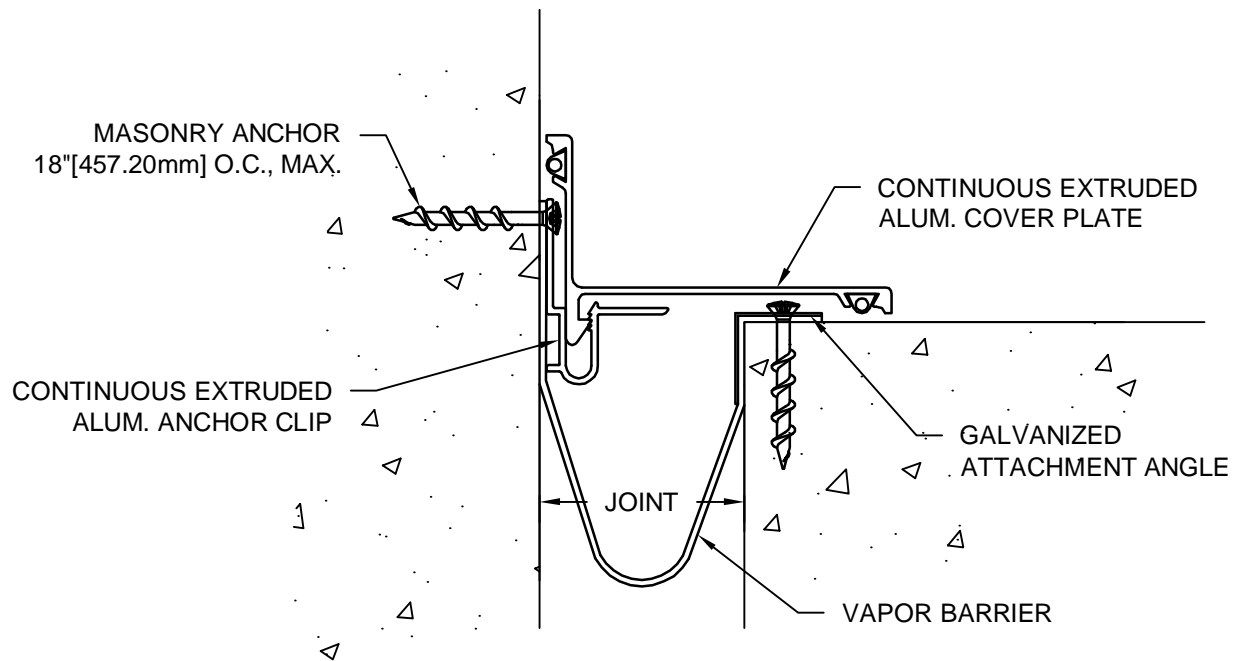

MODEL-ASMC-X

Step 3:

- 3.1) When installation of the C/S Exterior Wall Expansion Joint Cover has been completed, remove all residue and foreign matter from the area and joint cover.
- 3.2) Clean the C/S Joint Cover and adjoining surfaces with proper cleaner.
- 3.3) Protect the Joint Cover until the Architect's final inspection.