

## 2VFR Series

**TECHNICAL DATA:**

- 2VFR has been tested and certified under UL 2079. Both meet the requirements of ASTM E1966, ASTM E119 and ASTM E1399. UL 2079, like ASTM E1966, was developed to encompass the fire testing of ASTM E119 and movement cycling regime of ASTM E1399.
- Laminations: 2VFR has passed UL 2079 when configured with either vertical, compression-bonded laminations or with horizontal, adhesive-bonded laminations. The orientation or presence of laminations in any form is inconsequential to the performance of the product under the UL2079 testing criteria.

**FIRE RATED:**

- UL-2079 2 hour fire protection

**SOUND ATTENUATION:**

- 1½" 2VFR in an STC68 / OITC 51 wall are an STC value of 64 and an OITC value of 52.



MODEL	JOINT WIDTH	MINIMUM OPENING	MAXIMUM OPENING	EXPOSED SURFACE	BLOCKOUT WIDTH	BLOCKOUT HEIGHT	SEAL DEPTH
2VFR-100	1.00" (25mm)	0.50" (13mm)	1.50" (38mm)	1.00" (25mm)	N/A	N/A	4.00" (102mm)
2VFR-150	1.50" (38mm)	0.75" (19mm)	2.25" (57mm)	1.50" (38mm)	N/A	N/A	4.00" (102mm)
2VFR-200	2.00" (51mm)	1.00" (25mm)	3.00" (76mm)	2.00" (51mm)	N/A	N/A	4.00" (102mm)
2VFR-250	2.50" (64mm)	1.25" (32mm)	3.75" (95mm)	2.50" (64mm)	N/A	N/A	4.00" (102mm)
2VFR-300	3.00" (76mm)	1.50" (38mm)	4.50" (114mm)	3.00" (76mm)	N/A	N/A	4.00" (102mm)
2VFR-350	3.50" (89mm)	1.75" (44mm)	5.25" (133mm)	3.50" (89mm)	N/A	N/A	4.00" (102mm)
2VFR-400	4.00" (102mm)	2.00" (51mm)	6.00" (152mm)	4.00" (102mm)	N/A	N/A	4.00" (102mm)
2VFR-450	4.50" (114mm)	2.25" (57mm)	6.75" (171mm)	4.50" (114mm)	N/A	N/A	4.00" (102mm)
2VFR-500	5.00" (127mm)	2.50" (64mm)	7.50" (191mm)	5.00" (127mm)	N/A	N/A	4.00" (102mm)
2VFR-550	5.50" (140mm)	2.75" (70mm)	8.25" (210mm)	5.50" (140mm)	N/A	N/A	4.00" (102mm)
2VFR-600	6.00" (152mm)	3.00" (76mm)	9.00" (229mm)	6.00" (152mm)	N/A	N/A	4.00" (102mm)

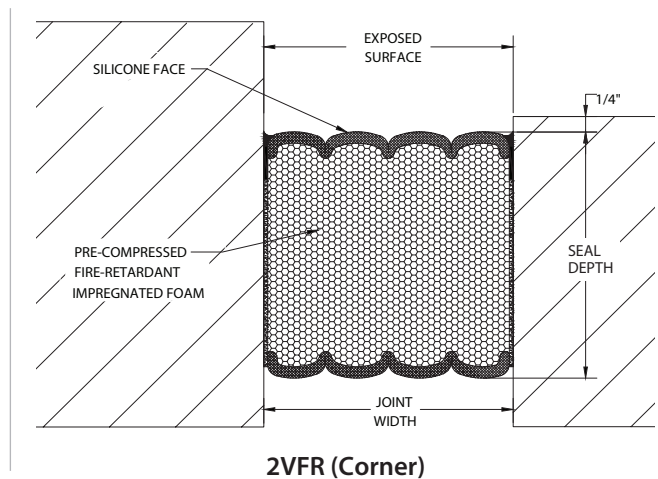
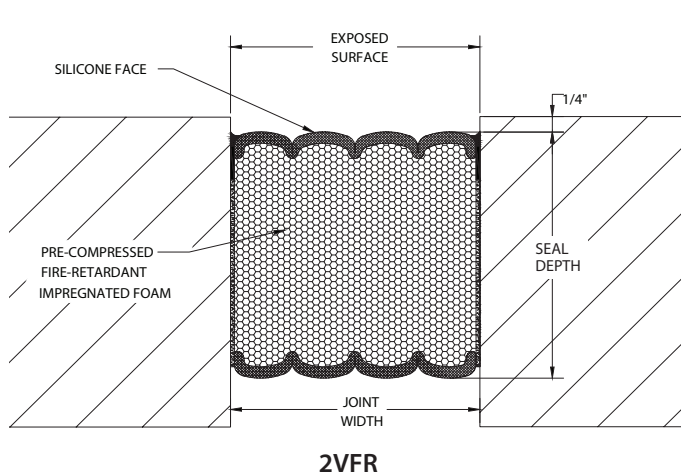

## 2VFR Series

RATING	NOMINAL JOINT SIZE	APPLICATION	COMPRESSION	EXTENSION	VFR LISTING NUMBER
2HR	½"-2"	Gypsum Wall	50%	50%	WW-D-0222
		Concrete Wall	50%	50%	WW-D-0221
		Floor to Concrete Wall	50%	50%	HW-D-0828
	2¼"-6"	Gypsum Wall	50%	50%	WW-D-1206
		Concrete Wall	50%	50%	WW-D-1205
		Floor to Concrete Wall	50%	50%	HW-D-1127
	2"-4"	Gypsum Wall	50%	50%	WW-D-1208
		Concrete Wall	50%	50%	WW-D-1209