

TFC CORNER GUARDS

PLEASE READ

PLEASE READ THESE INSTRUCTIONS THOROUGHLY PRIOR TO BEGINNING THE TFC CORNER GUARD INSTALLATION!

THIS INSTRUCTION SHEET IS INTENDED TO PROVIDE A SPECIFIC GUIDE TO FOLLOW FOR THE INSTALLATION OF THIS TFC CORNER GUARD. CONTAINED WITHIN IS THE TECHNICAL INFORMATION AND INSTALLATION TECHNIQUES REQUIRED TO COMPLETE AN EFFICIENT, NEAT AND LONG-LASTING INSTALLATION.

INSPECT ALL MATERIALS FOR DAMAGE OR MISSING PARTS. IF YOU DISCOVER DAMAGED OR MISSING MATERIALS, IN THE USA PLEASE NOTIFY THE FACTORY AT (800) 233-8493, AND IN CANADA (888) 895-8955 FOR CUSTOMER SERVICE.

TFC CORNER GUARD MUST BE INSTALLED IN ACCORDANCE WITH THESE INSTRUCTIONS! FAILURE TO FOLLOW THESE INSTRUCTIONS MAY VOID ANY PRODUCT WARRANTIES AND RESULT IN AN UNSUCCESSFUL INSTALLATION. FOR SPECIFIC QUESTIONS REGARDING THE INSTALLATION OF THIS TFC CORNER GUARD PLEASE CALL THE FACTORY IN THE USA AT (800) 233-8493 OR EMAIL IWPTECHSUPPORT@C-SGROUP.COM. IN CANADA CALL (888) 895-8955.

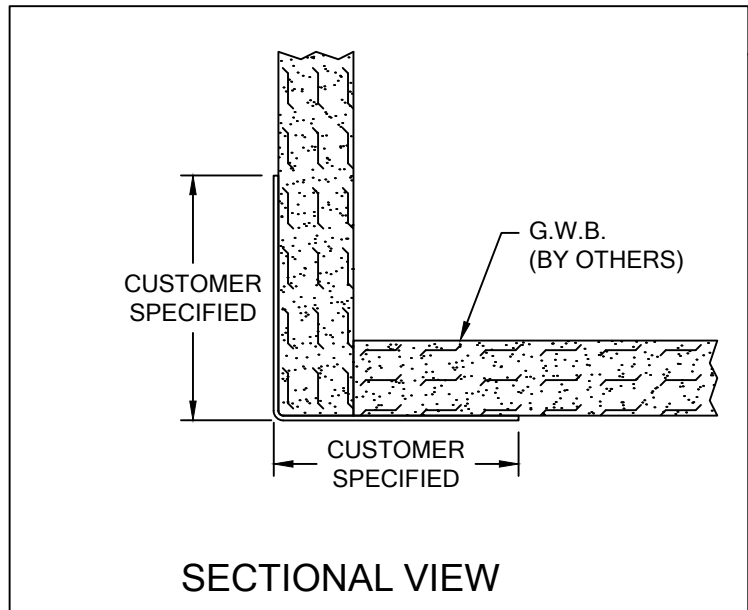

MODEL: TFC

IMPORTANT NOTES

1. ALL DIMENSIONS ARE TYPICAL.
2. MATERIAL MUST REACH 65°F MIN. TO 75°F MAX. 24 HOURS PRIOR TO INSTALLATION. THIS IS ESSENTIAL TO MINIMIZE EXPANSION AND CONTRACTION OF MATERIAL.
3. DO NOT EXPOSE CORNER GUARD TO ELEVATED TEMPERATURES OR DIRECT SUNLIGHT AFTER INSTALLATION. THIS WILL CAUSE THE SURFACE TEMPERATURE TO RISE, WHICH IN TURN WILL CAUSE BUBBLES AND DELAMINATION.
4. FOR MORE INFORMATION ON TFC CORNER GUARDS SEE OUR WEBSITE AT www.c-sgroup.com.

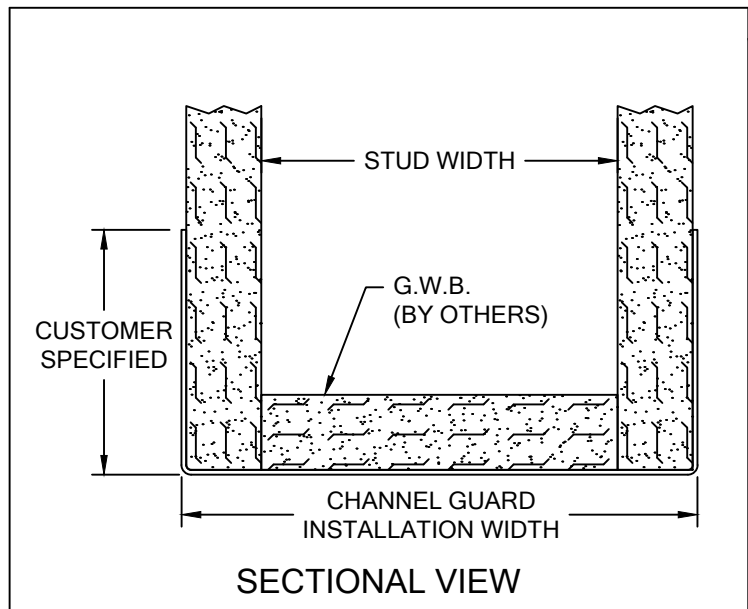

MODEL: TFCH

TFC CORNER GUARDS

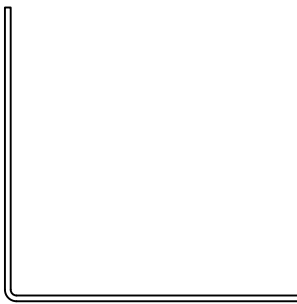

CORNER GUARD



CHANNEL GUARD

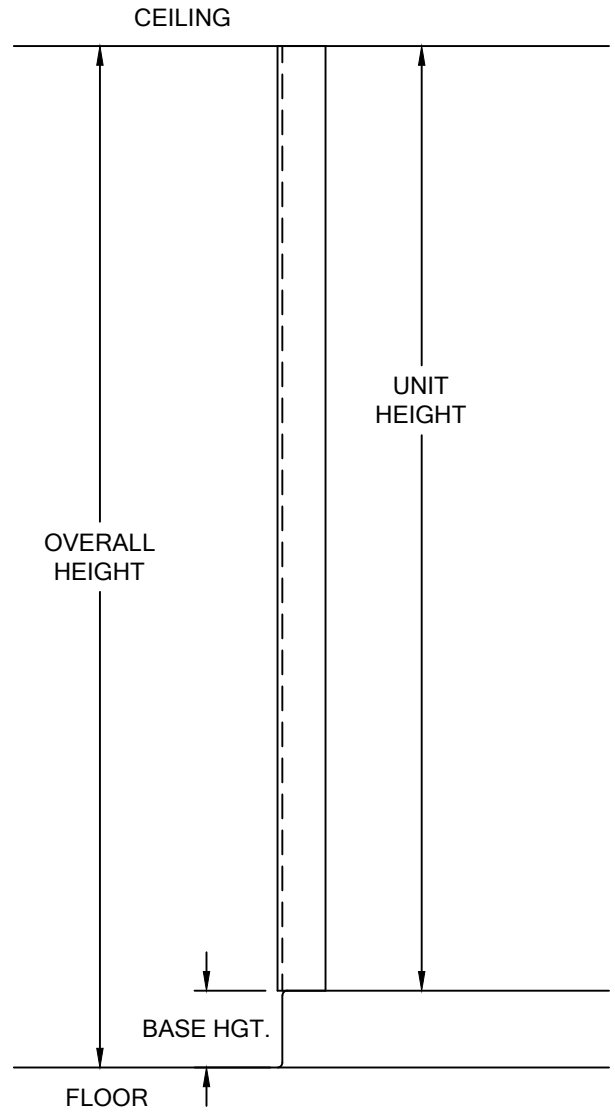

WALL CONDITION	SPECIFIED FASTENER	QUANTITY	CS PART NUMBER
STEEL STUD/GYPSUM WALL WOOD STUD/GYPSUM CONCRETE/CONCRETE BLOCK	ACROVYN INTERIORS HEAVY DUTY WATER BASED MASTIC ADHESIVE	1 GALLON 5 GALLON	90M108001 90M107001

TFC CORNER GUARDS

TYPICAL ASSEMBLY

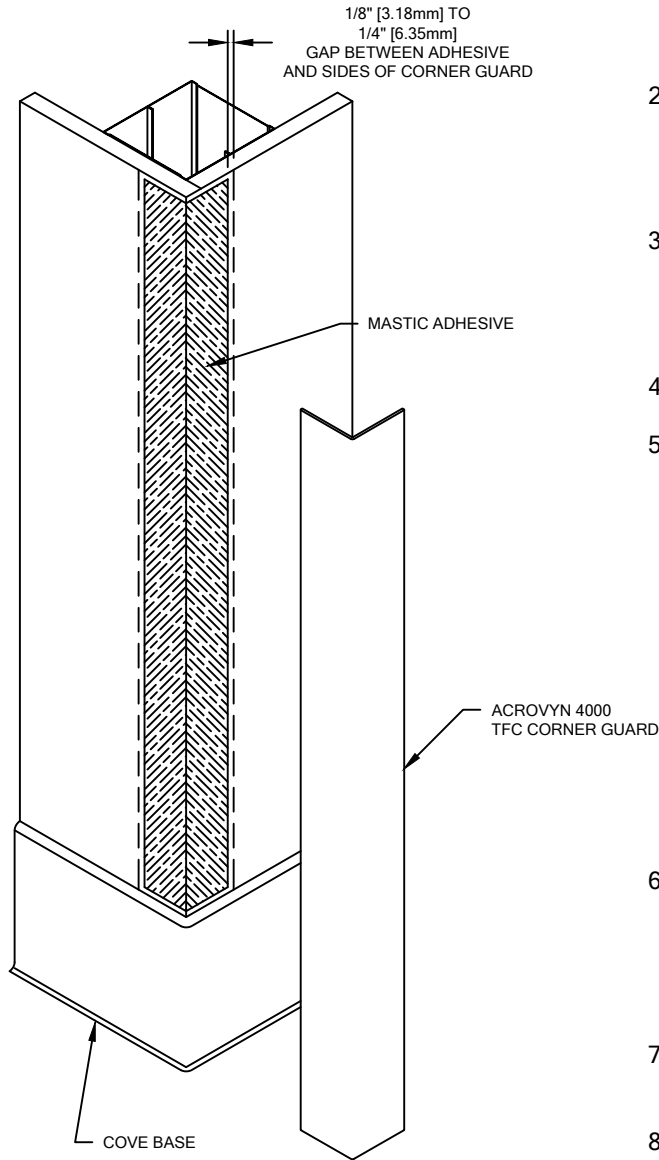

1. ALL WALL SURFACES MUST BE CLEAN, SMOOTH, DRY, AND FREE OF ANY LOOSE PAINT OR ANY OTHER IRREGULARITIES WHICH WOULD PREVENT GOOD ADHESION.
2. WHERE THE CORNER GUARD IS TO BE APPLIED OVER PAINTED SURFACES, THE SURFACE SHOULD BE LIGHTLY SANDED, THEN THOROUGHLY WIPED DOWN, (DUST FREE) TO IMPROVE ADHESIVE GRIP.
3. IN THE CASE OF BLOCK OR CERAMIC TILE, EXCESS MORTAR MUST BE REMOVED USING A MASONS STONE (OR OTHER ADHESIVE TOOL) PRIOR TO PROCEEDING WITH THE INSTALLATION.
4. ESTABLISH CORNER GUARD HEIGHT REQUIREMENT.
5. USE THE NOTCHED TROWEL TO APPLY WATER BASE MASTIC TO AN AREA OF THE WALL THAT CAN BE COMPLETED WITHIN THE CURE TIME OF THE ADHESIVE. MAKE SURE THE ENTIRE AREA RECEIVES AN EVEN COAT. DO NOT ALLOW THE ADHESIVE TO OVER CURE. WHEN APPLYING THE ADHESIVE, MAINTAIN A MINIMUM 1/8" TO A MAXIMUM 1/4" CLEARANCE AT THE TOP, BOTTOM, AND SIDES OF THE CORNER GUARD. UNDER IDEAL CONDITIONS, THE PROPER CURE TIME OF THE ADHESIVE SHOULD BE APPROXIMATELY 30 MINUTES. WHEN APPLIED, THE ADHESIVE IS WHITE AND CREAMY. AS IT CURES, THE ADHESIVE WILL BECOME TRANSLUCENT AND TACKY.
6. INSTALL THE CORNER GUARD BY ALIGNING THE BOTTOM OF THE CORNER GUARD WITH THE TOP OF THE COVE BASE OR FINISH FLOOR AND MOVING THE GUARD INTO POSITION ALONG THE APEX OF THE WALL SURFACE AND CORNER GUARD.
7. USING THE NO. 333 CRAIN ROLLER, ROLL THE CORNER GUARD YOU HAVE JUST INSTALLED.
8. THOROUGHLY CLEAN THE CORNER GUARD UPON COMPLETION OF THE INSTALLATION.